

Kings Gardens, NW6

£825,000

A very spacious first floor apartment located in this popular period mansion block on West End Lane. The property features a private south facing balcony and will be sold with a share of freehold and no onward chain.

Kings Gardens is positioned within walking distance of the amenities and transport links on West End Lane and Kilburn High Road. Shops, restaurants and cafés are in abundance.

Features

- Two Double Bedrooms
- First Floor
- Plenty Natural Light
- Communal Garden
- Private Balcony
- Lift & Porter

Kings Gardens, London, NW6

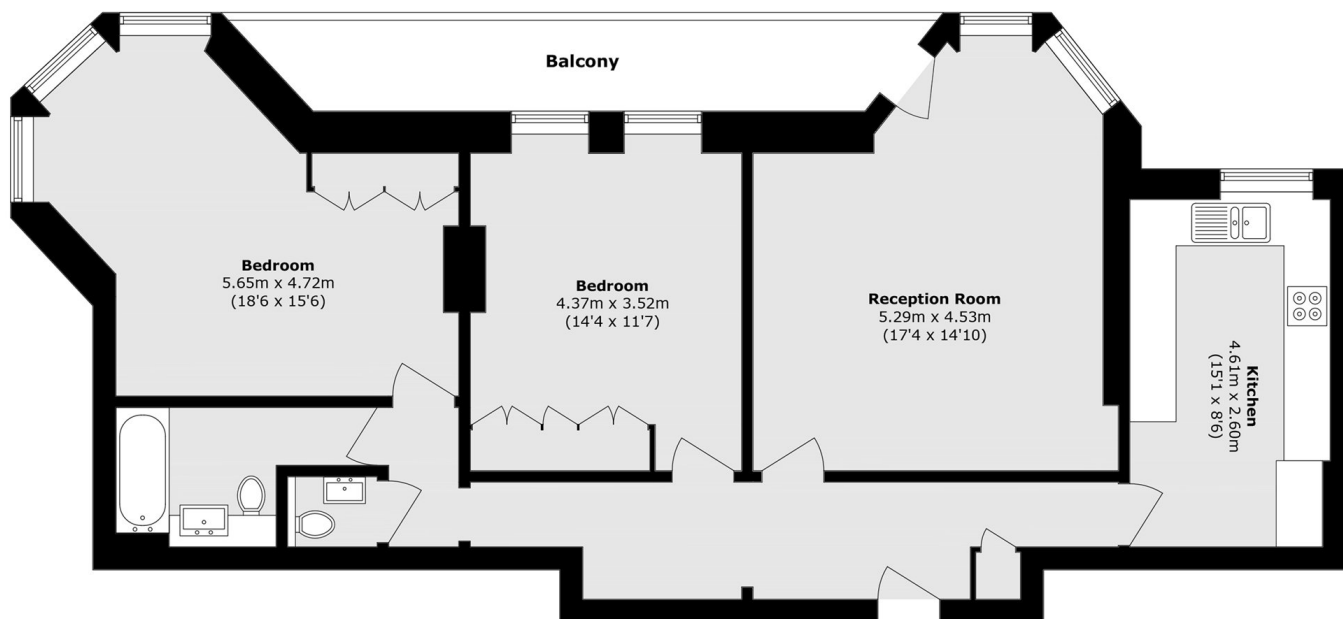

Total area (approx.): 93.5 sq. m (1006.4 sq. ft)

Balcony area (approx.): 6.6 sq. m (71.0 sq. ft)