



## Winsford Avenue

Allesley Park, Coventry, CV5 9HZ

### Offers over £210,000

\* Family home with great potential in a popular area \* This charming terraced house presents an excellent opportunity for families seeking a new home. With great potential, the property boasts two inviting reception rooms, perfect for both relaxation and entertaining guests. The kitchen leads onto the lean to area.

The house features three comfortable bedrooms, providing ample space for family members or guests. The bathroom is conveniently located, ensuring ease of access for all. One of the standout features of this property is the enclosed rear garden, which offers a private outdoor space for children to play or for adults to unwind. Additionally, a garage at the rear adds practicality, providing secure storage or parking options.

Situated in a fantastic location, this home is within close proximity to local schools and shops, making daily errands and family life more convenient. This property is not just a house; it is a potential family home where memories can be made. With its appealing features and prime location, this terraced house on Winsford Avenue is a must-see for those looking to settle in Coventry.

- Great potential with this family home
- Two reception rooms and kitchen
- Three Bedrooms and bathroom
- Enclosed rear garden
- Garage to the rear
- Offered with no chain

### Viewing

Please contact our Evans Estates Office on 02476333363 if you wish to arrange a viewing appointment for this property or require further information.



## Floor Plan

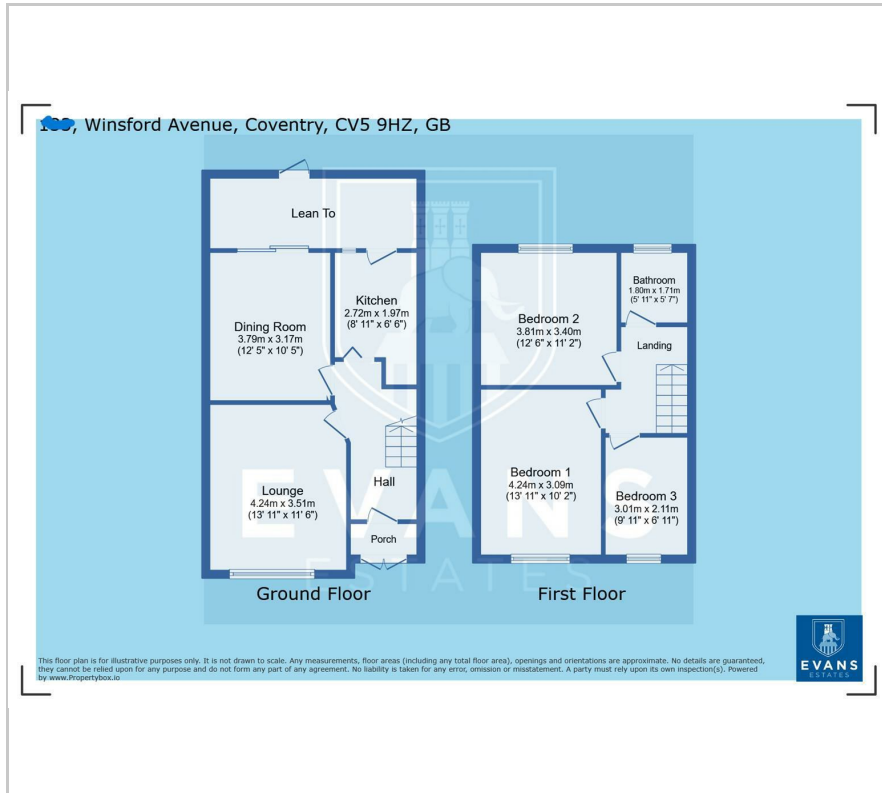

## Area Map



## Energy Efficiency Graph

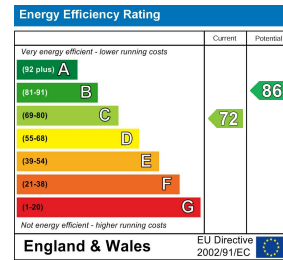

These particulars, whilst believed to be accurate are set out as a general outline only for guidance and do not constitute any part of an offer or contract. Intending purchasers should not rely on them as statements of representation of fact, but must satisfy themselves by inspection or otherwise as to their accuracy. No person in this firm's employment has the authority to make or give any representation or warranty in respect of the property.

47 Headington Avenue, Coventry, West Midlands, CV6 2GX  
 Tel: 02476333363 Email: [info@evans-estates.co.uk](mailto:info@evans-estates.co.uk) <https://www.evans-estates.co.uk>