



CHEVAL PLACE LONDON SW7
£1,600 PER WEEK AVAILABLE 08/04/2026

Hamptons

THE HOME EXPERTS

{ THE PARTICULARS

Cheval Place London SW7

£1,600 Per Week
Furnished

-  1 Bedroom
-  1 Bathroom
-  1 Reception

Features

- One Double Bedroom, - Air conditioning, - Underfloor Heating, - 24 Hour Concierge, - Council Tax Band F

Council Tax

Council Tax Band F

Hamptons
7 Lower Sloane Street
Sloane Square, London, SW1W 8AH
020 7824 8242
sloanesquarelettings@hamptons.co.uk
www.hamptons.co.uk

{ A ONE BEDROOM APARTMENT ON THE 2ND FLOOR IN PRIME KNIGHTSBRIDGE.

The Property

Tucked away on a quiet mews only moments away from shops, bars, restaurants and the world famous Hyde Park. This meticulously presented second floor apartment benefits from an open plan fully equipped kitchen/ living/ dining room. There is also a great size double bedroom with a built in wardrobes and modern bathroom suite. The apartment further benefits from air conditioning, underfloor heating, wifi and 24 hour concierge service.

Location

Cheval Place is ideally located for the luxury shopping on The Brompton Road to include Harrods, Knightsbridge underground station is located less than half a mile away offering the Piccadilly line for easy travel to central London and or Heathrow.



CHEVAL KNIGHTSBRIDGE

Approximate Gross Internal Area

510.42 sq. ft. (47.42 sq. m.)

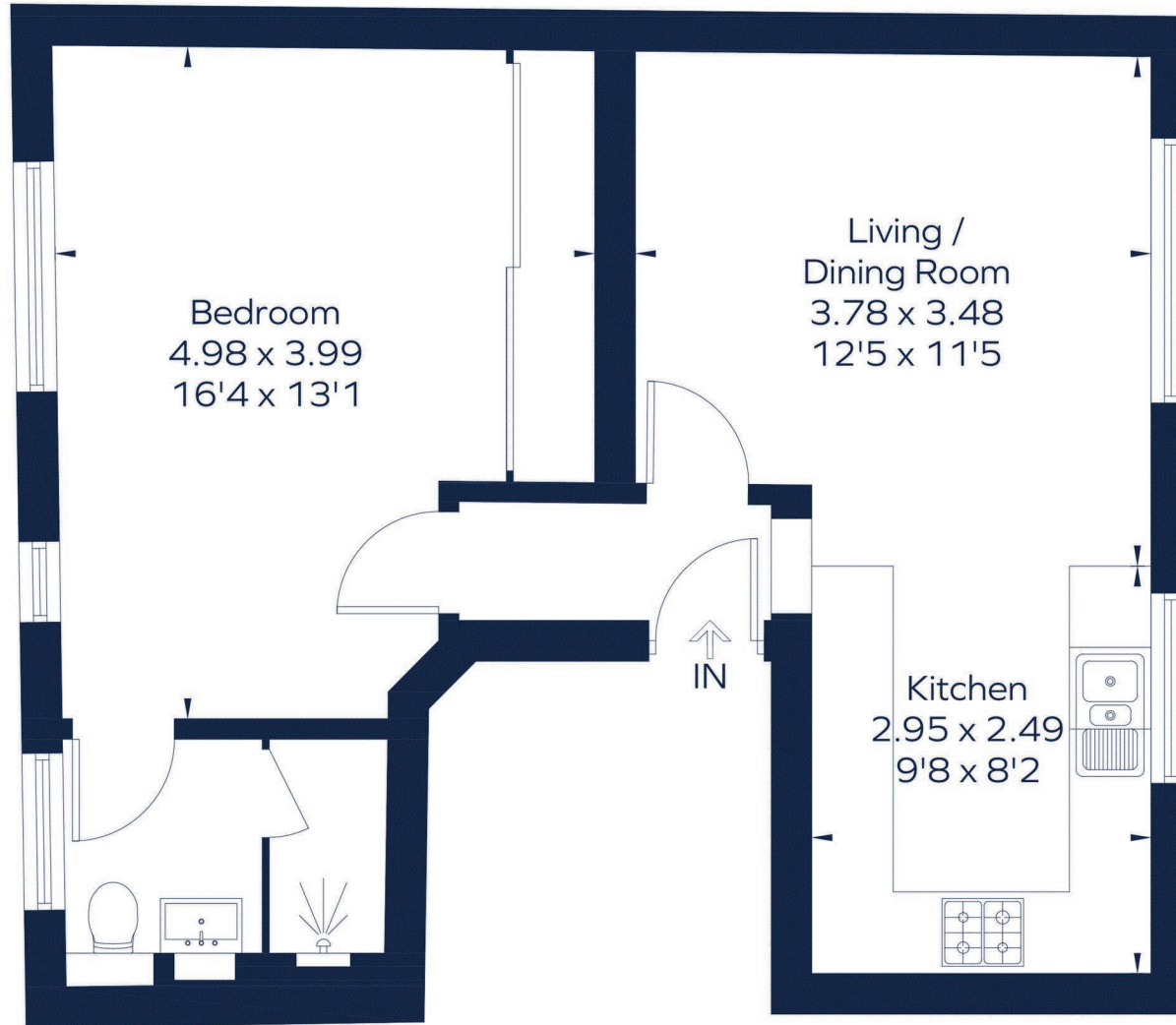

This plan is for layout guidance only. Not drawn to scale unless stated. Windows and door openings are approximate. Whilst every care is taken in the preparation of this plan, please check all dimensions, shapes and compass bearings before making any decisions reliant upon them. ID 870749

For Clarification

We wish to inform prospective tenants that we have prepared these particulars as a general guide and they have been confirmed as accurate by the landlord. We have not verified permissions, nor carried out a survey, tested the services, appliances and specific fittings. Room sizes are approximate and measurement figures rounded: they are taken between internal wall surfaces and therefore include cupboards/shelves, etc. Accordingly, they should not be relied upon for

carpets and furnishings. It should also be noted that all fixtures and fittings, carpeted, curtains/blinds, kitchen equipment and garden statuary, whether fitted or not, are deemed removable by the landlord unless specifically itemised with these particulars. Please enquire in office or on our website for details on holding deposit and tenancy deposit figures.

Energy Efficiency Rating		Current	Potential
Most energy efficient (low energy costs)	A		
Very good	B		
Good	C		
Fair	D	71	80
Below average	E		
Low energy efficiency (high energy costs)	F		
Least energy efficient (very high energy costs)	G		

England & Wales EU Directive applicable

