



Murray Road, Ottershaw, KT16

Guide Price £450,000

3 1 1



Nestled within a peaceful and attractive mews-style development in the heart of Ottershaw Village, this charming three-bedroom end-of-terrace home offers bright and well-proportioned accommodation. Arranged over two floors, the property features a spacious dual-aspect living room, a separate fitted kitchen, three comfortable bedrooms, a family bathroom, and useful storage throughout. Further benefits include allocated parking, adding everyday convenience to this appealing home. Ideal for families, first-time buyers, or those looking to downsize, the property combines practical living with a desirable village setting.



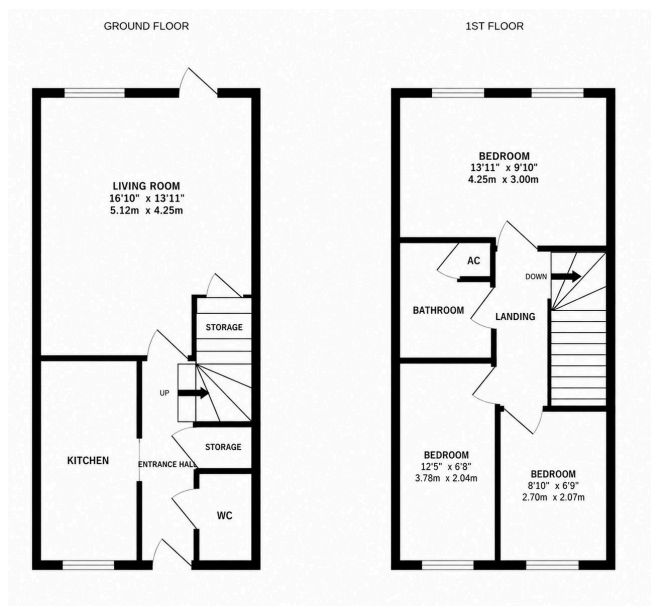

- Three-bedroom end-of-terrace home
- Peaceful mews-style development
- Situated in the heart of Ottershaw Village
- Spacious dual-aspect living room
- Separate fitted kitchen
- Family bathroom plus downstairs WC
- Useful built-in storage throughout
- Allocated parking space
- Ideal for families, first-time buyers, or downsizers

