

abbotFox



Brampton Court, Norwich  
*£2,250 Per Month*

“

We are a team of genuine individuals who hold a deep passion for both property and marketing. Collectively, we bring over 70 years of experience in the property market of Norfolk and Suffolk. Our affection for both counties runs deep, and we are enthusiastic about sharing our passion with you.

Colin McKenzie | **Branch Partner**







## THE DETAIL \_\_\_\_\_

abbotFox presents this perfectly positioned within the popular Brampton Court development, this spacious four-bedroom townhouse offers modern accommodation arranged over three well-designed floors. Ideal for professional sharers, the property combines generous living space with the privacy of multiple en suite bedrooms.

The heart of the home is the contemporary kitchen diner, providing ample space for cooking, dining and entertaining, with doors opening onto the communal garden to create a bright and sociable environment. A ground floor double bedroom and separate shower room offer flexibility, while the upper floors provide three further generously proportioned double bedrooms, each benefitting from its own en suite shower room. A dedicated utility room adds further practicality to everyday living.

Externally, the property enjoys access to a communal garden shared with just one neighbouring home, together with off-road parking.

Situated in the sought-after NR5 area, Brampton Court is perfectly placed for easy access to the University of East Anglia, the Norfolk and Norwich University Hospital, and a wide range of local amenities including Aldi, Asda and regular public transport links. Excellent road connections via the A47 make commuting straightforward, while nearby green spaces provide the perfect escape from city life.

Available immediately.







## THE HIGHLIGHTS \_\_\_\_\_

- Four Bedroom
- Four Ensuite
- Perfect for Sharers/Students
- Company Lets Welcome
- Available Now
- Close to UEA
- Close to NNUH

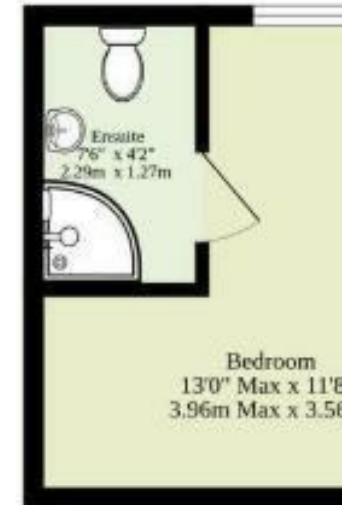
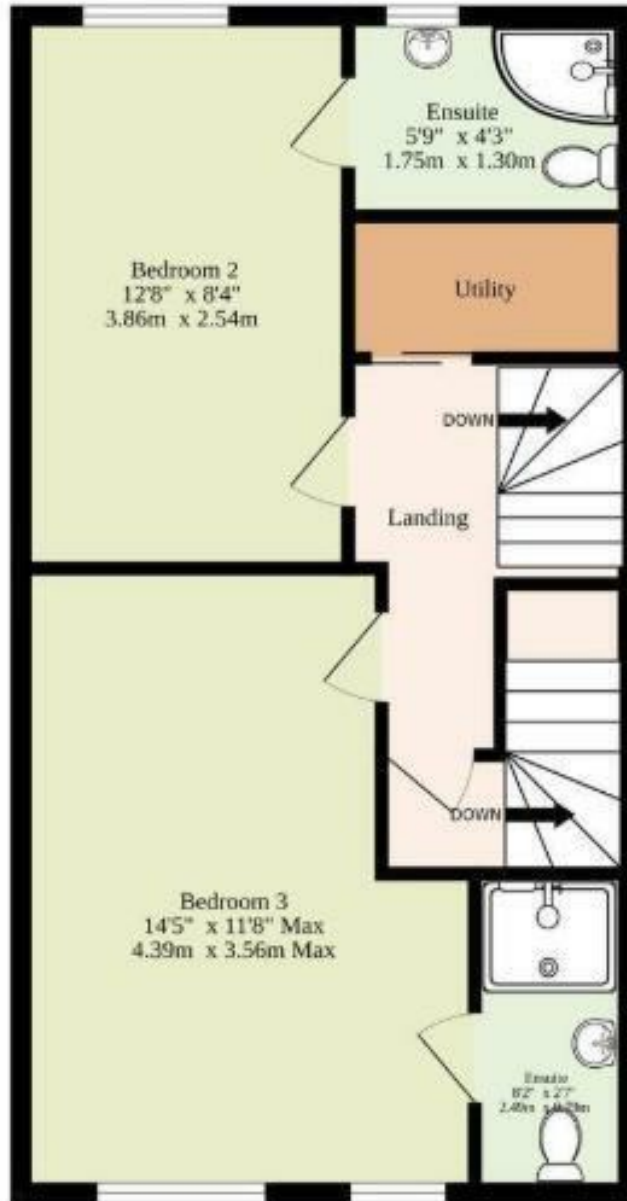
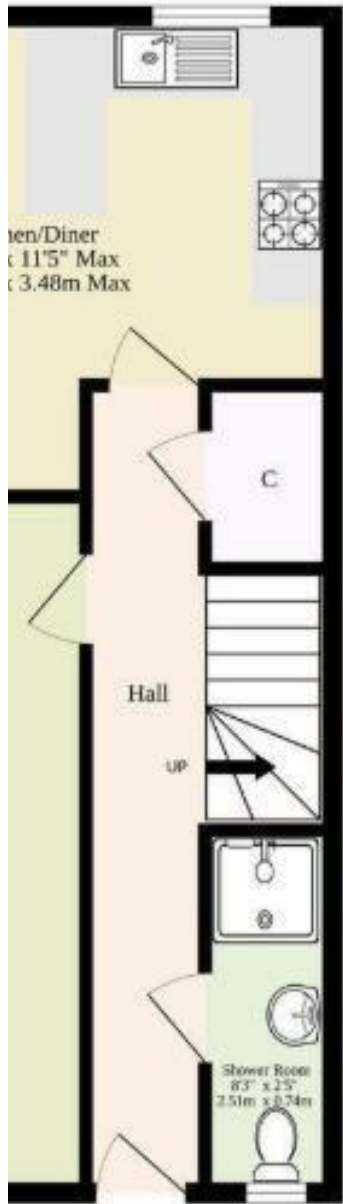

Let's talk

01603 660000

sales@abbotfox.co.uk

@abbotfox

EPC RATING -

Disclaimer – In accordance with the Property Misdescriptions Act, the company abbotFox gives notice that all descriptions, references to condition, necessary permissions for use and other details are given in good faith and believed to be correct, but any purchaser should not rely on them as statements of fact, and must satisfy themselves by inspection or other means, as to their accuracy.