



Connells

Chappell Close
Aylesbury



Property Description

Stylish Three-Bedroom Townhouse Across Three Impressive Floors.

This beautifully presented mid-terraced townhouse offers the perfect blend of modern convenience and family-friendly living, spread spaciouly across three well-designed floors.

Step inside to find an inviting entrance hall with soft carpet underfoot and a handy downstairs cloakroom. The lounge provides a cosy retreat for relaxing evenings, while the contemporary kitchen/diner is a real showstopper—bright and airy thanks to French doors that lead out to the enclosed rear garden. The kitchen comes fully integrated with a fridge, washing machine, dishwasher, electric oven, and gas hob, plus a bespoke pantry cupboard for all your storage needs.

On the first floor, you'll find two generous double bedrooms, a family bathroom complete with bath and overhead shower, and a convenient storage cupboard. Underfloor heating adds an extra touch of comfort.

The entire top floor is dedicated to the

stunning master suite, boasting a separate dressing room, a private en-suite bathroom with underfloor heating, and access to a fully boarded loft—ideal for extra storage or future potential.

Outside, the south facing garden is fully enclosed and features a patio area with lawn underfoot—perfect for entertaining or unwinding in peace. Completing the package are two allocated parking spaces for your convenience.

Entrance Hall

Door to front, carpet underfoot

Cloakroom

WC, WHB, radiator

Lounge

13' 6" x 11' 8" (4.11m x 3.56m)

Window to front, carpet underfoot, radiator

Kitchen

15' 1" x 13' 9" (4.60m x 4.19m)

French doors to rear, window to rear, vinyl underfoot, integrated dishwasher, washing machine, fridge/freezer. electric oven and gas hob. pantry with bespoke storage

Landing

Carpet underfoot, airing cupboard with dryer fitted

Bedroom One

15' 1" x 12' 4" (4.60m x 3.76m)

Window to front, skylight to rear, carpet underfoot, two radiators, dressing area

Dressing Room (bedroom One)

11' 5" x 6' 7" (3.48m x 2.01m)

Window to rear, carpet underfoot

En-Suite

Skylight, tiling underfoot, underfloor heating, part tiled, shower cubicle, wc, whb

Bedroom Two

15' 1" x 10' 1" (4.60m x 3.07m)

Two windows to rear, carpet underfoot, radiator

Bedroom Three

15' 1" x 9' 2" (4.60m x 2.79m)

Window to front, carpet underfoot, radiator

Bathroom

WC, WHB, bath/mixer with shower, part tiling, radiator, tiling underfoot, underfloor heating

Loft Space

Loft in master bedroom, fully boarded with loft ladder

Rear Garden

Patio, laid lawn and rear access

Pakring

two allocated spaces







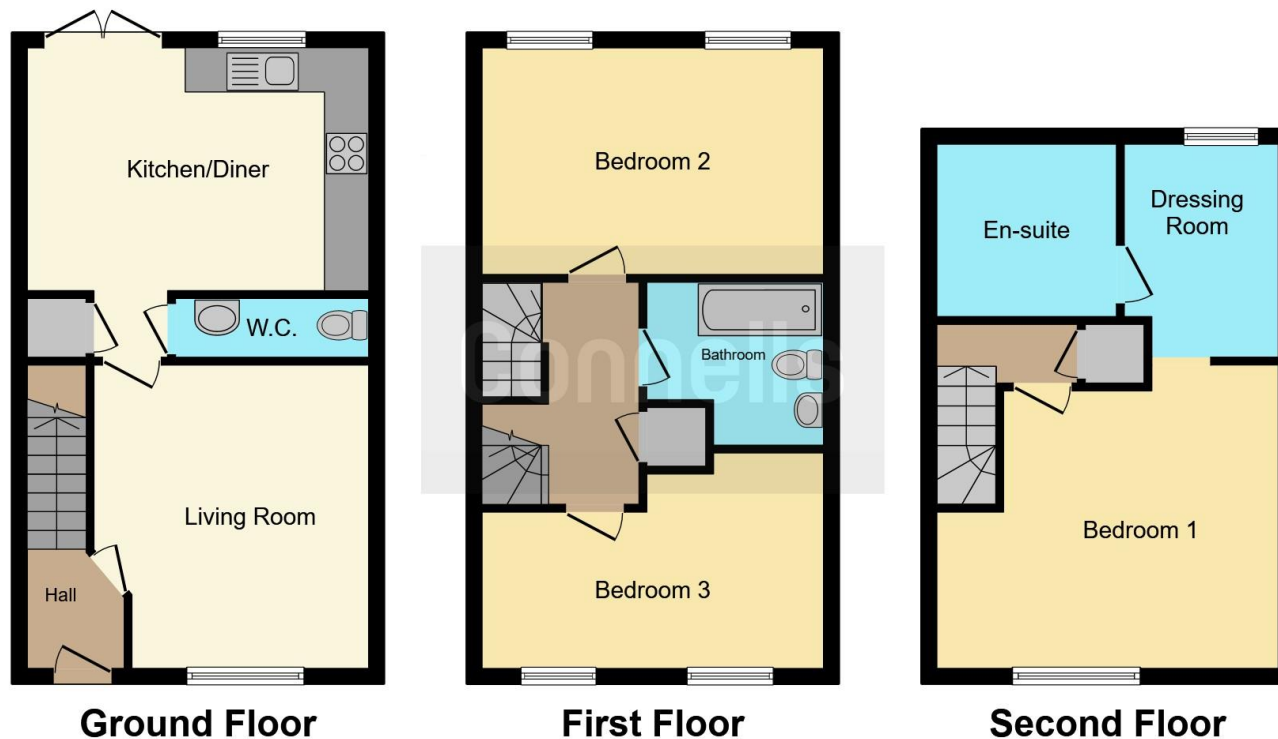

This floor plan is for illustrative purposes only. It is not drawn to scale. Any measurements, floor areas (including any total floor area), openings and orientation are approximate. No details are guaranteed, they cannot be relied upon for any purpose and they do not form part of any agreement. No liability is taken for any error, omission or misstatement. A party must rely upon its own inspection(s). Powered by www.focalagent.com

To view this property please contact Connells on

T 01296 395 111
E aylesbury@connells.co.uk

2 Temple Street
 AYLESBURY HP20 2RH

EPC Rating: B Council Tax
 Band: D

Tenure: Freehold

view this property online connells.co.uk/Property/ALS312206



1. MONEY LAUNDERING REGULATIONS Intending purchasers will be asked to produce identification documentation at a later stage and we would ask for your co-operation in order that there will be no delay in agreeing the sale. 2. These particulars do not constitute part or all of an offer or contract. 3. The measurements indicated are supplied for guidance only and as such must be considered incorrect. Potential buyers are advised to recheck measurements before committing to any expense. 4. We have not tested any apparatus, equipment, fixtures, fittings or services and it is in the buyers interest to check the working condition of any appliances.

Connells Residential is registered in England and Wales under company number 1489613, Registered Office is Cumbria House, 16-20 Hockliffe Street, Leighton Buzzard, Bedfordshire, LU7 1GN. VAT Registration Number is 500 2481 05.

See all our properties at www.connells.co.uk | www.rightmove.co.uk | www.zoopla.co.uk

Property Ref: ALS312206 - 0004