



## 128 Mapledene Road, Hackney, E8 3LL

£1,300,000

- Four spacious bedrooms
- Cosy reception room
- Located on Mapledene Road
- Close to local amenities
- Ideal family home
- Two bathrooms
- Mid-terrace house
- 1,337sqft of living space
- Easy access to transport
- Viewing recommended

# 128 Mapledene Road, Hackney E8 3LL

Welcome to this charming mid-terrace house located on the desirable Mapledene Road in the vibrant E8 area. This spacious property boasts an impressive 1,337 square feet of living space, making it an ideal family home or a perfect setting for those who enjoy entertaining.

The house features a well-proportioned reception room that provides a warm and inviting atmosphere, perfect for relaxing or hosting guests. With four generously sized bedrooms, there is ample space for family members or guests, ensuring everyone has their own comfortable retreat. The two bathrooms offer convenience and privacy, catering to the needs of a busy household.

The property is situated in a lively neighbourhood, known for its excellent local amenities, including shops, cafes, and parks, all within easy reach. The area is well-connected by public transport, making it simple to access the wider city and beyond.

This home presents a wonderful opportunity for those seeking a blend of space, comfort, and a vibrant community. With its appealing layout and prime location, this property is sure to attract interest from a variety of buyers. Do not miss the chance to make this delightful house your new home.



Council Tax Band: D





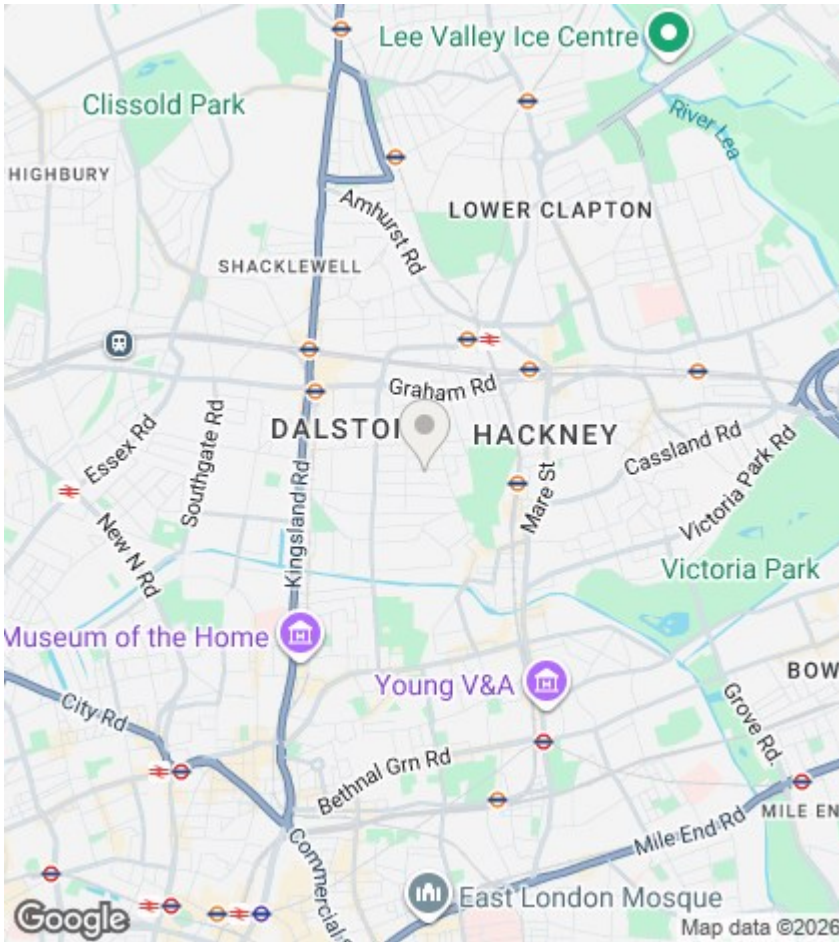

Directions

Viewings

Viewings by arrangement only. Call 020 7254 7554 to make an appointment.

EPC Rating:

D

Energy Efficiency Rating		Current	Potential
Very energy efficient - lower running costs			
(92 plus) A			
(81-91) B			83
(69-80) C			
(55-68) D		59	
(39-54) E			
(21-38) F			
(1-20) G			
Not energy efficient - higher running costs			
England & Wales		EU Directive 2002/91/EC	

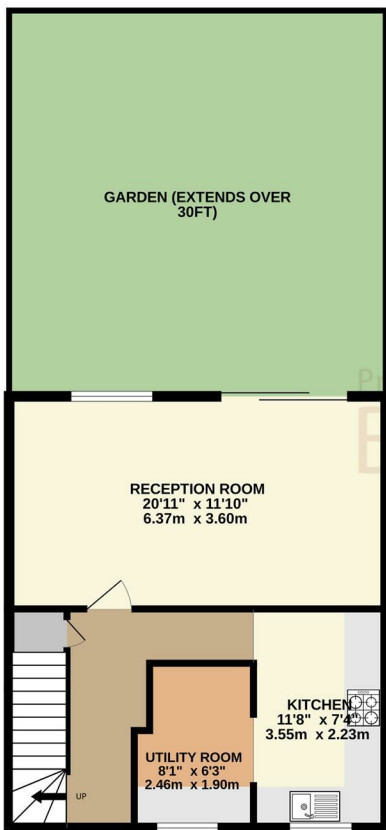

1ST FLOOR  
502 sq.ft. (46.6 sq.m.) approx.

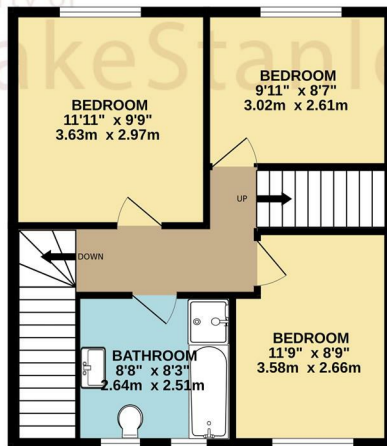

2ND FLOOR  
333 sq.ft. (30.9 sq.m.) approx.

