



*At home in Alresford*

# 19 Valdean Home Park

ALRESFORD, HAMPSHIRE, SO24 9AY

## Asking Rent £ 1,000 PCM

- Energy Performance Rating: Exempt
- Holding Deposit £230.76
- Deposit £1,153.90
- Council Tax Band A
- Over 55 Years of Age Only
- Two Bedrooms
- Sitting Room
- Kitchen
- Bathroom
- Off Road Parking
- Garden



Available only for those over 55 years of age, a two bedroom park home located on a very pleasant and popular site just a few minutes' walk from the shops and facilities in the centre of Alresford.





The accommodation comprises of a sitting room with triple aspect double glazed windows, kitchen with wall and base units, inset sink unit, and worktops. There is a double bedroom, a single bedroom and a bathroom., with shower over the bath. There is gas radiator central heating.

There is a small garden to the side and a paved area with shed to the rear. There is an offroad parking space to the side.

Regrettably no pets are allowed on site.

Alresford is a beautiful Georgian town known for its variety of independent shops, restaurants and inns located in stunning surroundings on the edge of the South Downs National Park. Attractions include the Watercress steam railway, schools for infant, junior and secondary education, several churches and an active and inclusive community. The cathedral city of Winchester is about 7 miles away and there is easy access to the south coast, the midlands and London via the road network. There is also mainline rail access to London from both Winchester and Alton. Southampton airport is only about half an hour away by car.



### DIRECTIONS

From the centre of Alresford head down West Street (in the direction of Winchester). Turn right into The Dean. Valdean Park will be found a little way along on the right hand side. We recommend parking on The Dean. Go into Valdean Park, walk straight ahead up to the top of the park then bear left where No.19 will be found on the left hand side.

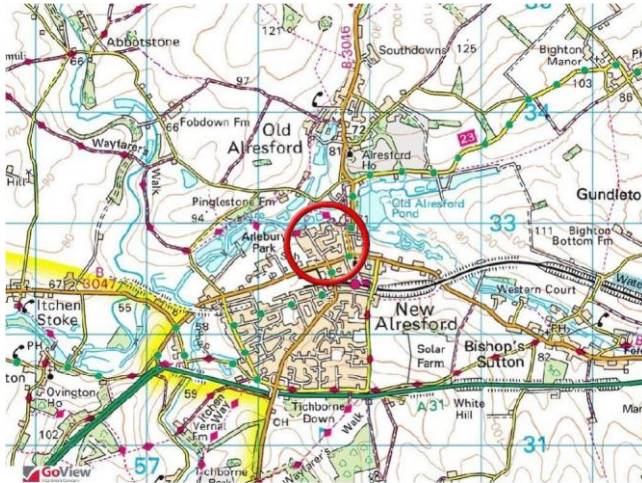
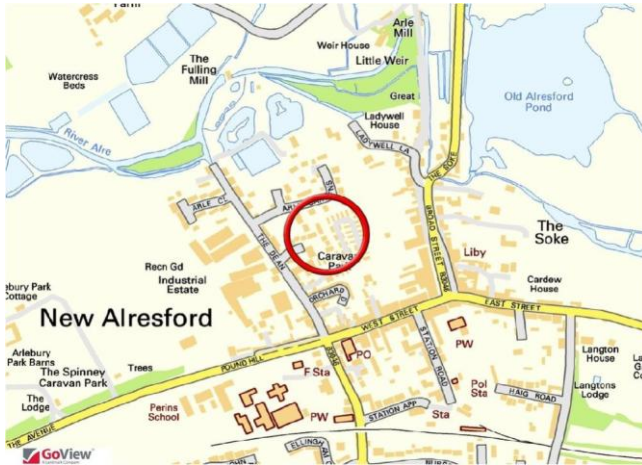

Approx Gross Internal Area  
41 sq m / 438 sq ft

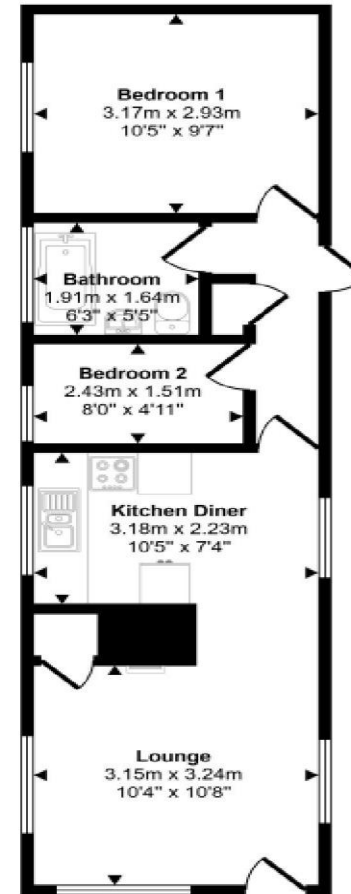

Floorplan

EPC Report not required as it's a listed building.

This floorplan is only for illustrative purposes and is not to scale. Measurements of rooms, doors, windows, and any items are approximate and no responsibility is taken for any error, omission or mis-statement. Icons of items such as bathroom suites are representations only and may not look like the real items. Made with Made Snappy 360.

No. 11 Broad Street, Alresford, Hampshire, SO24 9AR

01962 736333

lettings@hellards.co.uk | hellards.co.uk

IMPORTANT: we would like to inform prospective purchasers that these sales particulars have been prepared as a general guide only. A detailed survey has not been carried out, nor the services, appliances and fittings tested. Room sizes should not be relied upon for furnishing purposes and are approximate. If floor plans are included, they are for guidance only and illustration purposes only and may not be to scale. If there are any important matters likely to affect your decision to buy, please contact us before viewing the property.

