



LB

Loporto Browne

— RESIDENTIAL —

Clifton Mansions, NW2

Guide Price £650,000

🛏 2 🚿 2 🚗 1



- Guide Price - £675,000
- Modern family bathroom.
- Well-appointed kitchen with excellent storage and preparation space.
- Excellent transport links via Willesden Green Station and the Jubilee line.
- Close to local amenities, Gladstone Park, and highly regarded school.
- Two double bedrooms, including a principal with en-suite.
- Secure underground parking for convenience and peace of mind
- Generous reception room suitable for everyday living and entertaining.
- Practical, low-maintenance layout designed for modern living.



Guide Price - £650,000

This bright, well-balanced apartment offers a calm, contemporary feel throughout. A generous reception room provides space for everyday living and entertaining, complemented by a well-appointed kitchen with excellent storage. Two double bedrooms include a principal with en-suite, alongside a modern family bathroom. A private patio extends the living space, ideal for morning coffee or quiet relaxation.

Practical and low-maintenance, the home also benefits from secure underground parking. Clifton Mansions is conveniently located near local amenities, with Willesden Green Station providing quick access to central London. Gladstone Park, with tennis courts, playgrounds, and a café, is close by, and the area offers excellent schools including Convent of Jesus and Mary RC, Gladstone Park Primary School.

Oli & Liana are de

o market.

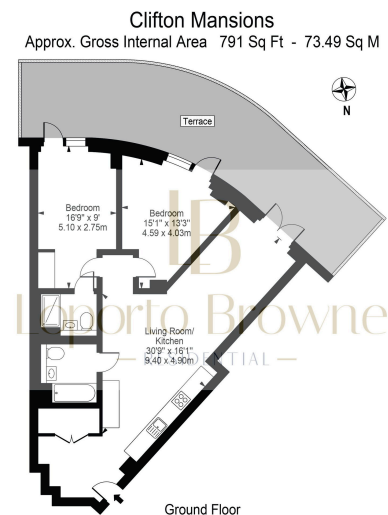

For Illustration Purposes Only - Not To Scale
This floor plan should be used as a general guide for guidance only and does not constitute an offer or contract. Any intending purchaser or lessee should satisfy themselves by inspection, valuations, enquiries and full survey as to the correctness of each statement. Any errors, measurements or dimensions quoted are approximate and should not be used to value a property or be the basis of any sale or let.

