

House - Mid Terrace

36  
ASHBURNHAM  
ROAD,  
BELVEDERE,  
DA17 6DA

Per Month

£2,000

FEATURES

- Available now
- Newly decorated throughout
- Spacious family accommodation
- Newly fitted carpets to living room, staircase and landing
- Three very good-sized bedrooms
- Private rear garden



# 3 Bedroom House – Mid Terrace located in Belvedere

3 Bedroom Family Home To Let – Ashburnham Road, Belvedere, DA17

Freshly refurbished throughout and presented in excellent condition, this spacious three-bedroom family home is ideally located in the heart of Belvedere and offers generous living accommodation, a private rear garden, and excellent transport connections.

The property has recently undergone a full refurbishment, including fresh decoration throughout and newly fitted carpets to the living room, staircase and landing, creating a bright and welcoming feel from the moment you step inside.

The accommodation comprises a spacious living room/dining, a well-proportioned kitchen, family bathroom, and three exceptionally good-sized bedrooms, all offering ample space for double beds and additional furniture. Unlike many similar properties, all three bedrooms are generously sized, making the home ideal for families, professional sharers, or those needing additional home office space.

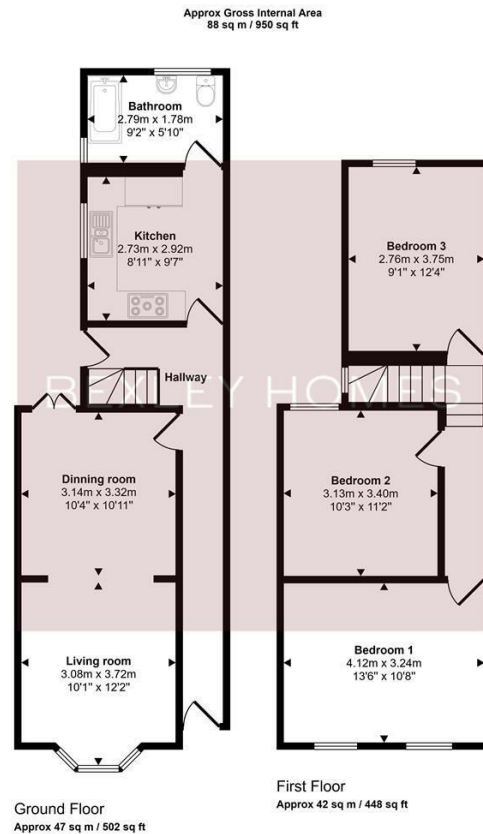

This floorplan is only for illustrative purposes and is not to scale. Measurements of rooms, doors, windows, and any items are approximate and no responsibility is taken for any error, omission or mis-statement. Icons of items such as bathroom suites are representations only and may not look like the real items. Made with Made Snappy 360.

Call us on  
01322 948500

Belvedere@bexleyhomes.co.uk  
www.bexleyhomes.co.uk

Council Tax Band

C

Energy Efficiency Rating		Current	Potential
Very energy efficient - lower running costs			
(92 plus)	A		
(81-91)	B		
(69-80)	C	70	
(55-68)	D		
(39-54)	E		
(21-38)	F		
(1-20)	G		
Not energy efficient - higher running costs			
England & Wales		EU Directive 2002/91/EC	

Agents Note: Whilst every care has been taken to prepare these particulars, they are for guidance purposes only. All measurements are approximate and are for general guidance purposes only and whilst every care has been taken to ensure their accuracy, they should not be relied upon and potential buyers are advised to recheck the measurements.

BEXLEY HOMES