

Need a Mortgage in principle to make offers? Call us now for quick assistance!
0121 775 0101



Do you need to sell? Start your journey now! Call us we can help.
0121 775 0101



SCAN FOR MORE INFO
SIZE - 1223 Sq Ft
TENURE - Freehold
COUNCIL TAX - Solihull Metropolitan Borough Council - E
BROADBAND - Upload Max 1000Mbps Download Max 1800Mbps
MOBILE - O2
EPC - C - 78
PARKING - Garage & Parking Space
FLOODRISK - Very Low
SERVICES - Mains
COVENANTS - N/A

5 Laxton Grove

Solihull, B91 2JT
Offers in Excess of £400,00

Situated in a tranquil cul-de-sac this charming semi-detached house offers a delightful blend of space and comfort, perfect for family living. This well-presented family home is a rare find in a sought-after location.

FEATURES

- Spacious Three Storey Semi-Detached Family Home
- Tastefully Presented Throughout
- Breakfast Kitchen with Integrated Appliances
- Bright Lounge Leading to a Sun Room
- Two Double Bedrooms with Wardrobes & Single Bedroom/Nursery to First Floor
- Family Bathroom
- Second Floor Principal Double Bedroom with Wardrobes & En-Suite
- Private Rear Garden
- Single Garage & Parking Space
- Convenient Location

Are you an investor interested in expanding your portfolio?

Call 0121 775 0101 to provide your investment criteria for alerts.



SCAN TO VIEW OUR WEEKLY FILMS & SUBSCRIBE

Sneak Peeks

Every week, we unveil "Sneak Peeks," a feature showcasing exclusive properties before they hit Rightmove and other platforms.

The Landlord Club

Join our Landlord Club for weekly updates on legislation, market trends, and our Letting Director's 'Investment Pick of the Week' for optimal ROI.

HTSPMD

Tune into 'How's The Solihull Property Market Dom' weekly for a quick, insightful snapshot of the market.

The Mortgage Update

Get weekly insights and the best deals with our Mortgage Update, your shortcut to navigating the complex mortgage landscape confidently.

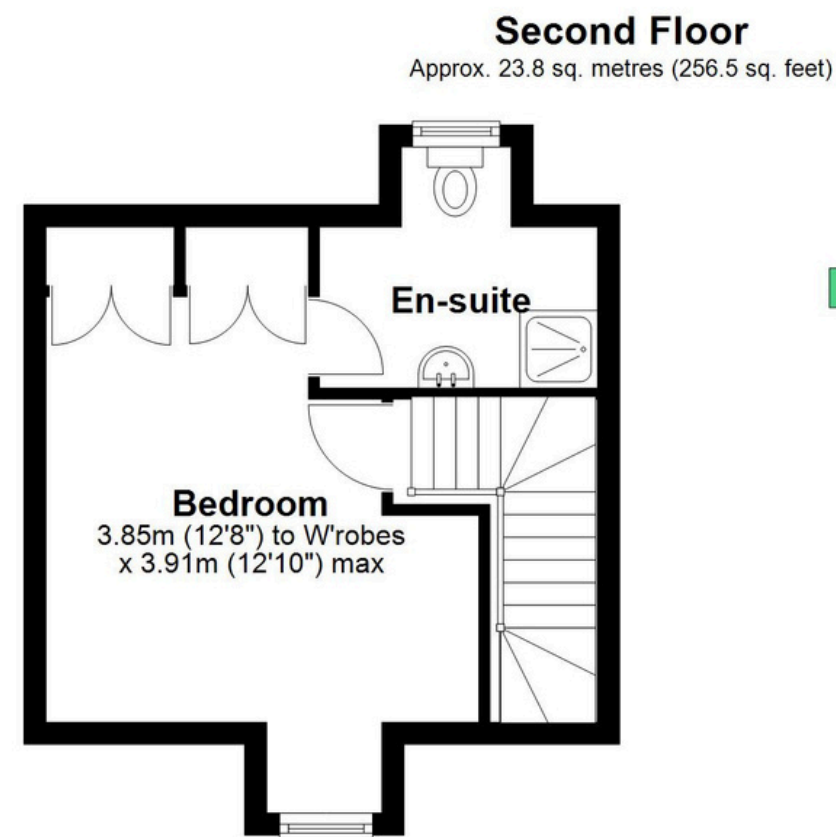
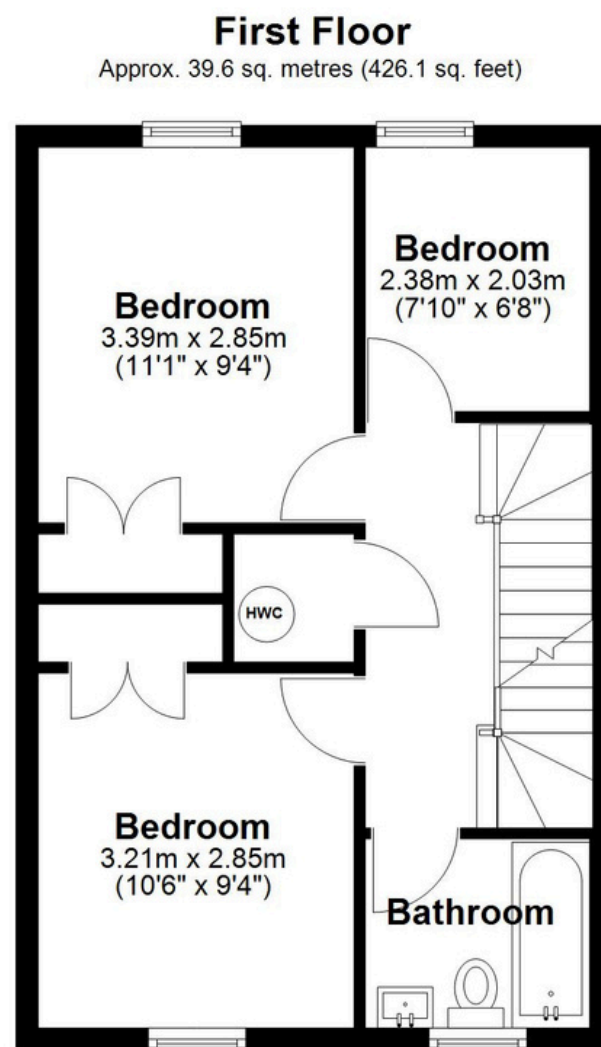
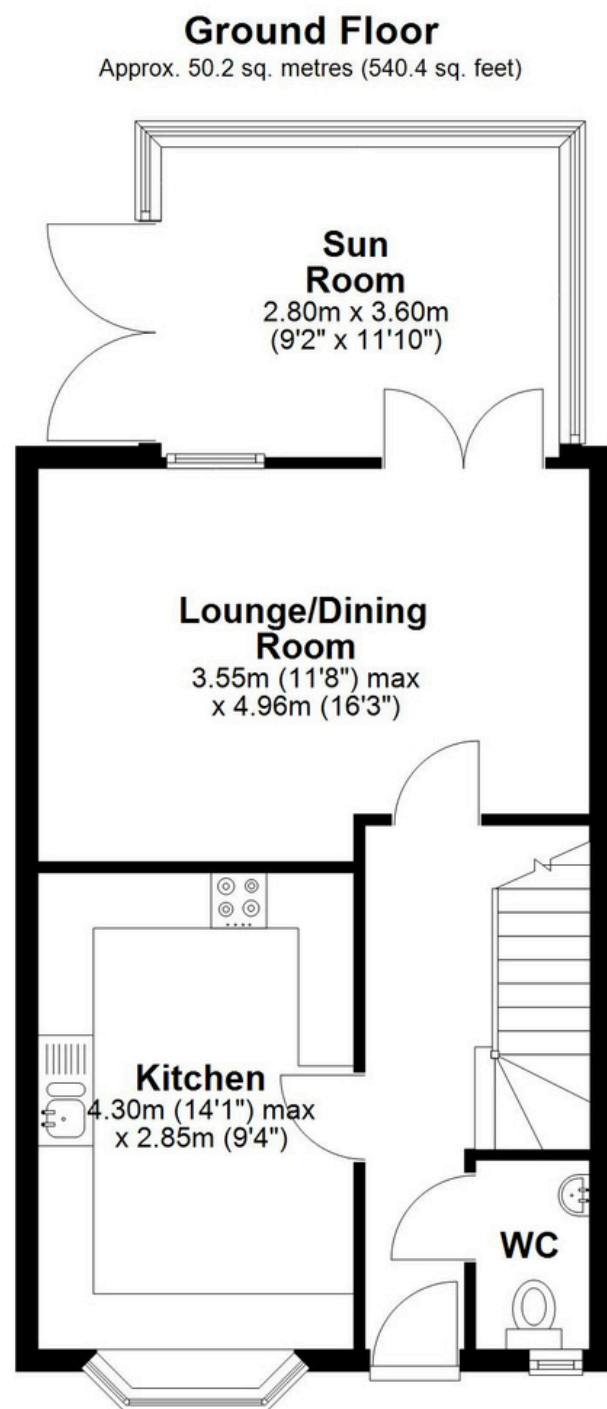

Actual position not shown



Total area: approx. 113.6 sq. metres (1223.0 sq. feet)

This floor plan is for illustration purposes only, this is not intended to be a measured/scaled survey or comply with RICS guidelines. All measurements (including total floor area) openings, orientation and floor area are approximate. No details are guaranteed, they cannot be relied upon for any purpose and do not form part of any agreement. A party must rely upon its own inspection(s). No responsibility is taken for any error, omission, or mis-statement.
Plan produced using PlanUp.