



3 bedroom Semi-Detached House located in Stanway.

Guide Price
£300,000 - £325,000

Find us on..



JOHN ALEXANDER
ESTATE AGENTS

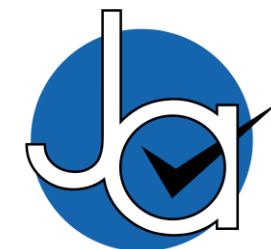

JOHN ALEXANDER
ESTATE AGENTS

London Road Stanway Colchester CO3 0HA



3



1



2



B



EPC

D



FULL DESCRIPTION

OVERVIEW

GUIDE PRICE £300,000 TO £325,000

Offered for sale with no onward chain, this beautifully renovated three-bedroom Victorian semi-detached home combines period character with modern-day comfort. Finished to an excellent standard throughout, the property benefits from a newly fitted kitchen and bathroom, new carpets and flooring, and a new boiler installed approximately one year ago. With off-road parking to the front and an impressive rear garden extending to around 150ft, this is a fantastic turnkey home ideally suited to first-time buyers, families and commuters alike.

STEP INSIDE

Upon entering the property, you are welcomed into a bright and inviting living room measuring 12'0" x 10'9" (3.7m x 3.3m). This attractive reception room enjoys a pleasant front aspect and offers a comfortable space for relaxing and entertaining, enhanced by the fresh décor and newly fitted flooring that continues the high standard of presentation seen throughout the home.

From the living room, an opening lead seamlessly into the dining room measuring 12'2" x 10'10" (3.7m x 3.3m). This versatile room provides ample space for a family dining table and is ideally positioned between the living accommodation and kitchen, creating a sociable layout for modern living.

The dining room measures 12'2" x 10'10" (3.7m x 3.3m) and provides an excellent space for formal dining and entertaining. Positioned between the dining room and kitchen is the staircase rising to the first floor, creating a natural division between the reception accommodation

and the rear of the property. Beyond this, the recently refurbished kitchen measures 14'7" x 7'4" (4.5m x 2.2m) and has been fitted with a stylish range of modern units, work surfaces and integrated cooking facilities, offering ample storage and preparation space.

Completing the ground floor is a modern family bathroom, fitted with a contemporary suite comprising panel-enclosed bath with overhead shower, wash hand basin and WC, finished to a high standard in keeping with the property's comprehensive renovation.

The first-floor landing provides access to all three bedrooms. The principal bedroom is positioned to the front of the property and measures 12'1" x 10'10" (3.7m x 3.3m), offering generous proportions and excellent natural light.

The second bedroom measures 10'10" x 9'0" (3.3m x 2.7m) and provides a comfortable double bedroom overlooking the rear garden. Lastly, the third bedroom measures 9'3" x 7'7" (2.8m x 2.3m), making an ideal child's bedroom, nursery, dressing room or home office.

STEP OUTSIDE

To the front of the property, a driveway provides the convenience of off-road parking.

The rear garden is a particular highlight of the home, extending to approximately 150ft in length. This impressive outdoor space offers excellent potential for families, keen gardeners and those who enjoy outdoor entertaining. The substantial plot provides a wonderful sense of privacy and includes extensive lawned areas with ample room for seating, recreation and future landscaping opportunities.



JA
JOHN ALEXANDER
ESTATE AGENTS

THE LOCATION

London Road is a highly convenient position within the popular Stanway area to the west of Colchester. The property is ideally situated for access to a wide range of local amenities including supermarkets, shops, restaurants, schools and leisure facilities. Stanway benefits from excellent transport links, with the nearby A12 providing straightforward access towards Chelmsford, the M25 and Ipswich, while Colchester City Centre and Colchester's mainline railway stations offer regular services to London Liverpool Street. The area is well regarded by families and commuters alike due to its combination of convenience, amenities and accessibility.



JA
JOHN ALEXANDER
ESTATE AGENTS



JA
JOHN ALEXANDER
ESTATE AGENTS



JA
JOHN ALEXANDER
ESTATE AGENTS



FLOORPLAN

GROUND FLOOR

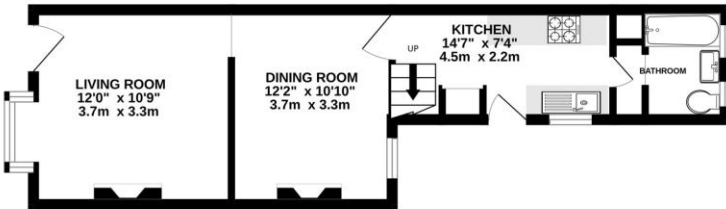

1ST FLOOR

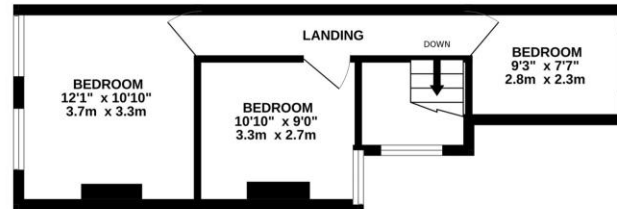

Whilst every attempt has been made to ensure the accuracy of the floorplan contained here, measurements of doors, windows, rooms and any other items are approximate and no responsibility is taken for any error, omission or mis-statement. This plan is for illustrative purposes only and should be used as such by any prospective purchaser. The services, systems and appliances shown have not been tested and no guarantee as to their operability or efficiency can be given.
Made with Metropix ©2026

DIRECTIONS

CONTACT

**99 London Road
Stanway
Colchester
Essex
CO3 0NY**

E sales@john-alexander.co.uk

T 01206 656007

www.john-alexander.co.uk

Find us on..



JOHN ALEXANDER
ESTATE AGENTS