



## ESSEX VILLAS

London W8



## WHITE STUCCO FRONTED HOUSE

This is the first time in a generation that this house has become available. The house has been a much-loved family home for many years, and it is likely that any purchaser will undertake a comprehensive refurbishment.

   EPC  
6 3 3 D

Local Authority: Royal Borough of Kensington and Chelsea

Council Tax band: H

Tenure: Leasehold 61 years from 25th March 1973 (approximately 7 years remaining)

Ground rent: for the period 25/03/26 to 23/06/26, approximately £1,937, with reviews every 25 years

Offers in excess of: £1,250,000



A magnificent opportunity to purchase an unmodernised white stucco fronted house, on the Phillimore Estate.

The property is based over four floors, and occupies approximately 3,524 sq ft, with a wonderful 32ft south-facing garden. The lease length is 61 years from 25th March 1973, expiring on 25th March 2034 with approximately 7+ years remaining.

Essex Villas is set on a quiet residential street in the heart of Kensington (W8), one of West London's most desirable areas. The property is within easy reach of Kensington High Street, Holland Park, and excellent transport links at High Street Kensington Underground station, offering a blend of tranquillity, convenience and prestige.

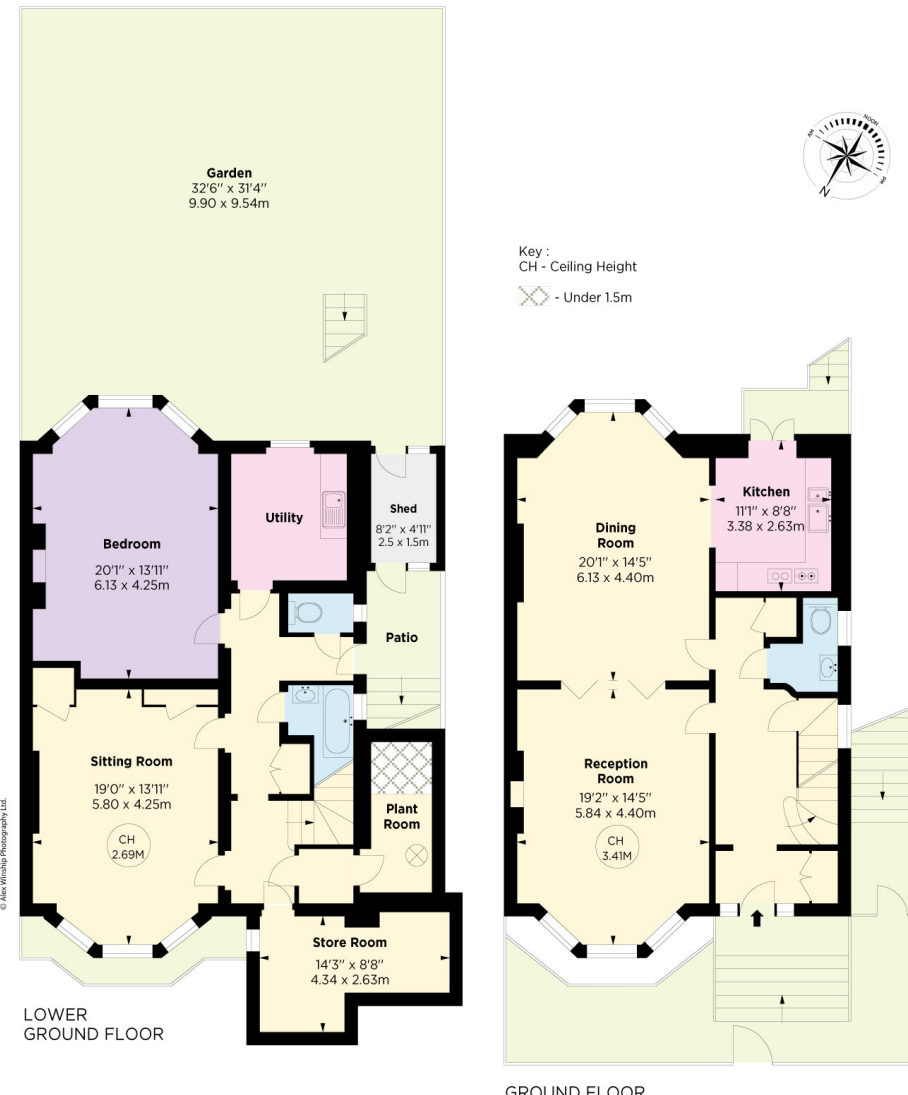

### Essex Villas, W8

APPROX. GROSS INTERNAL AREA \*  
3524 Sq Ft - 327.47 Sq M  
(Including 1.67 Sq M of Under 1.5m Area & Excluding Shed)

APPROX. SHED AREA \*  
40 Sq Ft - 3.72 Sq M

TOTAL APPROX. GROSS INTERNAL AREA \*  
3564 Sq Ft - 331.19 Sq M

This floorplan is for GUIDANCE ONLY and NOT FOR VALUATION purposes.

Approximate Gross Internal Area = 327.47 sq m / 3524 sq ft

This plan is for layout guidance only. Not drawn to scale unless stated. Windows and door openings are approximate. Whilst every care is taken in the preparation of this plan, please check all dimensions, shapes and compass bearings before making any decisions reliant upon them. (ID767266)

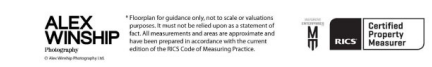

We would be delighted  
to tell you more.

**James Pace**

078 67800449

James.Pace@knightfrank.com

**Knight Frank Kensington**

52 56 Kensington Church Street

W8 4DB

[knightfrank.co.uk](https://www.knightfrank.co.uk)

Your partners in property

1. Particulars: These particulars are not an offer or contract, nor part of one. You should not rely on statements given by Knight Frank in the particulars, by word of mouth or in writing ("information") as being factually accurate about the property, its condition or its value. Neither Knight Frank nor any joint agent has any authority to make any representations about the property, and accordingly any information given is entirely without responsibility on the part of Knight Frank. 2. Material Information: Please note that the material information is provided to Knight Frank by third parties and is provided here as a guide only. While Knight Frank has taken steps to verify this information, we advise you to confirm the details of any such material information prior to any offer being submitted. If we are informed of changes to this information by the seller or another third party, we will use reasonable endeavours to update this as soon as practical. 3. Photos, Videos etc: The photographs, property videos and virtual viewings etc. show only certain parts of the property as they appeared at the time they were taken. Areas, measurements and distances given are approximate only. 4. Regulations etc: Any reference to alterations to, or use of, any part of the property does not mean that any necessary planning, building regulations or other consent has been obtained. A buyer must find out by inspection or in other ways that these matters have been properly dealt with and that all information is correct. 5. Fixtures and fittings: A list of the fitted carpets, curtains, light fittings and other items fixed to the property which are included in the sale (or may be available by separate negotiation) will be provided by the Seller's Solicitors. 6. VAT: The VAT position relating to the property may change without notice. 7. To find out how we process Personal Data, please refer to our Group Privacy Statement and other notices at <https://www.knightfrank.com/legals/privacy-statement>.

Particulars dated May 2026. Photographs and videos dated May 2026. All information is correct at the time of going to print. Knight Frank is the trading name of Knight Frank LLP. Knight Frank LLP is a limited liability partnership registered in England and Wales with registered number OC305934. Our registered office is at 55 Baker Street, London W1U 8AN. We use the term 'partner' to refer to a member of Knight Frank LLP, or an employee or consultant. A list of members names of Knight Frank LLP may be inspected at our registered office. If you do not want us to contact you further about our services then please contact us by either calling 020 3544 0692, email to [marketing.help@knightfrank.com](mailto:marketing.help@knightfrank.com) or post to our UK Residential Marketing Manager at our registered office (above) providing your name and address.