



Briar Lea Close, Sinfin Derby, DE24 9PB

welcome to

Briar Lea Close, Sinfin Derby

A stylish and well-maintained three-bedroom semi-detached home in a quiet Sinfin location, offering bright living spaces, a modern kitchen/diner, generous garden and driveway parking, close to schools, shops and major road links.



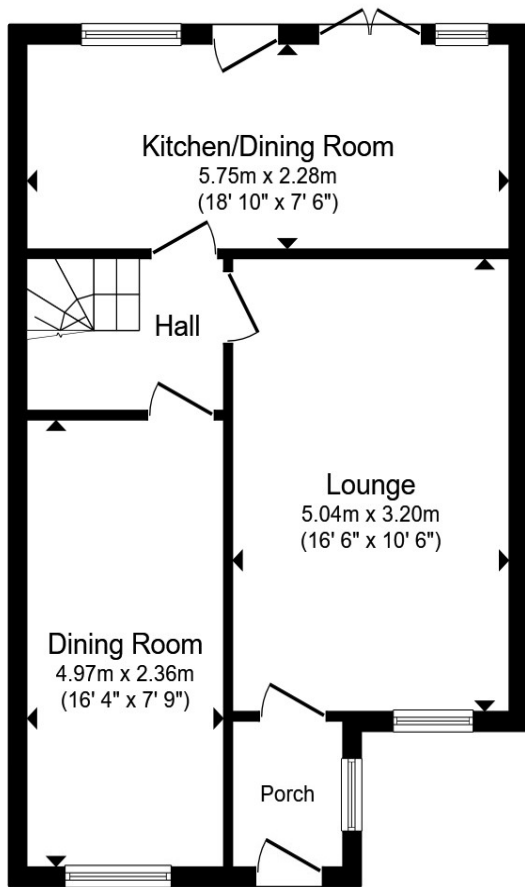

Ground Floor

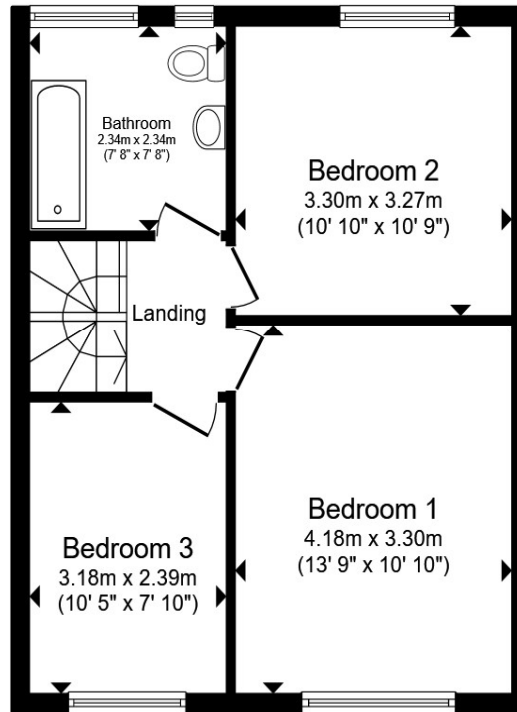

First Floor

Dining Room

16' 4" MAX x 7' 9" MAX (4.98m MAX x 2.36m MAX)

Lounge

16' 6" MAX x 10' 6" MAX (5.03m MAX x 3.20m MAX)

Kitchen/Diner

18' 10" MAX x 7' 6" MAX (5.74m MAX x 2.29m MAX)

Bedroom 1

13' 9" MAX x 10' 10" MAX (4.19m MAX x 3.30m MAX)

Bedroom 2

10' 10" MAX x 10' 9" MAX (3.30m MAX x 3.28m MAX)

Bedroom 3

10' 5" MAX x 7' 10" MAX (3.17m MAX x 2.39m MAX)

Bathroom

7' 6" MAX x 7' 6" MAX (2.29m MAX x 2.29m MAX)

Total floor area 91.9 m² (989 sq.ft.) approx

This floor plan is for illustrative purposes only. It is not drawn to scale. Any measurements, floor areas (including any total floor area), openings and orientation are approximate. No details are guaranteed, they cannot be relied upon for any purpose and they do not form part of any agreement. No liability is taken for any error, omission or misstatement. A party must rely upon its own inspection(s). Powered by www.propertybox.io



welcome to

Briar Lea Close, Sinfin, Derby

- Three-bedroom semi-detached family home
- Bright lounge with gas fire and separate dining room
- Contemporary kitchen/diner with integrated appliances
- Patio doors leading to a generous private rear garden
- Two double bedrooms plus a single; fitted cupboards to all

Tenure: Freehold EPC Rating: C
Council Tax Band: B

£220,000



Please note the marker reflects the postcode not the actual property

view this property online [bagshawsresidential.co.uk/Property/DBY121372](https://www.bagshawsresidential.co.uk/Property/DBY121372)



Property Ref:
DBY121372 - 0003

1. MONEY LAUNDERING REGULATIONS Intending purchasers will be asked to produce identification documentation at a later stage and we would ask for your co-operation in order that there is no delay in agreeing the sale. 2. These particulars do not constitute part or all of an offer or contract. 3. The measurements indicated are supplied for guidance only and as such must be considered incorrect. Potential buyers are advised to recheck measurements before committing to any expense. 4. We have not tested any apparatus, equipment, fixtures or services and it is in the buyers interest to check the working condition of any appliances. 5. Where an EPC, or a Home Report (Scotland only) is held for this property, it is available for inspection at the branch by appointment. If you require a printed version of a Home Report, you will need to pay a reasonable production charge reflecting printing and other costs. 6. We are not able to offer an opinion either written or verbal on the content of these reports and this must be obtained from your legal representative. 7. Whilst we take care in preparing these reports, a buyer should ensure that his/her legal representative confirms as soon as possible all matters relating to title including the extent and boundaries of the property and other important matters before exchange of contracts.

Bagshaws Residential is a trading name of Sequence (UK) Limited which is registered in England and Wales under company number 4268443, Registered Office is Cumbria House, 16-20 Hockliffe Street, Leighton Buzzard, Bedfordshire, LU7 1GN. VAT Registration Number is 500 2481 05.



bagshaws residential



01332 361308



Derby@bagshawsresidential.co.uk



32-34 Cornmarket, DERBY, Derbyshire, DE1 2DG



[bagshawsresidential.co.uk](https://www.bagshawsresidential.co.uk)