



AKUA OTENG

exp

@ akua.oteng@exp.uk.com

akuaoteng.exp.uk.com

07852 280 188

Bywater Place, Rotherhithe SE16

Guide Price £425,000

🛏️ 2 🚿 1 🚗 1



- Please Quote A01571 For All Enquiries
- 2 Bedroom Maisonette
- Share Of Freehold
- Direct Access to Outside Undemised Space
- Easy Reach to Canada Water Station with Canary Wharf one stop away
- Guide Price £425,000 - £475,000
- Allocated Parking Space
- Move in Ready Condition
- Rotherhithe, SE16 in Zone 2



Please Quote A01571 For All Enquiries

Bright two-bedroom maisonette in a quiet Rotherhithe cul-de-sac, moments from Canada Water, Surrey Quays and the River Thames. Offering a practical layout, Share of Freehold, direct access to outdoor undemised space and allocated parking, this SE16 home combines calm residential living with excellent transport links and strong local amenities.

It's a smart choice for buyers wanting convenience, connectivity and long-term appeal in one of south-east London's most desirable pockets.

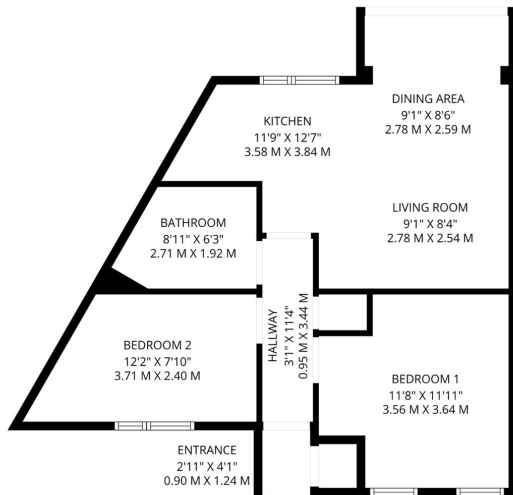

Total: 574 sq. Ft. 53 m2
 Ground Floor: 574 sq. Ft. 53 m2
 Excluded Areas: Entrance: 12 sq. Ft. 1 M2, Undefined: 6 sq. Ft. 1 M2, Walls: 62 sq. Ft. 5 m2
FLOOR PLAN CREATED BY CURIOUSAPP. MEASUREMENTS DEEMED HIGHLY RELIABLE BUT NOT GUARANTEED.

Score	Energy rating	Current	Potential
92+	A		
81-91	B		
69-80	C		73 C
55-68	D	55 D	
39-54	E		
21-38	F		
1-20	G		