



3, The Pinfold, Middleton-By-Youlgrave, DE45 1LS

3, The Pinfold

Middleton-By-Youlgrave, DE45 1LS

This stylish and comfortable apartment is idyllically located in a lovely quiet village surrounded by wonderful open countryside.

The accommodation briefly comprises of entry via a communal door with stairs to the first floor landing serving two apartments. A private entrance door opens to a hallway which benefits from three generous storage closets. The newly refurbished bathroom features contemporary style fittings and a shower bath.

The kitchen features a range of fitted base units with rustic style shelving which adds character and provides useful storage.

The sitting room has space for a dining table and chairs and is light and airy with lovely views over the surrounding area.

The accommodation is completed by a double bedroom and two single bedrooms, either of which could serve as a home office.

OUTSIDE

Front garden: Low maintenance garden with areas for seating and views of the village and local countryside. Some wall boundaries.

Rear: to the back is a communal lawned area with patio and off street parking.

LOCATION

Middleton by Youlgrave is a picturesque village in the heart of the Peak District National Park, surrounded by open countryside and offering excellent access to walking, cycling and bridleways.

Nearby Youlgrave provides a wide range of amenities including a primary school, doctor's surgery, village shop, pubs, church and public transport links. The area falls within the catchment area for the well-regarded Lady Manners Secondary School.

- Stylish first floor apartment
- Lovely village location with great views
- One double and two single bedrooms
- Garden and off road parking
- Newly refurbished kitchen and bathroom
- Long lease
- Three year local occupancy clause applies





First Floor

Approx. 62.1 sq. metres (668.2 sq. feet)

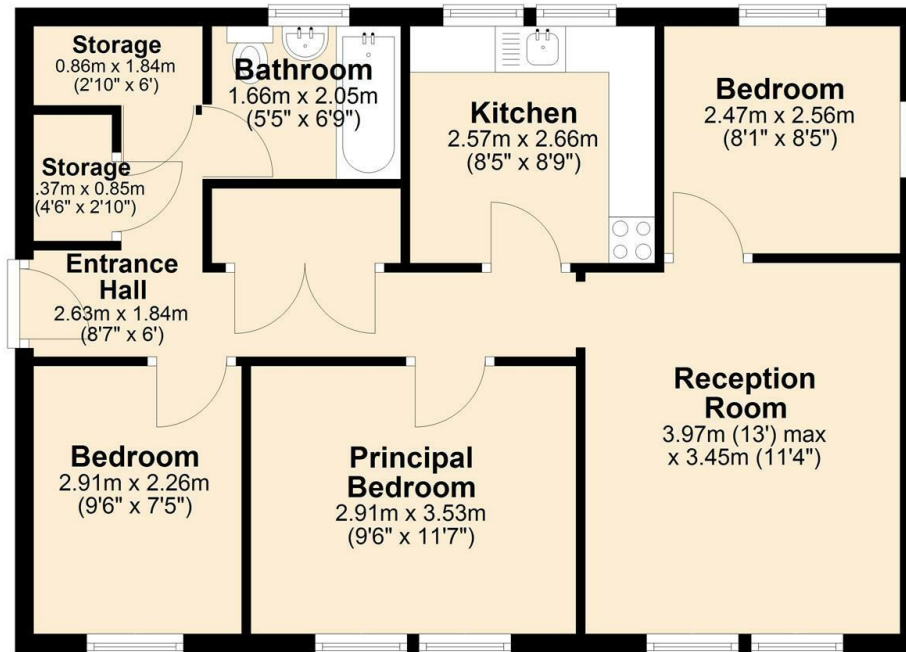

Total area: approx. 62.1 sq. metres (668.2 sq. feet)



Bakewell
3 Royal Oak Place
Matlock Street
Bakewell DE45 1HD
T: 01629 700699
E: bakewell@elr.co.uk

Banner Cross
888 Ecclesall Road
Banner Cross
Sheffield S11 8TP
T: 01142 683388
E: bannercross@elr.co.uk

Dore
33 Townhead Road
Sheffield
S17 3GD
T: 0114 2362420
E: dore@elr.co.uk

Hathersage
Main Road, Hathersage
Hope Valley
Derbyshire S32 1BB
T: 01433 651888
E: peakdistrict@elr.co.uk

Rotherham
149 Bawtry Road
Wickersley
Rotherham S66 2BW
T: 01709 917676
E: wickersley@elr.co.uk

**EADON
LOCKWOOD
& RIDDLE**
ESTD 1840