



Connells

Oakfield Road
Wordsley Stourbridge



Property Description

A STUNNING PERIOD MID TERRACED SITUATED IN A MUCH SOUGHT AFTER CUL-DE-SAC IN WORDSLEY. WELL PRESENTED THROUGHOUT & MAINTAINING MANY ORIGINAL FEATURES INCLUDING COVING, CEILING ROSES AND PICTURE RAILS. MUST BE VIEWED INTERNALLY TO FULLY APPRECIATE THE SIZE OF ACCOMMODATION ON OFFER. Oakfield Road is an attractive cul-ce-sac housing a variety of traditional properties. There are green spaces very close by for dog walking etc as well as a number of eateries and public houses around the corner on Brettell Lane.

To The Front

Path leading to front door with courtyard garden to side.

Lounge

Front door leads into lounge with double glazed bay window to front elevation, radiator, fireplace and door to;

Dining Room

Double glazed window to rear elevation, radiator and doors to understairs cupboard, staircase and;

Kitchen

Double glazed window and door to side elevation. A range of wall and base units. Work surfaces incorporating Belfast sink. Electric hob and oven with extractor hood above. Provision for further domestic appliances.

Landing

Doors to;

Bedroom One

Double glazed window to front elevation and radiator.

Bedroom Two

Double glazed window to rear elevation and radiator. Overstairs storage cupboard with loft access.

Bedroom Three

Double glazed window to rear elevation and radiator.

Bathroom

Double glazed window to side elevation and towel rail radiator. Suite comprising paneled bath with power shower over, wash hand basin and low flush wc.

Rear Garden

Fully enclosed rear garden with patio leading to lawn with gate to rear. Garden store outbuilding.



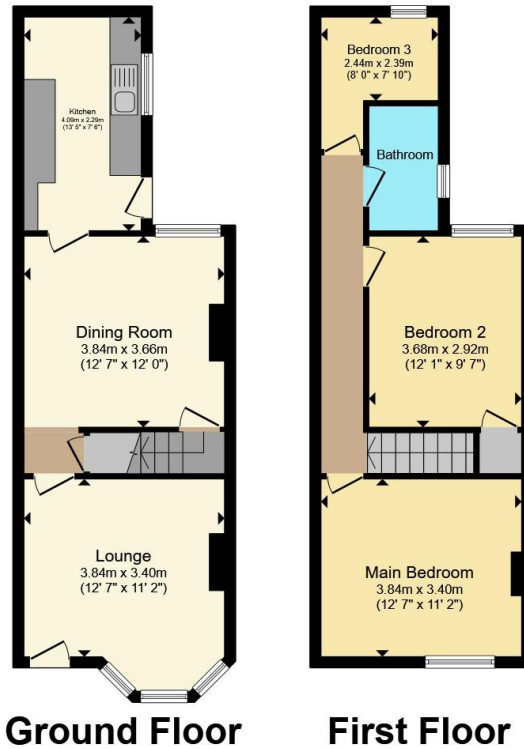

Total floor area 81.6 m² (879 sq.ft.) approx

This floor plan is for illustrative purposes only. It is not drawn to scale. Any measurements, floor areas (including any total floor area), openings and orientation are approximate. No details are guaranteed, they cannot be relied upon for any purpose and they do not form part of any agreement. No liability is taken for any error, omission or misstatement. A party must rely upon its own inspection(s). Powered by www.propertybox.io



To view this property please contact Connells on

T 01384 374 545
E stourbridge@connells.co.uk

11B St. Johns Road
 STOURBRIDGE DY8 1EJ

EPC Rating: Council Tax
 Awaited Band: A

view this property online connells.co.uk/Property/SBR313570

Tenure: Freehold



1. MONEY LAUNDERING REGULATIONS Intending purchasers will be asked to produce identification documentation at a later stage and we would ask for your co-operation in order that there will be no delay in agreeing the sale. 2. These particulars do not constitute part or all of an offer or contract. 3. The measurements indicated are supplied for guidance only and as such must be considered incorrect. Potential buyers are advised to recheck measurements before committing to any expense. 4. We have not tested any apparatus, equipment, fixtures, fittings or services and it is in the buyers interest to check the working condition of any appliances.

Connells Residential is registered in England and Wales under company number 1489613, Registered Office is Cumbria House, 16-20 Hockliffe Street, Leighton Buzzard, Bedfordshire, LU7 1GN. VAT Registration Number is 500 2481 05.

See all our properties at www.connells.co.uk | www.rightmove.co.uk | www.zoopla.co.uk

Property Ref: SBR313570 - 0003