



Lemsford Village, Lemsford Welwyn Garden City AL8 7TN



welcome to

Lemsford Village, Lemsford Welwyn Garden City

This beautifully presented two-bedroom Victorian cottage enjoys a charming riverside patio garden and is situated in the sought-after village of Lemsford, a picturesque location on the edge of Welwyn Garden City. The property is conveniently positioned for local transport links, with the A1 just a short drive away and Welwyn Garden City railway station offering regular fast services into London King's Cross. The ground floor comprises a welcoming lounge featuring a fireplace, along with a fully fitted kitchen/dining room with doors opening directly onto the riverside terrace, creating an ideal space for indoor-outdoor living. Upstairs, the cottage offers two well-proportioned bedrooms and a family bathroom. Further benefits include double glazing throughout, parquet flooring downstairs and underfloor heating. Externally, a gated side access leads to a shared pathway (with the neighbouring property) opening onto a private brick-paved riverside garden that extends out over the River Lea, providing a truly unique and tranquil outdoor setting.



Lounge

Double glazed window to front, wooden flooring, fireplace, underfloor heating.

Kitchen/Dining Room

Double glazed window, French door to terrace, wooden flooring, underfloor heating, sink/drainage, integrated fridge freezer, electric oven, gas hob.

Bedroom One

Double glazed window to front, engineered wood flooring, underfloor heating, fireplace.

Bedroom Two

Double glazed window, engineered wood flooring, underfloor heating.

Bathroom

Double glazed window, tiled flooring, bath with shower over, W/C, wash hand basin, heated towel rail.

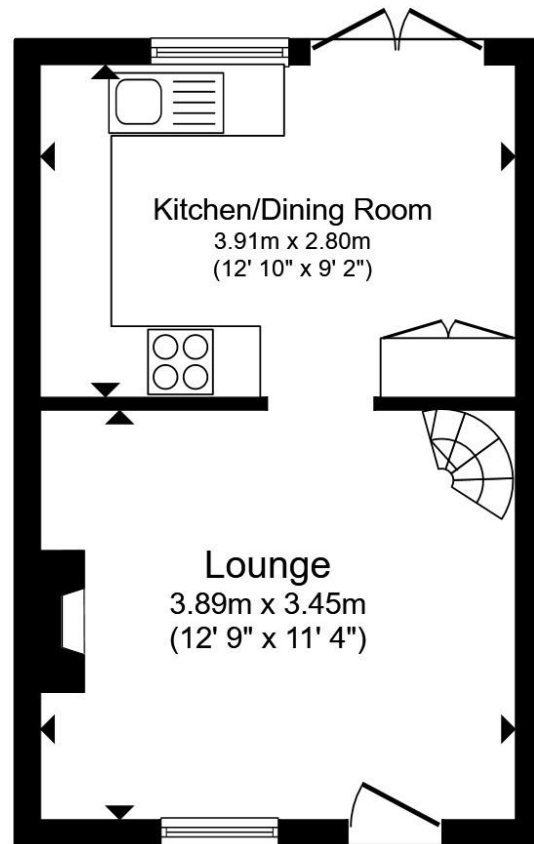

Ground Floor

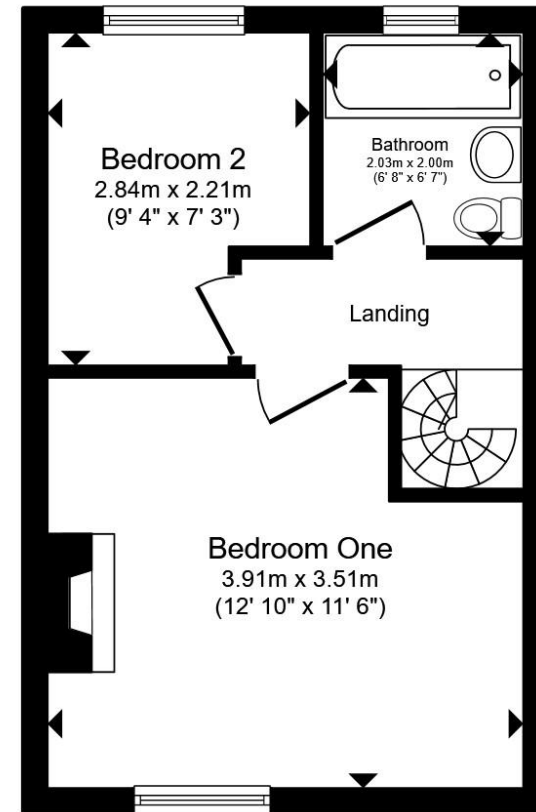

First Floor

Total floor area 50.8 m² (547 sq.ft.) approx

This floor plan is for illustrative purposes only. It is not drawn to scale. Any measurements, floor areas (including any total floor area), openings and orientation are approximate. No details are guaranteed, they cannot be relied upon for any purpose and they do not form part of any agreement. No liability is taken for any error, omission or misstatement. A party must rely upon its own inspection(s). Powered by www.propertybox.io



welcome to

Lemsford Village, Lemsford Welwyn Garden City

- Victorian Semi-Detached Cottage
- Underfloor Heating
- Two Bedrooms
- On Street Parking
- Riverside Patio Garden

Tenure: Freehold EPC Rating: D
Council Tax Band: D



guide price

£400,000



check out more properties at williamhbrown.co.uk

Please note the marker reflects the
postcode not the actual property



Property Ref:
WGN109511 - 0003

1. MONEY LAUNDERING REGULATIONS Intending purchasers will be asked to produce identification documentation at a later stage and we would ask for your co-operation in order that there is no delay in agreeing the sale. 2. These particulars do not constitute part or all of an offer or contract. 3. The measurements indicated are supplied for guidance only and as such must be considered incorrect. Potential buyers are advised to recheck measurements before committing to any expense. 4. We have not tested any apparatus, equipment, fixtures or services and it is in the buyers interest to check the working condition of any appliances. 5. Where an EPC, or a Home Report (Scotland only) is held for this property, it is available for inspection at the branch by appointment. If you require a printed version of a Home Report, you will need to pay a reasonable production charge reflecting printing and other costs. 6. We are not able to offer an opinion either written or verbal on the content of these reports and this must be obtained from your legal representative. 7. Whilst we take care in preparing these reports, a buyer should ensure that his/her legal representative confirms as soon as possible all matters relating to title including the extent and boundaries of the property and other important matters before exchange of contracts.

William H Brown is a trading name of Sequence (UK) Limited which is registered in England and Wales under company number 4268443, Registered Office is Cumbria House, 16-20 Hockliffe Street, Leighton Buzzard, Bedfordshire, LU7 1GN. VAT Registration Number is 500 2481 05.

william h brown



01707 324361



WelwynGardenCity@williamhbrown.co.uk



53 Wigmores North, WELWYN GARDEN CITY,
Hertfordshire, AL8 6PG



williamhbrown.co.uk