



redrose

4 Hannah Court

Buckshaw Village, Chorley, PR7 7AX

This well-presented 2-bedroom maisonette offers the perfect blend of comfort, style, and practicality. Set across two floors, the property features a spacious living area filled with natural light, a modern fitted kitchen, and two generously sized bedrooms. The main bedroom boasts ample storage, whi...

Offers Over £90,000

EPC Rating 'TBC'





Property Description

FRONT DOOR TO HALLWAY

hallway with doors to the ground floor rooms and stairs to the first floor

MASTER BEDROOM

9' 7" x 7' 11" (2.92m x 2.41m) A light and airy master bedroom with double glazed window and heating.

BEDROOM TWO

9' 3" x 7' 11" (2.82m x 2.41m) Another good size room with double glazed window and heating

SHOWER ROOM

6' 2" x 5' 2" (1.88m x 1.57m) Fitted with a three piece suite comprising walk in tiled shower cubicle, pedestal wash hand basin and low level W.C

OPEN PLAN LOUNGE/DINING ROOM

19' 2" x 14' 2" (5.84m x 4.32m) This contemporary open-plan space seamlessly integrates the lounge, dining, and kitchen areas, creating a bright, multifunctional living





environment ideal for modern lifestyles. The layout encourages sociability and easy movement while offering clear zoning through thoughtful design choices. A double glazed window and French door to the Juliette balcony.

The kitchen area is fitted with a range of wall and base units with complimentary work surfaces over. Part tile walls, Sink with drainer and mixer tap and integral oven and hob with extractor hood and light.

EXTERNALLY

The property benefits from communal grounds and allocated parking.





GROUND FLOOR



1ST FLOOR

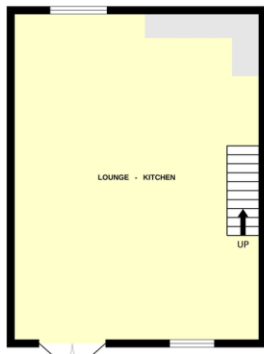

%epcGraph_c_1_325%

Whilst every attempt has been made to ensure the accuracy of the description contained here, measurements of areas, volumes, rooms and any other parts are approximate and no responsibility is taken for any mis-statement or mis-statement. This plan is for illustrative purposes only and should be used as such by any prospective purchaser. The accuracy, content and copyright shall not be held and no guarantee is given for the accuracy of drawings and for plans.
Made with Metaphor (2022)

Redrose
15 Barnes Wallis Way
Buckshaw Village
Chorley
Lancs

www.redrosepm.co.uk
sales@redrose.co.uk
01772 456558

Agents Note: Whilst every care has been taken to prepare these sales particulars, they are for guidance purposes only. All measurements are approximate are for general guidance purposes only and whilst every care has been taken to ensure their accuracy, they should not be relied upon and potential buyers are advised to recheck the measurements