



Rectory Court Churchfield, Bishops Cleeve, Cheltenham, GL52
£130,000

**ADAM
HALLIWELL**
property

exp UK

Bedrooms: 1

Bathrooms: 1

Receptions: 1

An immaculate, refurbished first-floor one-bedroom retirement flat (over 55s) for sale in the heart of Bishops Cleeve, offering lift access, communal gardens and lounge, house manager, guest suite, parking, a Juliet balcony with views towards Cleeve Hill, and superb access to village amenities and public transport.

This immaculate one-bedroom retirement flat is offered for sale in the heart of Bishops Cleeve, Cheltenham. Forming part of a purpose-built retirement development, the property is situated on the first floor with lift access and benefits from communal parking and a dedicated house manager on site. It is available with no onward chain and is designed for over 55's only.

Internally, the flat has been refurbished, with new carpets and redecoration throughout. The spacious reception room features doors opening onto a Juliet balcony, providing pleasant views over the communal gardens and towards Cleeve Hill. Off the lounge is a kitchen area presented in smart condition and including appliances, making it practical and convenient.

The double bedroom includes built-in wardrobes, offering good storage. A refitted shower room provides a large walk-in shower, designed for ease of use and low maintenance. Electric heating serves the flat.

Residents benefit from a communal lounge with kitchen facilities, which hosts a busy social calendar with optional participation, allowing buyers to choose the level of community involvement that suits them. There is also a guest suite that can be booked via the manager, providing comfortable accommodation for visiting friends or family.

Located in the heart of the village, the property has doctors, chemist and a range of shops quite literally on the doorstep, together with other local amenities. Bishops Cleeve offers level walking routes around the village and out towards the surrounding countryside and Cleeve Hill.





Property Type: Retirement

This immaculate one-bedroom retirement flat is offered for sale in the heart of Bishops Cleeve, Cheltenham. Forming part of a purpose-built retirement development, the property is situated on the first floor with lift access and benefits from communal parking and a dedicated house manager on site. It is available with no onward chain and is designed for over 55's only.

Internally, the flat has been refurbished, with new carpets and redecoration throughout. The spacious reception room features doors opening onto a Juliet balcony, providing pleasant views over the communal gardens and towards Cleeve Hill. Off the lounge is a kitchen area presented in smart condition and including appliances, making it practical and convenient.

The double bedroom includes built-in wardrobes, offering good storage. A refitted shower room provides a large walk-in shower, designed for ease of use and low maintenance. Electric heating serves the flat.

Residents benefit from a communal lounge with kitchen facilities, which hosts a busy social calendar with optional participation, allowing buyers to choose the level of community involvement that suits them. There is also a guest suite that can be booked via the manager, providing comfortable accommodation for visiting friends or family.

Located in the heart of the village, the property has doctors, chemist and a range of shops quite literally on the doorstep, together with other local amenities. Bishops Cleeve offers level walking routes around the village and out towards the surrounding countryside and Cleeve Hill.

Public transport links are close by, with regular bus services into Cheltenham town centre, typically taking around 20–25 minutes, providing access to a wider range of shops, dining and leisure facilities. From Cheltenham Spa railway station, there are direct services to Gloucester, Bristol, Birmingham and London Paddington.

This well-positioned retirement flat combines an immaculate interior with excellent on-site facilities and convenient access to village amenities and public transport. Council Tax Band: B.



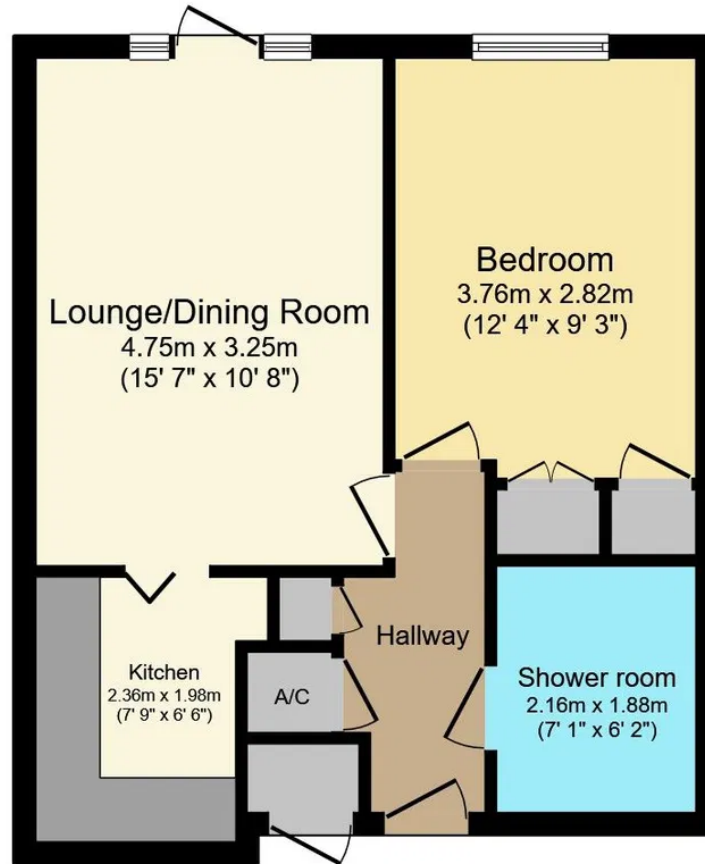

First Floor

Floor area 44.0 sq.m. (474 sq.ft.)

Total floor area: 44.0 sq.m. (474 sq.ft.)

This floor plan is for illustrative purposes only. It is not drawn to scale. Any measurements, floor areas (including any total floor area), openings and orientations are approximate. No details are guaranteed, they cannot be relied upon for any purpose and do not form any part of any agreement. No liability is taken for any error, omission or misstatement. A party must rely upon its own inspection(s). Powered by www.Propertybox.io

Rectory Court Churchfield, Bishops Cleeve, Cheltenham, GL52

£130,000

**ADAM
HALLIWELL**
property

exp UK