



LINDEN GARDENS, W2

£625,000

Excellent condition
High ceilings
Quiet position
Just off Notting Hill Gate
Grand reception room
EPC- C

@marshandparsons
marshandparsons.co.uk

MARSH &
PARSONS

ABOUT THE PROPERTY

A beautifully presented one bedroom raised ground floor apartment just off Notting Hill Gate. This well configured property has been recently refurbished throughout.

Linden Gardens is wonderfully positioned just off Notting Hill Gate, ideally positioned for the fantastic array of restaurants, cafes, and boutique shops of the area. The green open spaces of Kensington Gardens are just a short stroll away whilst there are excellent transport links with easy access to the Central, Circle and District lines at Notting Hill Gate.







FURTHER DETAILS

The accommodation features a lovely grand reception room with ample dining space, great volume and large windows. Furthermore, there is a contemporary designed, separate, fully integrated kitchen, generous double bedroom to the rear with excellent storage space and a smartly finished bathroom with a bath.



STEP INSIDE LINDEN GARDENS

Linden Gardens, W2

APPROX. GROSS INTERNAL FLOOR AREA
425 SQFT / 39.5 SQM

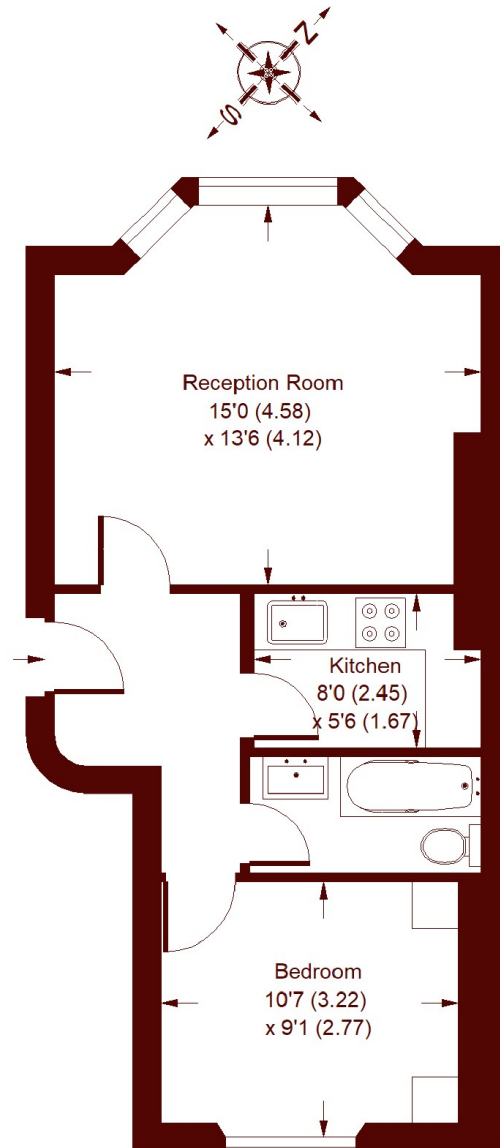

RAISED GROUND FLOOR

Whilst every attempt has been made to ensure the accuracy of the floor plan, measurements are approximate and not to scale.
No guarantee is given on the total square footage of the property quoted on the plan. Figures given are for guidance.
Plan is for illustration purposes only, not to be used for valuations.

Notting Hill
020 7313 2890

Energy Rating: C We aim to make our particulars both accurate and reliable. However, they are not guaranteed; nor do they form part of an offer or contract. If you require clarification on any points then please contact us, especially if you're traveling some distance to view. Please note that appliances and heating systems have not been tested and therefore no warranties can be given as to their good working order

MARSH &
PARSONS