

# Rolfe East



Castlebar Hill, Ealing, W5 1TF

£1,795 Per Calendar Month

- Two double bedrooms
- Good condition
- Unfurnished
- Available now
- First floor flat
- Gas central heating and water
- Double glazed windows
- EPC rating: E / council tax band: E

A bright and spacious two double first floor flat set in the well maintained grounds of Courtlands on Castlebar Hill. The property is presented in a good newly decorated condition throughout and is available unfurnished or part furnished. It is just 16 minutes walk to Ealing Broadway Station or 7 minutes on the bus. The property is available now.

 2  1  1  E

Council Tax Band: E



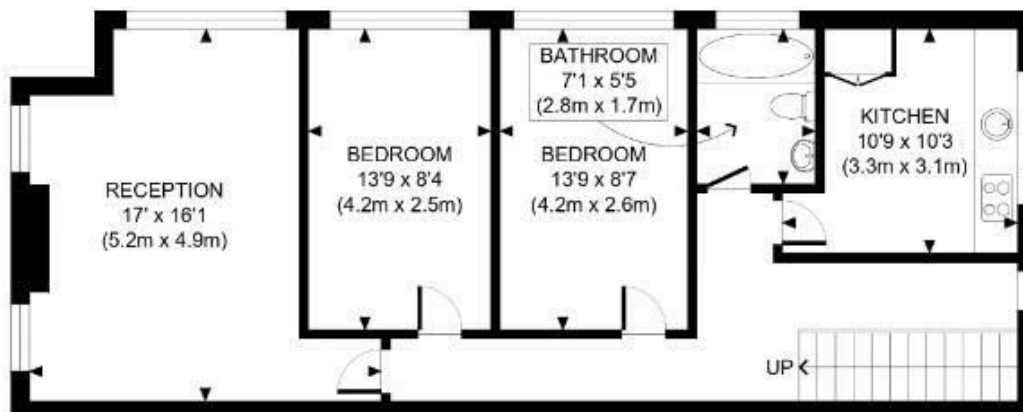

FIRST FLOOR  
GROSS INTERNAL  
FLOOR AREA 756 SQ FT



GROUND FLOOR  
GROSS INTERNAL  
FLOOR AREA WITH GARAGE 254 SQ FT  
FLOOR AREA WITHOUT GARAGE 223 SQ FT

APPROX. GROSS INTERNAL FLOOR AREA WITH GARAGE: 1010 SQ FT/ 94 SQM  
APPROX. GROSS INTERNAL FLOOR AREA WITHOUT GARAGE: 979 SQ FT/ 91 SQM

**Rolfe East**

This plan is for illustrative purposes only and should be used as such by any prospective client. Whilst every attempt has been made to ensure the accuracy of the Floor Plan contained here, measurements of the doors, windows, rooms and any other items are approximate and no responsibility is taken for any errors, omissions, or misstatement. The services, systems and appliances shown have not been tested and no guarantee as to the operability or efficiency can be given.



## Directions

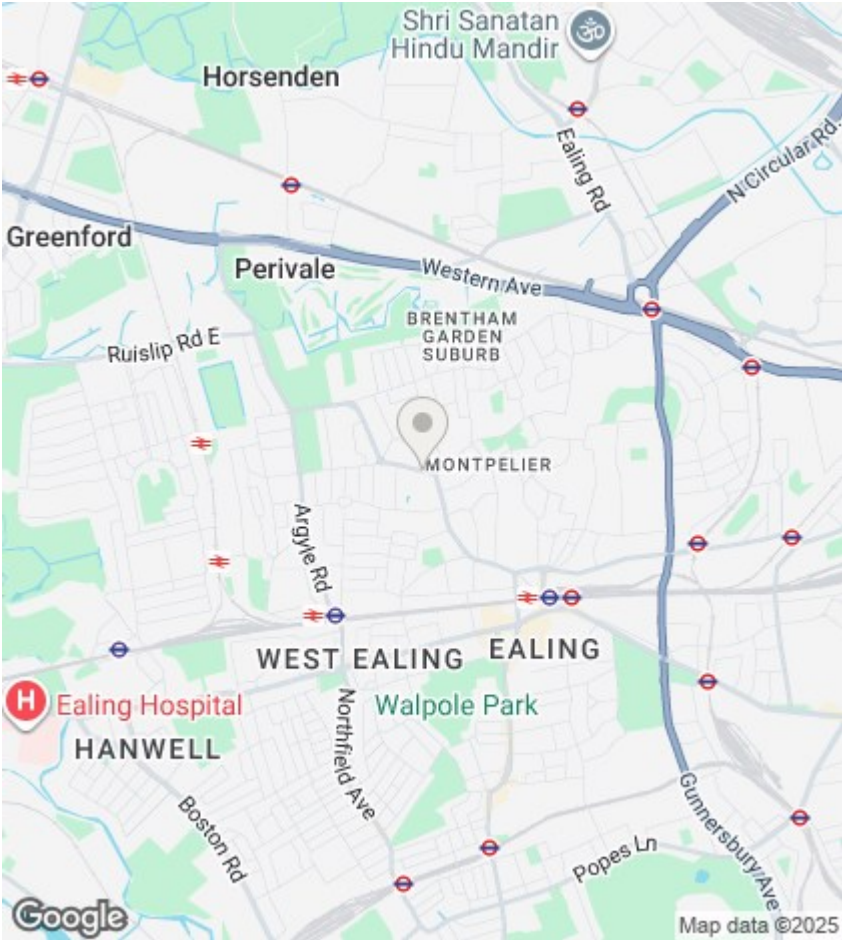

## Viewings

Viewings by arrangement only.  
Call 020 8840 7707 to make an appointment.

## EPC Rating:

E

Energy Efficiency Rating		
	Current	Potential
Very energy efficient - lower running costs		
(92 plus) A		
(81-91) B		
(69-80) C		73
(55-68) D		
(39-54) E	53	
(21-38) F		
(1-20) G		
Not energy efficient - higher running costs		
England & Wales	EU Directive 2002/91/EC	