



Ladywell Road, SE13

£350,000

A well presented first floor flat, set within a gated development offering privacy and security, moments from Ladywell Village. The property comprises two well sized bedrooms and a bright open plan kitchen/reception room, with generous proportions throughout.

Ladywell benefits from excellent transport connections into the City, with a range of nearby rail links. It is also well positioned for green space, with both Hilly Fields Park and Ladywell Fields close by, as well as the local shops, cafés, and amenities of Ladywell Village.

Features

- Two Double Bedrooms
- First Floor
- Close To Transport
- Gated Development
- Ladywell Village
- Chain Free

Ladywell Road,
London, SE13

First Floor

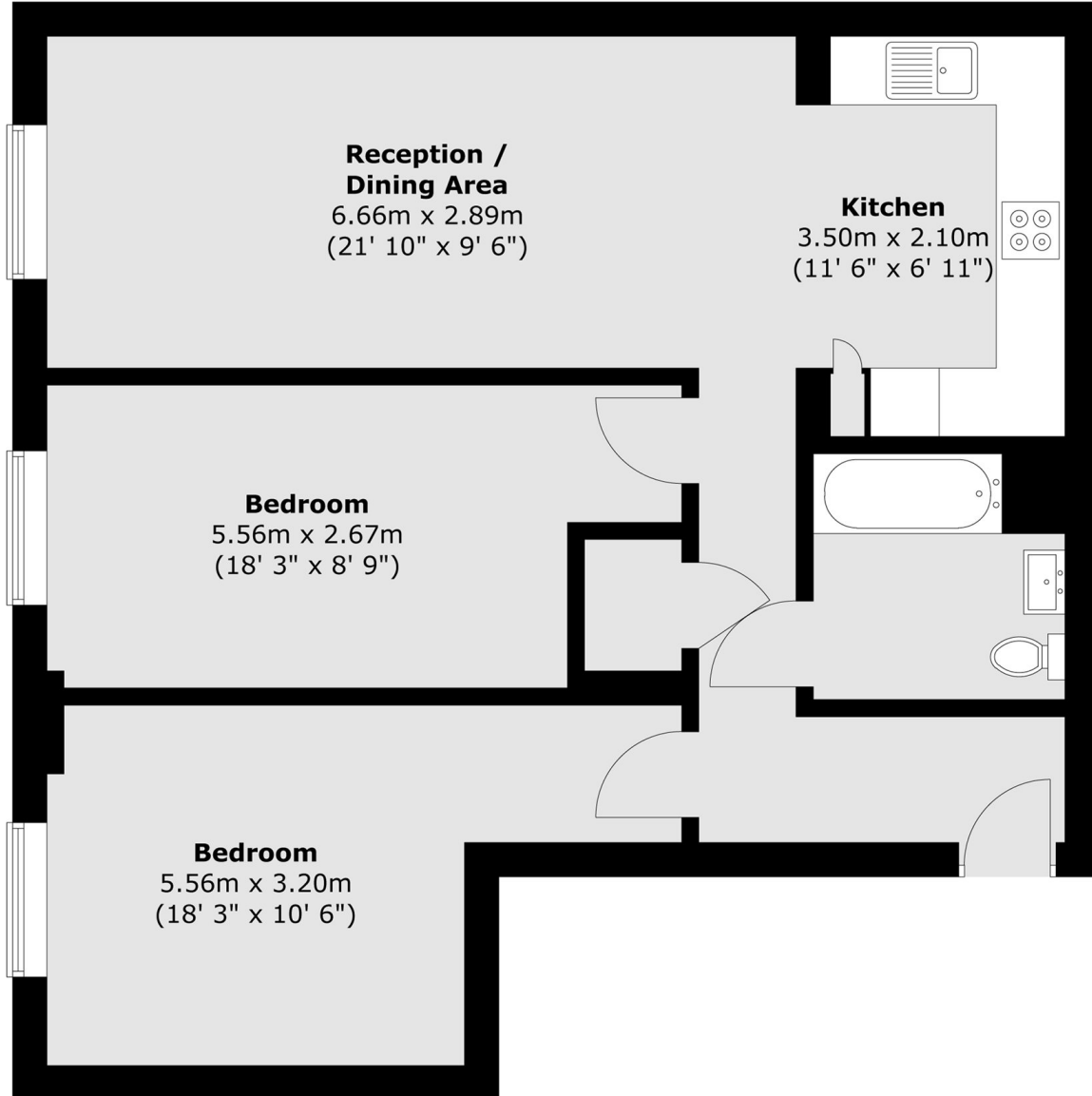

Total area (approx.) : 70 sq. m (753 sq. ft)