

JAMES EDWARD

Comprehensively Cared For



Digby Crescent

Hackney, London, N4 2HR

Offers In Excess Of £475,000



Digby Crescent



Description

Smart one bedroom apartment offering a large (565 sq ft) lateral space and communal garden, situated just a stone's throw from Clissold Park and Finsbury Park Station, positioned at the end of a quiet Cul de Sac street.

- First Floor Flat
- Period Conversion
- 565 sq ft
- Cul de Sac Street
- Share of Freehold
- Communal Garden
- Adjacent to Clissold Park and West Reservoir Centre
- Close to Arsenal and Finsbury Park Stations





Floor Plan

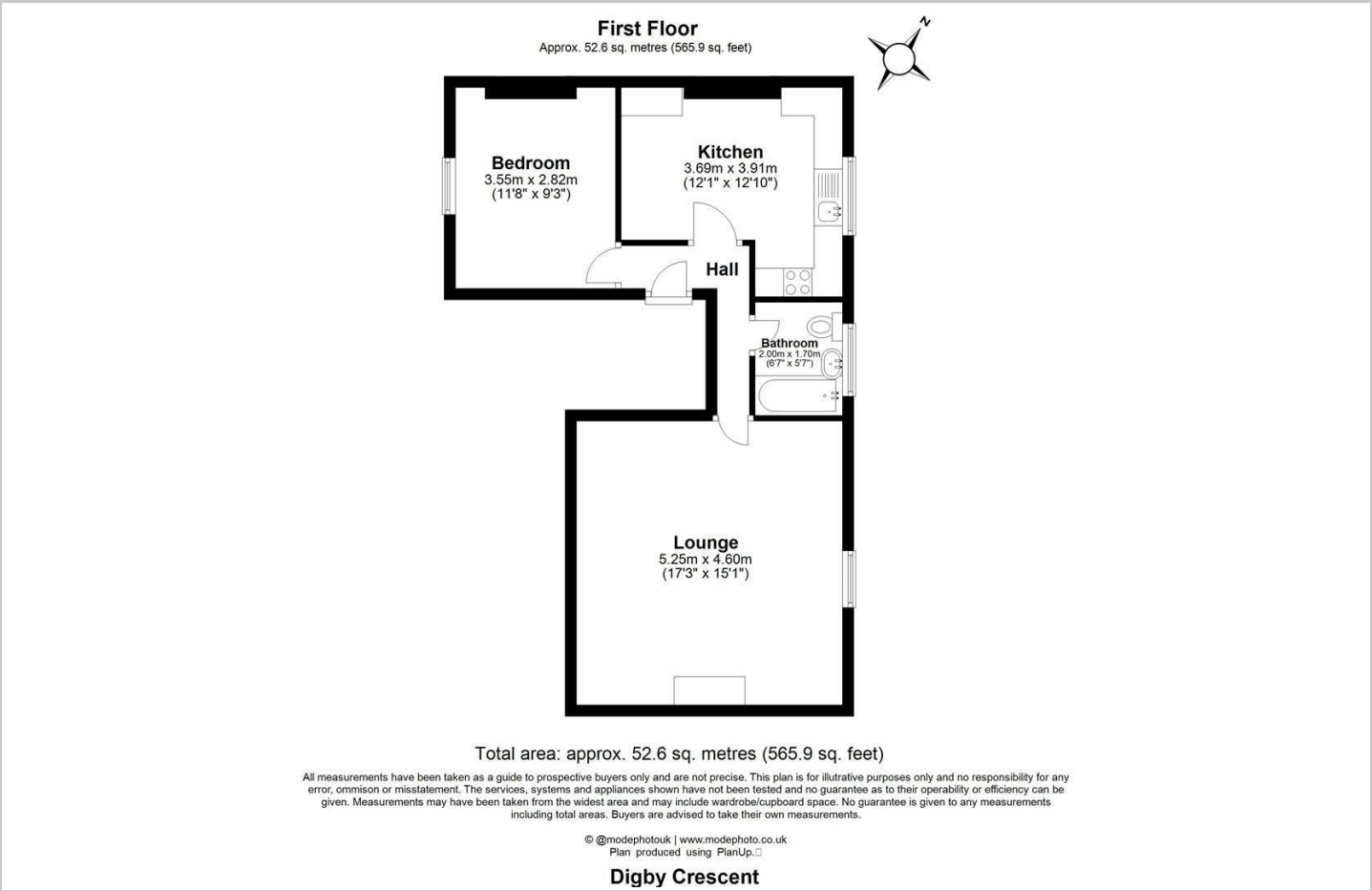

Area Map

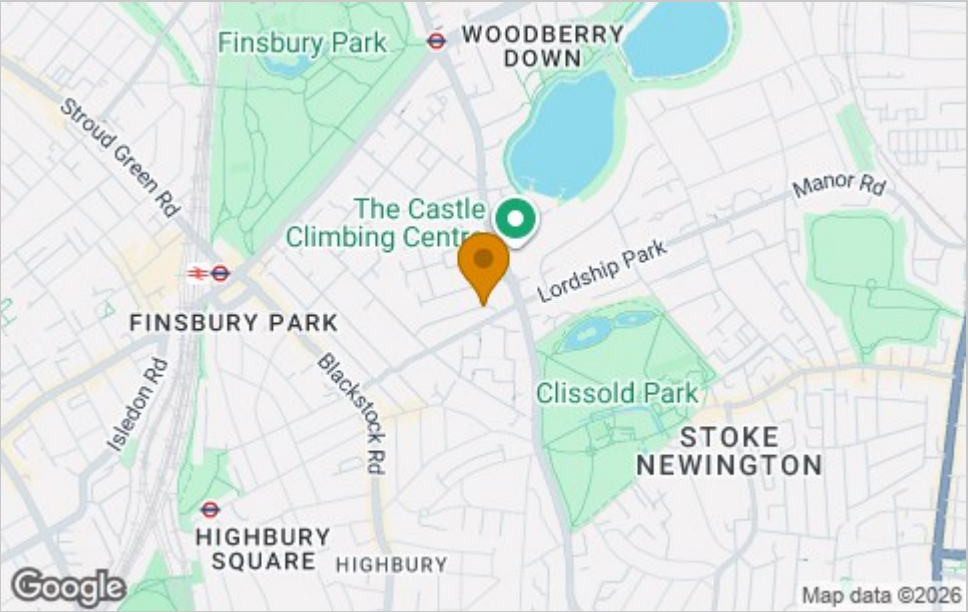

Viewing

Please contact our James Edward Office on 020 7952 5197 if you wish to arrange a viewing appointment for this property or require further information.

Energy Efficiency Graph

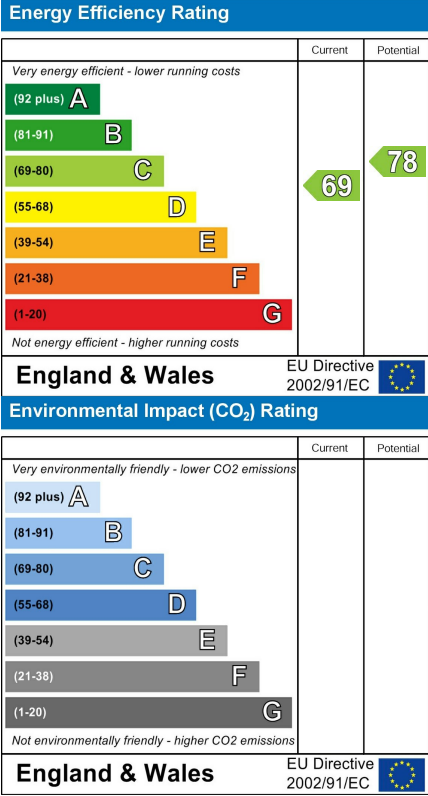

These particulars, whilst believed to be accurate are set out as a general outline only for guidance and do not constitute any part of an offer or contract. Intending purchasers should not rely on them as statements of representation of fact, but must satisfy themselves by inspection or otherwise as to their accuracy. No person in this firms employment has the authority to make or give any representation or warranty in respect of the property.