

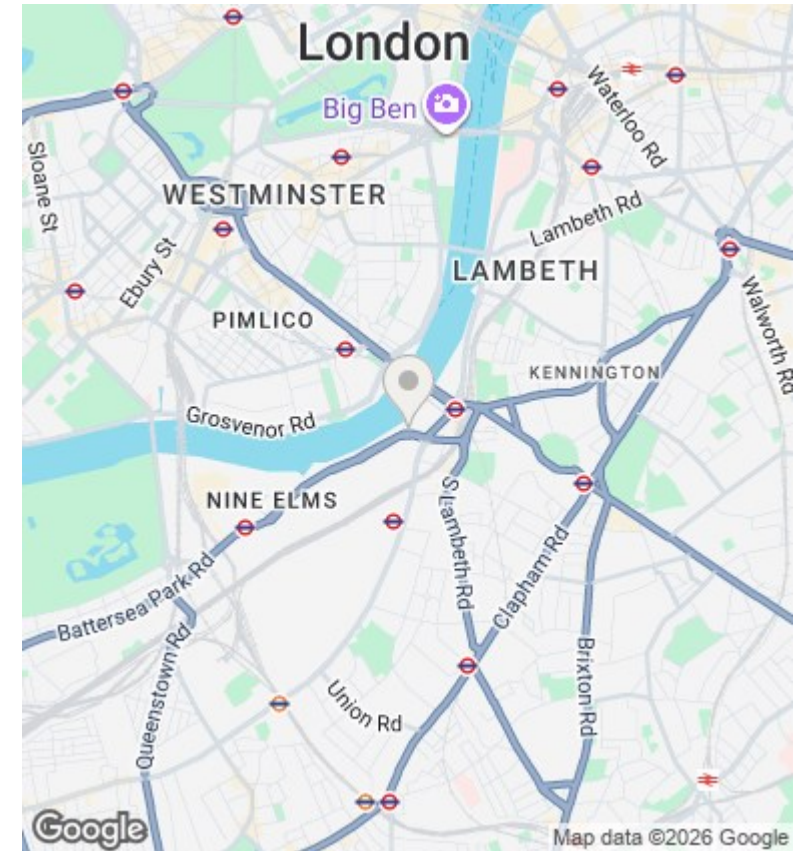

The Tower , St George Wharf, Vauxhall SW8 2DU

£3,600 Per Month

- 24 HOUR CONCIERGE
- GYM AND SPA
- SMART HOME SYSTEM
- RESIDENCE CINEMA
- VIDEO VIEWING AVAILABLE
- RIVERSIDE DEVELOPMENT
- ALLOCATED PARKING SPACE
- UNDER FLOOR HEATING AND AIR COOLING
- SWIMMING POOL OVERLOOKING RIVER
- MEETING ROOM/ DINING ROOM

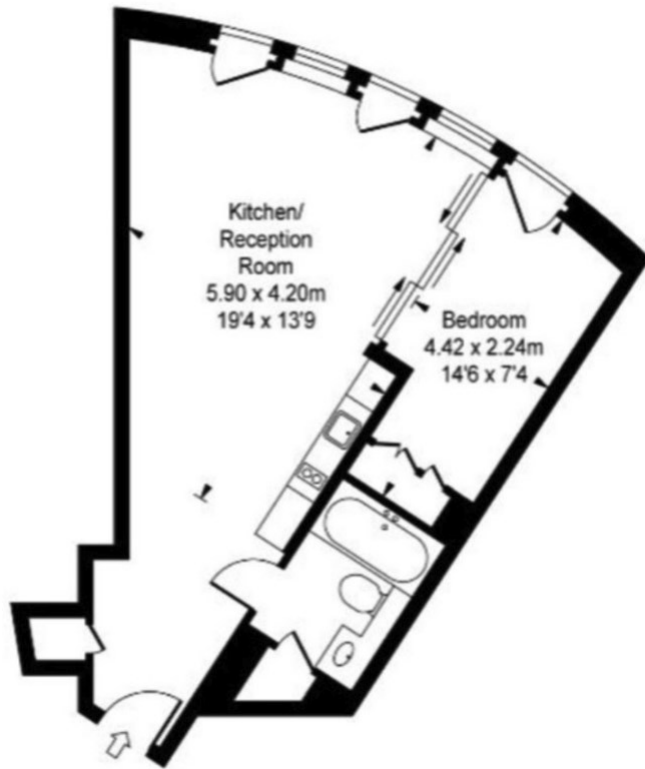

Viewings

Viewings by arrangement only.
Call 02077225022 to make an appointment.

Council Tax Band

F

EPC Rating:

B

Energy Efficiency Rating		Current	Potential
<i>Very energy efficient - lower running costs</i>			
(92 plus) A			
(81-91) B		83	83
(69-80) C			
(55-68) D			
(39-54) E			
(21-38) F			
(1-20) G			
<i>Not energy efficient - higher running costs</i>			
England & Wales		EU Directive 2002/91/EC	