



8 Broad Elms Lane, Ecclesall, Sheffield, S11 9RQ



# 8 Broad Elms Lane

## Ecclesall

Guide Price

# £600,000

Guide Price £600,000 to £625,000

A beautifully presented and deceptively spacious 3/4 bedroom bungalow, ideally located on the highly sought-after Broad Elms Lane. This wonderful home offers flexible accommodation throughout, attractive gardens and excellent access to local amenities and transport links.

You are welcomed into a bright and airy entrance hall which leads through to a generous living room filled with natural light, creating a warm and comfortable space to relax. A dining room connects easily to the well-proportioned kitchen, offering a practical and sociable layout that works perfectly for both everyday living and entertaining. A lovely sunroom provides an additional versatile living space, ideal for relaxing or enjoying views of the garden.

On the ground floor, there are two well-sized bedrooms both with ample storage, one with en-suite along with a family bathroom, allowing for convenient single-level living if desired. The home also benefits from excellent practicality, including a useful utility/laundry room, hallway storage and internal access to the garage.

Upstairs, the property continues to impress with two further bedrooms, one of which could also serve as a home office or additional reception room, alongside a WC and further bathroom facilities, offering superb flexibility for a variety of needs.

Externally, the property features a driveway providing off-street parking, an integral garage and beautifully maintained front and rear gardens that offer a sense of privacy and outdoor space to enjoy.

Perfectly positioned, the home is just a short walk from the vibrant amenities of Bents Green and Ecclesall Road, with a great selection of cafés, independent shops, a pharmacy, and a popular bakery nearby. The area is also well served by green spaces and excellent transport links into Sheffield city centre and beyond.

A rare opportunity to acquire a spacious and versatile home in one of the area's most desirable residential locations.

- Deceptively spacious 3/4 bedroom bungalow in a highly sought-after location
- Flexible layout ideal for families, downsizers, or home working
- Bright and airy living room filled with natural light
- Dining room and well-proportioned kitchen, perfect for entertaining
- Versatile sunroom offering additional living or relaxation space
- Two ground-floor bedrooms, including one with en-suite for convenient single-level living
- Two further upstairs rooms adaptable as bedrooms, office, or reception space
- Excellent practical features including utility room, ample storage, and integral garage access
- Beautifully maintained private front and rear gardens with driveway parking
- Prime position close to Bents Green, Ecclesall Road amenities, green spaces, and transport links







**Approximate total area<sup>(1)</sup>**  
 1617 ft<sup>2</sup>  
 150.2 m<sup>2</sup>

**Reduced headroom**  
 119 ft<sup>2</sup>  
 11 m<sup>2</sup>

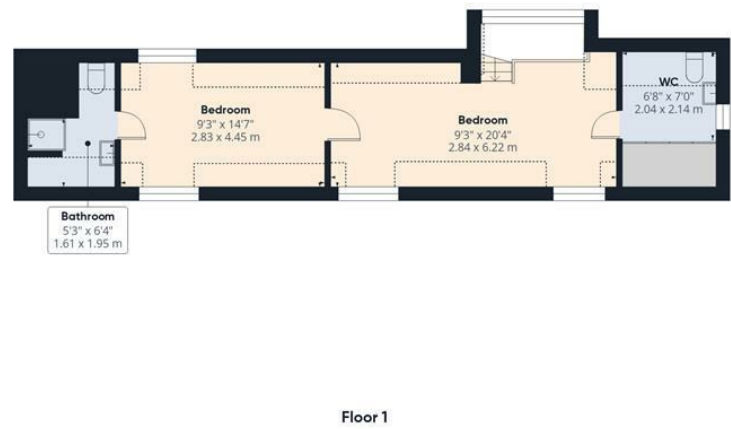

(1) Excluding balconies and terraces

Reduced headroom  
 ..... Below 5 ft/1.5 m

Calculations reference the RICS IPMS 3C standard. Measurements are approximate and not to scale. This floor plan is intended for illustration only.

**GIRAFFE360**



While we endeavour to make our sales particulars fair, accurate and reliable, they are only a general guide to the property and, accordingly, if there is any point, which is of particular importance to you, please contact the relevant office. The Agents have not tested any apparatus, equipment, fittings or services and so cannot verify they are in working order. The buyer is advised to obtain verification. Please note all the measurement details are approximate and should not be relied upon as exact. All plans, floor plans and maps are for guidance purposes only and are not to scale. Under no circumstances should they be relied upon as exact or for use in planning carpets and other such fixtures, fittings or furnishings. YOUR HOME IS AT RISK IF YOU DO NOT KEEP UP REPAYMENTS ON A MORTGAGE OR OTHER LOAN SECURED ON IT. 'A Life Assurance policy may be requested.' 'Written Quotations of credit terms available on request.'

**Banner Cross**  
 T: 0114 268 3241  
 E: [bannercross@saxtonmee.co.uk](mailto:bannercross@saxtonmee.co.uk)  
 www.saxtonmee.co.uk

**Hathersage**  
 T: 01433 650009  
 E: [hathersage@saxtonmee.co.uk](mailto:hathersage@saxtonmee.co.uk)

**Bakewell**  
 T: 01629 815307  
 E: [bakewell@saxtonmee.co.uk](mailto:bakewell@saxtonmee.co.uk)

**Matlock**  
 T: 01629 828250  
 E: [matlock@saxtonmee.co.uk](mailto:matlock@saxtonmee.co.uk)

