



Holland Park, W11

£4,000 Per calendar month

Dexters



Holland Park, W11

This exceptional two bedroom flat has been refurbished throughout and is ideally positioned within an immaculately maintained period villa located on the prestigious Holland Park.

This property is located on one of the most prestigious streets in Holland Park. The flat is close to Holland Park station and the Kyoto Gardens of Holland Park itself.

Features

- Two Bedroom Flat
- Newly Refurbished
- Wooden Floors
- End of Terrace
- Prestigious Neighbourhood
- Holland Park



Holland Park, London, W11

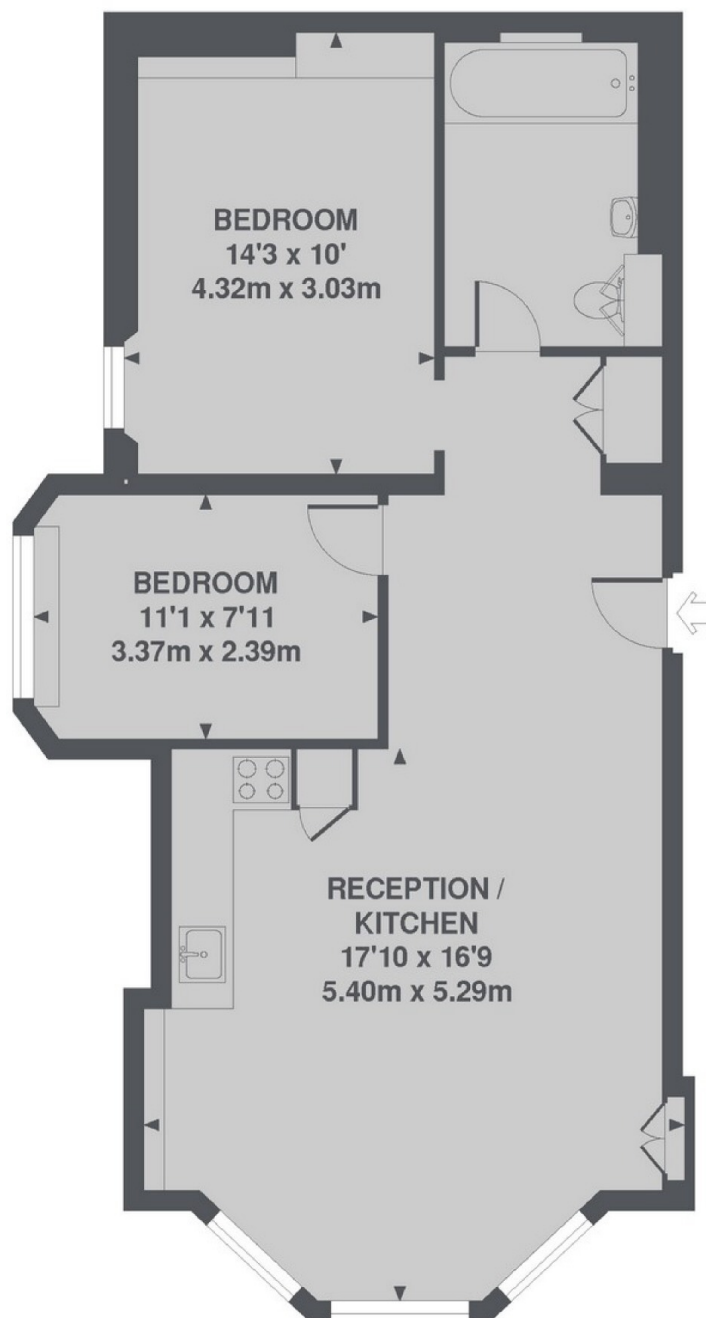

TOTAL APPROX. FLOOR AREA 681 SQ. FT. (63.3 SQ. M.)