



ENFYS ESTATES

Traditional values **behind modern thinking**

Bell Cottages, Penmaenmawr, LL34

£155,000

2 1 2





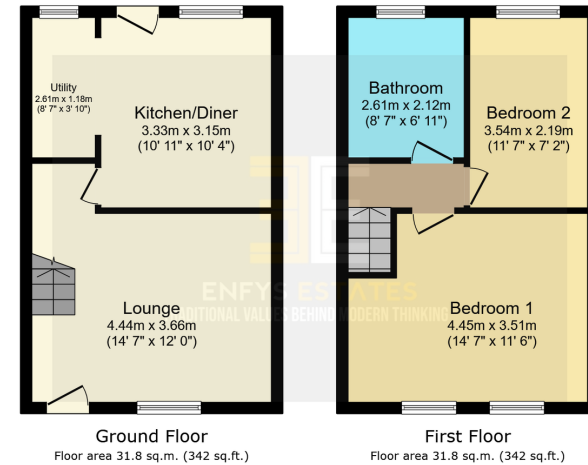

Total floor area: 63.6 sq.m. (685 sq.ft.)

This floor plan is for illustrative purposes only. It is not drawn to scale. Any measurements, floor areas (including any total floor area), openings and orientations are approximate. No details are guaranteed, they cannot be relied upon for any purpose and do not form any part of any agreement. No liability is taken for any error, omission or misstatement. A party must rely upon its own inspection(s). Powered by www.Propertybox.io

Delighted to bring to the market this immaculately presented two bedroom property which is full of charm and character throughout. Having been refurbished throughout to a lovely standard, the deceptively spacious accommodation would suit an array of buyers and needs to be viewed to be truly appreciated. Situated in the highly sought after coastal town of Penmaenmawr, being a few minutes walk away from the beach/promenade and railway station, and to the high street with a host of local amenities. Country walks with access to many public footpaths from its doorstep, there is no questioning why this location has something for everyone. Viewings are highly recommended to fully appreciate this spacious home and its location.

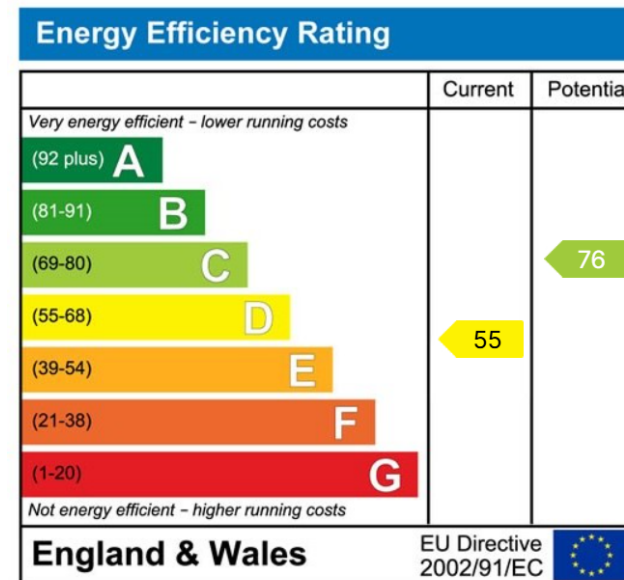

www.enfysestates.co.uk

14 Augusta Street, Llandudno, LL30 2AE

t. 01492 555 150 | e. hello@enfysestates.co.uk

rightmove

PRS Property Redress Scheme

★ Trustpilot



BOOK YOUR FREE VALUATION