



London Road, Brandon, IP27 0EW

Rent - £1,280 PCM Deposit - £1,476

London Road in the town of Brandon, this detached house with four well-proportioned bedrooms is ideal for families seeking comfort and convenience. Spanning an impressive 1,389 square feet, the home boasts a large open-plan kitchen and dining area.

The property is designed with practicality in mind, featuring off-road parking that accommodates up to four vehicles, along with a single garage for additional storage or secure parking.

- DETACHED HOUSE
- OFF-ROAD PARKING
- NEARBY TO LOCAL AMENITIES
- OPEN PLAN KITCHEN/DINER
- COUNCIL TAX BAND C
- SINGLE GARAGE
- CLOSE TO BASE
- LARGE REAR ENCLOSED GARDEN
- CLOAKROOM
- EPC C



Council Tax Band: C - EPC Rating: C 69

GROUND FLOOR
564 sq.ft. (52.4 sq.m.) approx.



1ST FLOOR
570 sq.ft. (53.0 sq.m.) approx.

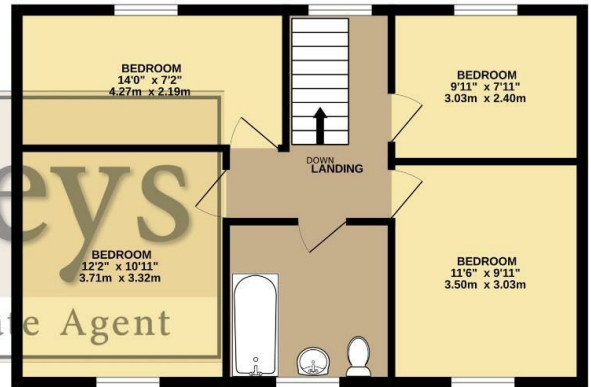

TOTAL FLOOR AREA : 1134 sq.ft. (105.3 sq.m.) approx.
Whilst every attempt has been made to ensure the accuracy of the floorplan contained here, measurements of doors, windows, rooms and any other items are approximate and no responsibility is taken for any error, omission or mis-statement. This plan is for illustrative purposes only and should be used as such by any prospective purchaser. The services, systems and appliances shown have not been tested and no guarantee as to their operability or efficiency can be given.
Made with Metropix ©2025

