





Woodside Park, Woodside, Luton, Bedfordshire, LU1 4LS

£172,500

 2  2  1



- Detached Park Home Bungalow
- Two Double Bedrooms
- Separate Lounge and Dining Room
- Ensuites To Both Bedrooms
- No Stamp Duty To Pay
- Popular Residential Park
- Spacious 45'x20' Design
- Kitchen with Utility Room
- Garage And Driveway(Rented From Park)
- Offered With No Onward Chain



REDUCED FOR A QUICK SALE! A two double bedroom detached park home bungalow located in The Grove on this sought after residential park close to Luton which is in need of some updating. This Tingdene built 45'x20' home offers spacious accommodation throughout and boasts an entrance hall with separate WC, a spacious lounge, separate dining room, a modern fitted kitchen as well as a utility room, two double bedrooms with the master bedroom having a walk-in wardrobe and an ensuite bathroom, a further an-suite shower room to the second bedroom, gardens to all sides of the home as well as a driveway to one side and a garage which is rented from the park.

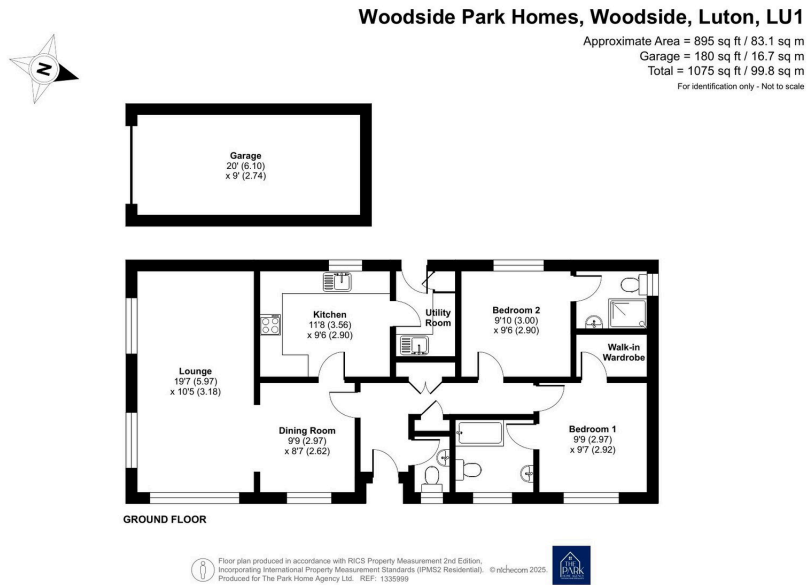

01793 230185
 sales@theparkhomeagency.co.uk

Agents Notes: All measurements are approximate and quoted in metric with imperial equivalents and for general guidance only and whilst every attempt has been made to ensure accuracy, they must not be relied on. The fixtures, fittings and appliances referred to have not been tested and therefore no guarantee can be given that they are in working order. Internal photographs are reproduced for general information and it must not be inferred that any item shown is included with the property. For a free valuation, contact the numbers listed on the brochure