



**burchell
edwards**

FOR SALE
01773 715 454
www.burchelledwards.com

Arthurs View
Ironville NOTTINGHAM



Arthurs View Ironville NOTTINGHAM NG16 5PS

for sale offers over
£180,000



Property Description

A two-bedroom semi-detached property situated in the popular residential location of Codnor Park with no upward chain!

Arthurs View is ideally located in close proximity to a wide range of local amenities including shops, schools, bus routes, and major road links. In brief the property comprises of an entrance porch, lounge leading into a fitted kitchen with access to the garden.

To the first floor, there is a landing leading to two double bedrooms and a family bathroom. To the front elevation of the property there is a driveway and a garage with lighting for that extra space!

Viewings are highly recommended to appreciate the accommodation on offer!

Porch

To the front elevation there is a porch area before entering the lounge. Comprising of a window and laminate flooring.

Lounge

UPVC double glazed window to the front elevation, wood laminate flooring with an electric fire and radiator. Access to the stairs to the first floor.

Kitchen

UPVC double glazed window to the rear elevation and UPVC door to the garden, with laminate flooring, radiator and combination boiler. Fitted wall and base units with sink and drainer, integrated cooker and stove, plumbing for washing machine and breakfast bar with units above.



Landing

Carpet flooring on the stairs and landing leading to;

Bedroom One

Comprising of carpet flooring, UPVC double glazed window to the front elevation, a radiator, integrated wardrobes and a storage cupboard over the stairs.

Bedroom Two

UPVC window to the rear of the property comprising of carpet flooring and a radiator.

Bathroom

UPVC frosted window and laminate flooring. Bath with shower over, W.C, tiled splashbacks, heated towel rail and extractor fan.

Front

Lawned front garden with driveway, with entrance to the garage.

Rear

Decked area to the rear, with a paved patio space and flower border.

Garage

Alarmed with lighting and power.







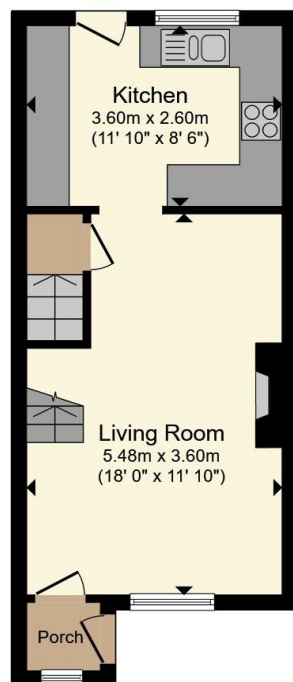

Ground Floor

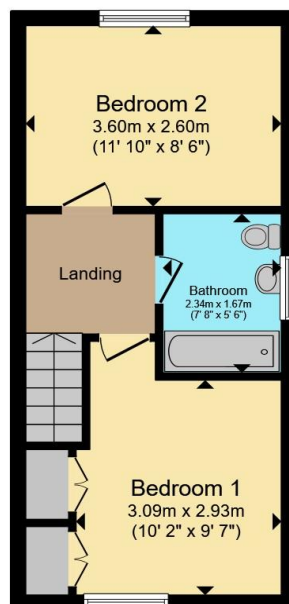

First Floor

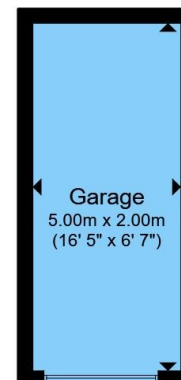

Garage

Total floor area 70.5 m² (759 sq.ft.) approx

This floor plan is for illustrative purposes only. It is not drawn to scale. Any measurements, floor areas (including any total floor area), openings and orientation are approximate. No details are guaranteed, they cannot be relied upon for any purpose and they do not form part of any agreement. No liability is taken for any error, omission or misstatement. A party must rely upon its own inspection(s). Powered by www.propertybox.io



To view this property please contact Burchell Edwards on

T 01773 715454
E eastwood@burchelledwards.co.uk

134 Nottingham Road Eastwood
NOTTINGHAM NG16 3GD

EPC Rating: C Council Tax
Band: B

Tenure: Freehold

view this property online burchelledwards.co.uk/Property/EWD207469



1. MONEY LAUNDERING REGULATIONS Intending purchasers will be asked to produce identification documentation at a later stage and we would ask for your co-operation in order that there will be no delay in agreeing the sale. 2. These particulars do not constitute part or all of an offer or contract. 3. The measurements indicated are supplied for guidance only and as such must be considered incorrect. Potential buyers are advised to recheck measurements before committing to any expense. 4. We have not tested any apparatus, equipment, fixtures, fittings or services and it is in the buyers interest to check the working condition of any appliances.

Burchell Edwards is a trading name of Connells Residential which is registered in England and Wales under company number 1489613, Registered Office is Cumbria House, 16-20 Hockliffe Street, Leighton Buzzard, Bedfordshire, LU7 1GN. VAT Registration Number is 500 2481 05.

See all our properties at www.burchelledwards.co.uk | www.rightmove.co.uk | www.zoopla.co.uk

Property Ref: EWD207469 - 0005