



## Surrey Row, SE1

£2,500 Per week

ALL BILLS INCLUDED. A newly decorated one bedroom apartment with a mezzanine to rent with its own front door in a private gated mews development.

Surrey Row is conveniently located a short walk from Southwark & London Bridge Stations, with the popular Borough Market & The Cut both close by.

### Features

ALL BILLS INCLUDED  
One Bedroom  
One Bathroom  
Mezzanine  
Newly Decorated  
Private Gated Mews

# Surrey Row, London, SE1

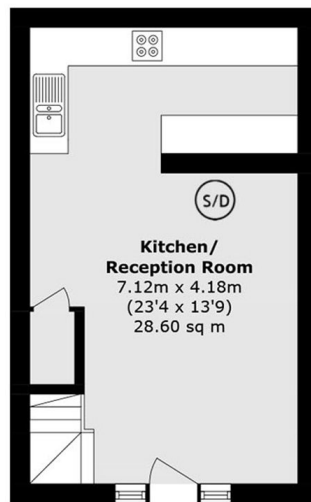

**Ground Floor Flat**

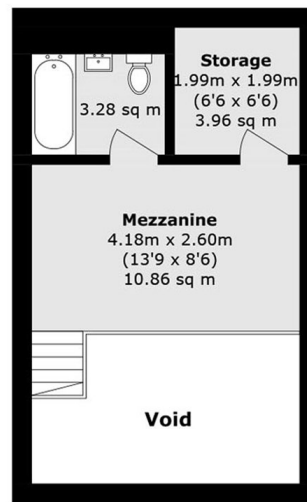

**Mezzanine**

Total area (approx.): 49.5 sq. m (532.8 sq. ft)  
(Excluding Void)