



66 FLAX BOURTON ROAD
FAILAND
BS8 3UN



66 FLAX BOURTON ROAD

FAILAND BS8 3UN

ACCOMMODATION

Please see floor plan for measurements

GROUND FLOOR

A welcoming entrance hall sets the tone for the home, leading into an impressive principal lounge where a striking wood-burning stove forms a charming focal point. Generous proportions and doors opening onto the rear patio create a warm and inviting space for both relaxed evenings and entertaining. Complementing this is a stunning additional reception room, flooded with natural light from Velux windows and full-width bi-fold doors that open seamlessly onto the garden, perfectly blending indoor and outdoor living.

The heart of the home is the stylish open-plan kitchen and dining room, designed with sociable living in mind. Beautifully appointed with high-gloss cabinetry, granite work surfaces and a central island, the space is bathed in natural light from an array of windows and skylights and also benefits from under floor heating. A well-appointed utility room provides further practicality while maintaining the sleek aesthetic of the kitchen.

The ground floor also offers two generously sized double bedrooms along with an elegant family bathroom, featuring a classic roll-top bath alongside a separate walk-in shower, combining timeless style with modern convenience.

FIRST FLOOR

The first floor provides two further spacious double bedrooms, each benefitting from its own en-suite shower room, creating ideal private retreats for family members or visiting guests.

GARAGE & GARDENS







Externally, the property continues to impress with an integrated garage, driveway parking for up to five vehicles and a beautifully proportioned rear garden.

The larger than average garden is predominantly laid to lawn with a generous patio terrace ideal for outdoor dining and entertaining, framed by established trees and enclosed by fencing and hedgerow to provide a wonderful sense of privacy and tranquillity.

Offering an enviable combination of countryside charm, contemporary finishes and excellent connectivity to Bristol, this outstanding home presents a rare opportunity to acquire a truly special village property.

ADDITIONAL INFORMATION

EPC: C | Freehold | Council Tax Band C





66 FLAX BOURTON ROAD

FAILAND
BS8 3UN

Flax Bourton Road
Failand



Approximate Gross Internal Area
Ground Floor = 1743.0 Sq Ft / 161.9 Sq M
First Floor = 524.2 Sq Ft / 48.7 Sq M
Total = 2267.2 Sq Ft / 210.6 Sq M

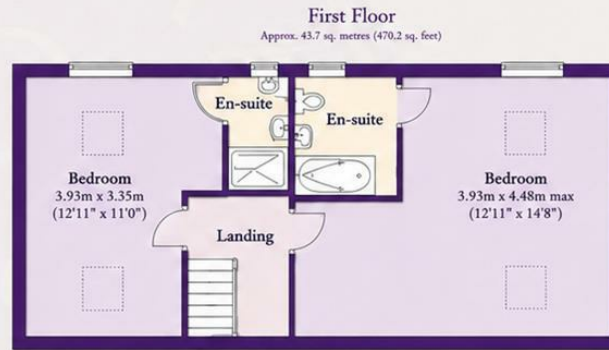

FOR ILLUSTRATIVE PURPOSES ONLY - NOT TO SCALE
The position & size of doors, windows, appliances and other features are approximate only.

www.goodmanlilley.co.uk

FLOORPLAN

FOR GUIDANCE ONLY, NOT TO SCALE AND NOT TO BE RELIED UPON AS A STATEMENT OF FACT.

TOTAL SQUARE FOOTAGE
2267.20 SQ FT

COUNCIL TAX BAND : C

RECEPTION ROOM : 2

BEDROOMS: 4

BATHROOMS : 3

FREEHOLD





GOODMAN & LILLEY

HENLEAZE

156 Henleaze Road
Henleaze BS9 4NB
henleaze@goodmanlilley.co.uk

0117 213 0777

PORTISHEAD

36 High Street
Portishead BS20 6EN
sales@goodmanlilley.co.uk

01275 430 440

SHIREHAMPTON

9 High Street
Shirehampton BS11 0DT
shire@goodmanlilley.co.uk

0117 213 0333

LETTINGS

lettings@goodmanlilley.co.uk

01275 299 010

0117 213 0101

LAND & NEW HOMES

156 Henleaze Road
Henleaze BS9 4NB
LNH@goodmanlilley.co.uk

0117 213 0151

CLEVEDON

28 Hill Road
Clevedon, BS21 7PH
clevedon@goodmanlilley.co.uk

01275 403 660

These particulars are for general guidance only. They do not form or constitute any part of an offer or contract. Goodman & Lilley has not carried out structural surveys of the property. The services, appliances or specific fittings mentioned in these details have not been tested. Every attempt is made to ensure accuracy, however all photographs, measurements, floor plans and distances are for illustrative purposes only. They must not be relied upon when purchasing carpets and or other fixtures & fittings. Lease details, service charges and ground rents are given as a guide only. They should be checked and confirmed by a licensed solicitor prior to exchange of contracts. The copyright of all details, photographs and floor plans remain exclusive to Goodman & Lilley.



rightmove

Zoopa