

Old Forge Drive, West Haddon, Northampton, NN6 7ET

Guide Price £315,000

3 1 1



Louise Owen is thrilled to bring to the market this absolutely superbly presented three-bedroom end terrace home, situated in the highly desirable village of West Haddon.

Occupying a quiet position within the popular and very friendly development of Old Forge Drive, the property has been thoughtfully updated and meticulously maintained by the current owners, including the installation of a newly fitted kitchen and contemporary family bathroom, creating a stylish and move-in-ready home ideal for modern family living.

One not to be missed.

LOUISE OWEN



@louise.owen@exp.uk.com

 louiseowen.exp.uk.com

 07774 122 959

Quote Property Ref LO 0765

Key Features

- Superbly presented three-bedroom end terrace South facing rear garden home
- Ideal for first-time buyers, couples or young families
- Stunning newly fitted family bathroom
- Three well-proportioned bedrooms
- Two parking spaces to the rear with garden access
- Quiet and highly sought-after village location
- New contemporary kitchen/dining room
- Close to Long Buckby railway station and excellent road links
- Gas central heating with a regularly serviced boiler

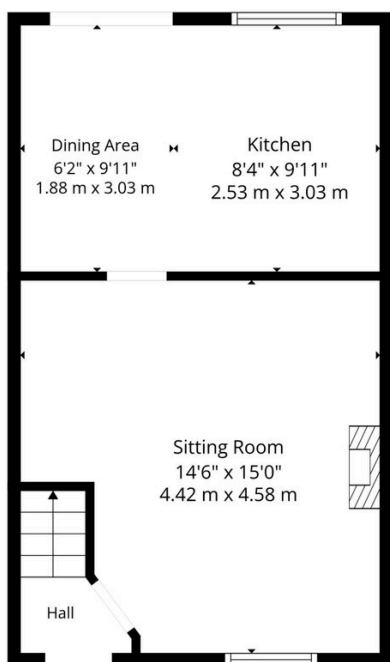

Ground Floor

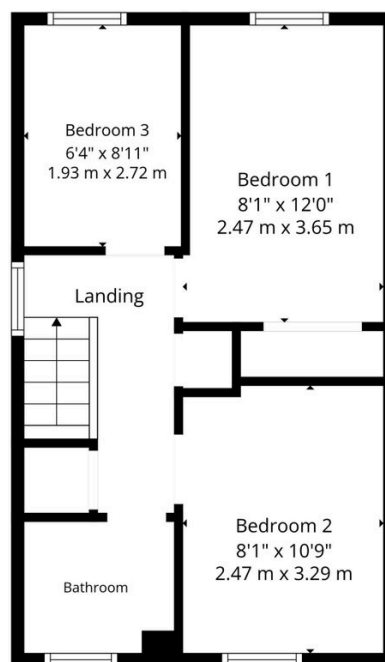

1st Floor

Total: 734 sq. Ft, 68 m2
 Ground Floor: 367 sq. Ft, 34 M2, 1st Floor: 367 sq. Ft, 34 m2
 Excluded Areas: Walls: 61 sq. Ft, 6 m2

Floor Plan Created By Harper & Reid. Measurements Deemed Highly Reliable But Not Guaranteed

