



Roundhill Grove,

Price £375,000

FOR SALE



- No Onwards Chain
- Semi-Detached
- Open Plan Kitchen/ Diner
- Three Bedrooms
- Good-Sized Garden
- Great Transport Links To City Centre

THE PROPERTY

Whether you're looking to settle down or secure an investment property, this well-presented three-bedroom semi-detached home in Bath offers a great opportunity. Offered to the market with no onwards chain.

Approx Gross Internal Area
87 sq m / 933 sq ft

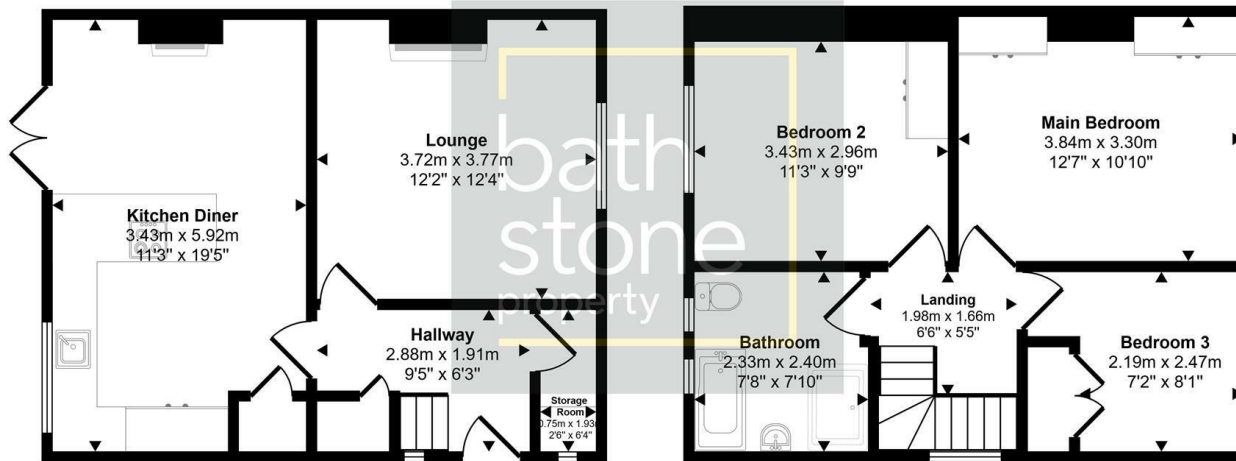

This floorplan is only for illustrative purposes and is not to scale. Measurements of rooms, doors, windows, and any items are approximate and no responsibility is taken for any error, omission or mis-statement. Icons of items such as bathroom suites are representations only and may not look like the real items. Made with Made Snappy 360.



Energy Efficiency Rating

	Current	Potential
Very energy efficient - lower running costs		
(92 plus) A		
(81-91) B		
(69-80) C		74
(55-68) D	61	
(39-54) E		
(21-38) F		
(1-20) G		
Not energy efficient - higher running costs		
England & Wales	EU Directive 2002/91/EC	