



## WOODHILL, SE18

£1,500 per month

A one bedroom top floor apartment situated within a converted Victorian property.

Top floor apartment  
One double bedroom  
Living/dining room

Separate kitchen  
Off street parking  
Energy rating: c

# STEP INSIDE WOODHILL

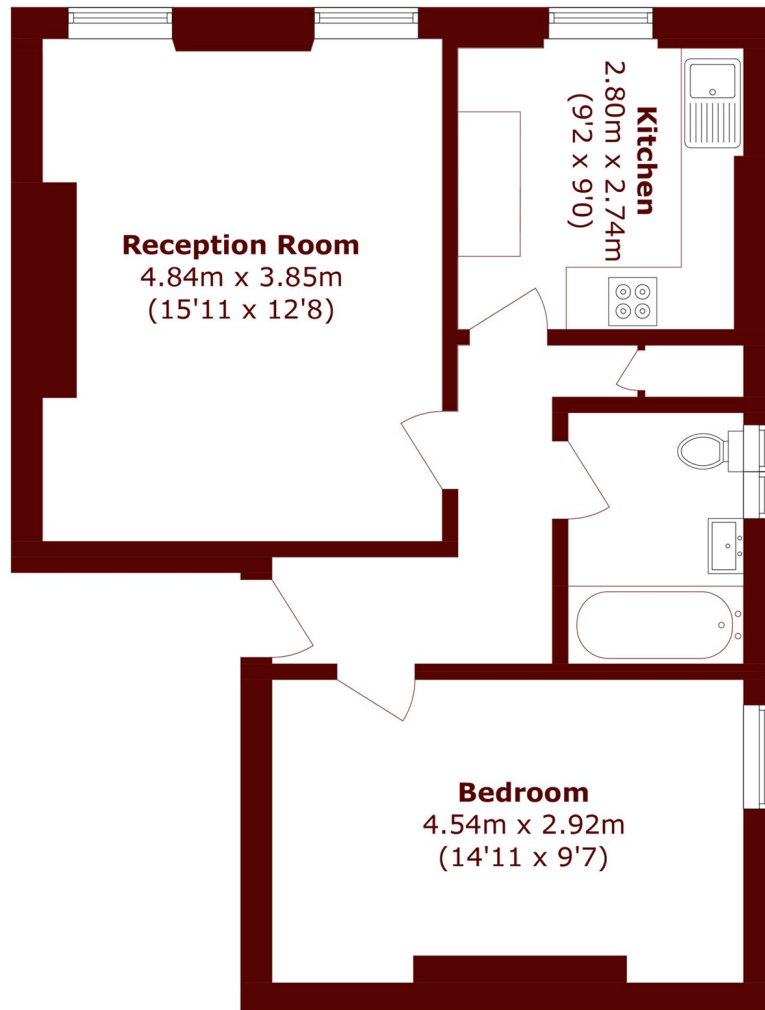

Total Area (approx.): 51.9 sq. m (558.6 sq. ft)

**Charlton**  
020 8378 5450

Energy Rating: C We aim to make our particulars both accurate and reliable. However, they are not guaranteed; nor do they form part of an offer or contract. If you require clarification on any points then please contact us, especially if you're traveling some distance to view. Please note that appliances and heating systems have not been tested and therefore no warranties can be given as to their good working order

**MARSH &  
PARSONS**