



244 Devizes Road, Salisbury, Wiltshire, SP2 7NB

£1,100 PCM

About The Property

A spacious two bedroom, unfurnished semi detached house with enclosed gardens and far reaching views over the countryside, with transport links and situated within a walkable distance to the city centre and railway station.

Accommodation comprises:

Entrance hall. Living room. Kitchen with views over the garden and space for a washing machine and cooker. Utility area/store room with space for a fridge/freezer. Rear hall with under stairs storage and ground floor cloakroom.

Upstairs, bedroom one, double with fitted cupboard. Bedroom two, double. Spacious bathroom with bath and thermostatic shower over.

Outside; small front garden with gate to side and access to large enclosed garden with patio area, lawn and gate to a lower area with storage shed.

The property benefits from gas central heating and double glazing.

- Situated in a popular location within walking distance to the city centre.
- Lounge/Diner.
- Kitchen with utility/store room.
- Ground floor cloakroom.
- Two double bedrooms.
- Spacious bathroom with bath and shower over.
- Large enclosed garden with far reaching views.
- Storage shed
- Gas central heating and double glazing.
- EPC rating band C

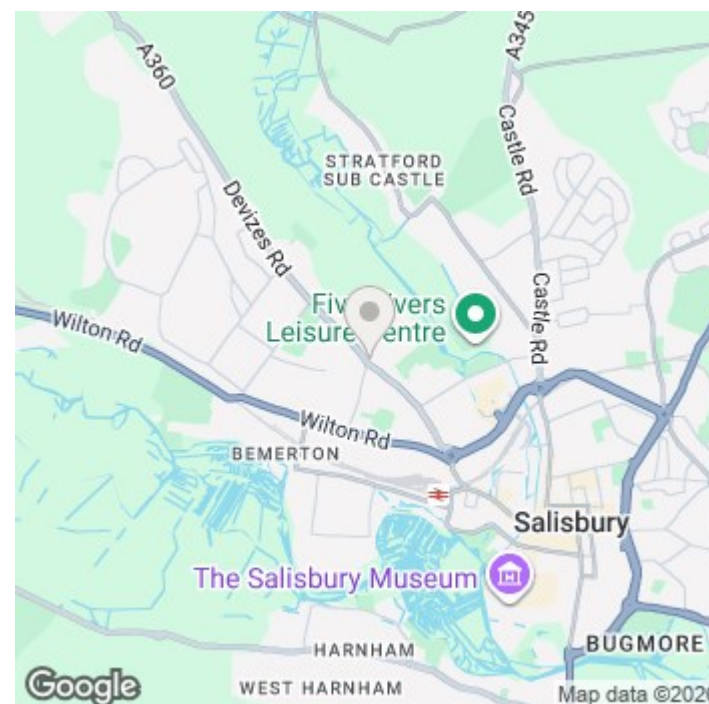



Ground Floor

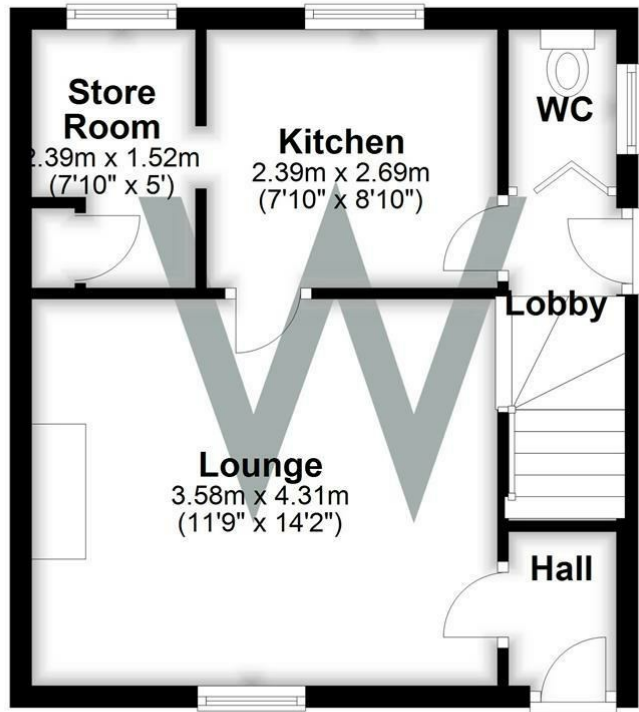

First Floor

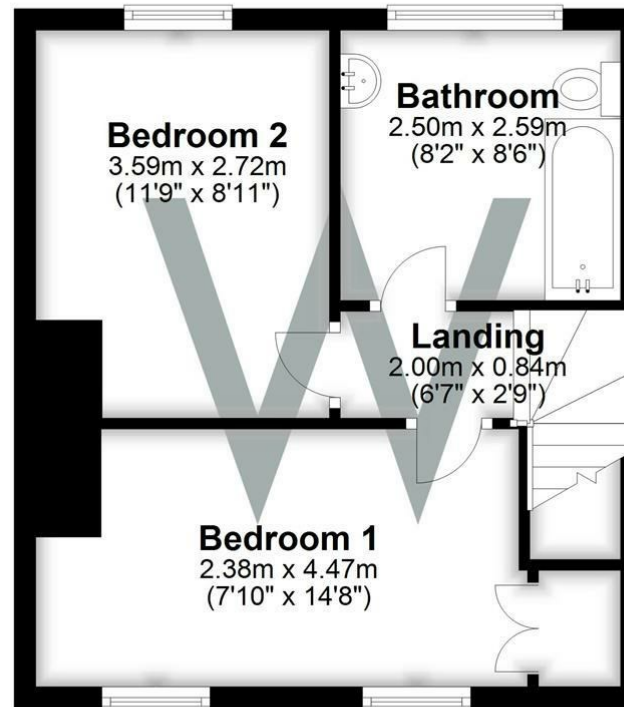

Total area: approx. 65.7 sq. metres (707.3 sq. feet)

Further Information

Let available date: 13th February 2026 NB: This date is provisional and will only be confirmed once referencing has been successfully completed.

Property type: House - Semi-Detached

Furnish type: Unfurnished

Deposit: £1,265

Local authority: Wiltshire

Council Tax: Band C

Energy Efficiency Rating

	Current	Potential
Very energy efficient - lower running costs		
(92 plus) A		
(81-91) B		86
(69-80) C	71	
(55-68) D		
(39-54) E		
(21-38) F		
(1-20) G		
Not energy efficient - higher running costs		
England & Wales	EU Directive 2002/91/EC	