



15 Magister Road

Bowerhill, Melksham, SN12 6FD

Guide Price £215,000

Welcome to Magister Road, Melksham. A two bedroom end of terrace home with a single garage situated in the village of Bowerhill. Magister Road is named after the Magister M.14 training aircraft.

The ground floor accommodation comprises entrance hall, kitchen, living room and conservatory. The first floor accommodation comprises landing, a double bedroom to the rear of the property, a single bedroom to the front of the property and bathroom with toilet, sink, bath and shower over the bath.

The property further benefits from gas central heating, double glazing, enclosed gravelled garden, single garage in a block with up and over door to the front, with further parking in front of the garage.

Room measurements are approx;

Entrance hall: 2.6m x 1.09m

Kitchen: 2.6m x 2.43m

Lounge: 4.75m x 3.63m

Conservatory: 2.35m x 2.3m

Bedroom one: 3.82m x 3.63m

Bedroom two: 3.54m x 1.75m

Bathroom: 2.6m x 1.77m (inc airing cupboard)

- Newly refurbished property
- Garage and parking
- Enclosed rear garden
- Conservatory
- Gas central heating & UPVC double glazing

Viewing

Please contact our Blueleaf Property Office on 01225 839050 if you wish to arrange a viewing appointment for this property or require further information.



Floor Plan

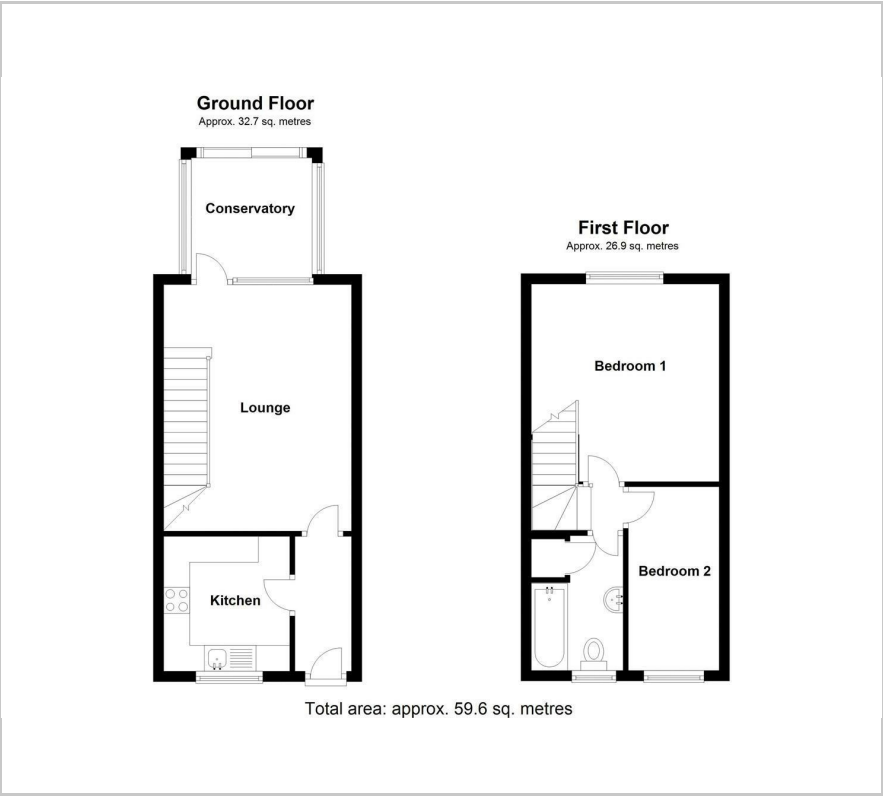

Area Map



Energy Efficiency Graph

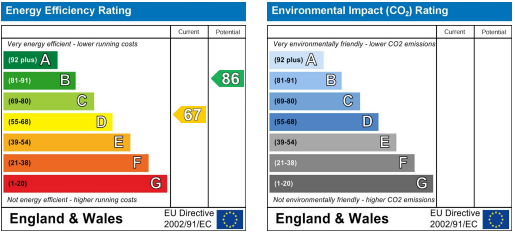

These particulars, whilst believed to be accurate are set out as a general outline only for guidance and do not constitute any part of an offer or contract. Intending purchasers should not rely on them as statements of representation of fact, but must satisfy themselves by inspection or otherwise as to their accuracy. No person in this firms employment has the authority to make or give any representation or warranty in respect of the property.