

Bisgood Cottages  
Somerset Bridge  
Bridgwater  
TA6 6LP



  
**JOSEPH CASSON**  
the estate agency your home deserves





£125,000

- CASH BUYERS ONLY
- Terraced Cottage
  - Three Bedrooms
- Lounge/Diner & Conservatory
  - Kitchen
  - Downstairs WC
  - Upstairs Bathroom
- Front & Rear Gardens
- Extensive Modernisation Required
- No Onward Chain

CASH BUYERS ONLY. Discover this delightful three-bedroom cottage, offered with no onward chain.

Tucked away in a private location near the River Parrett, just outside Bridgwater, it presents a unique opportunity.

With significant refurbishment needed, you can transform this gem into your dream home!

## ACCOMMODATION

This property briefly comprises: entrance hallway, kitchen, lounge/diner, conservatory, and WC to the ground floor, with three bedrooms and a wet room upstairs. Outside, there is a front garden offering the option of parking and an overground rear garden of very generous proportions.

## LOCATION

Hidden away on the southern fringes of Bridgwater, this property is accessed via the track which runs past the Boat & Anchor Inn or via a restricted height tunnel (1.6m (5'6")) off Squibbers Way, providing excellent access to the M5 at J24 and the towns of Bridgwater and North Petherton.

## ADDITIONAL INFORMATION

Tenure: Freehold

Estate/Management Charge: None

EPC Rating: TBC

Council Tax Band: B

## UTILITIES

Water supply: Mains

Sewerage: Private Drainage - Shared with a neighbouring property

Electricity Supply: Mains

Mains Gas Supply: No

Central Heating: None - Some Electric Heating

Significant refurbishment required, meaning a mortgage will not be currently available on this property



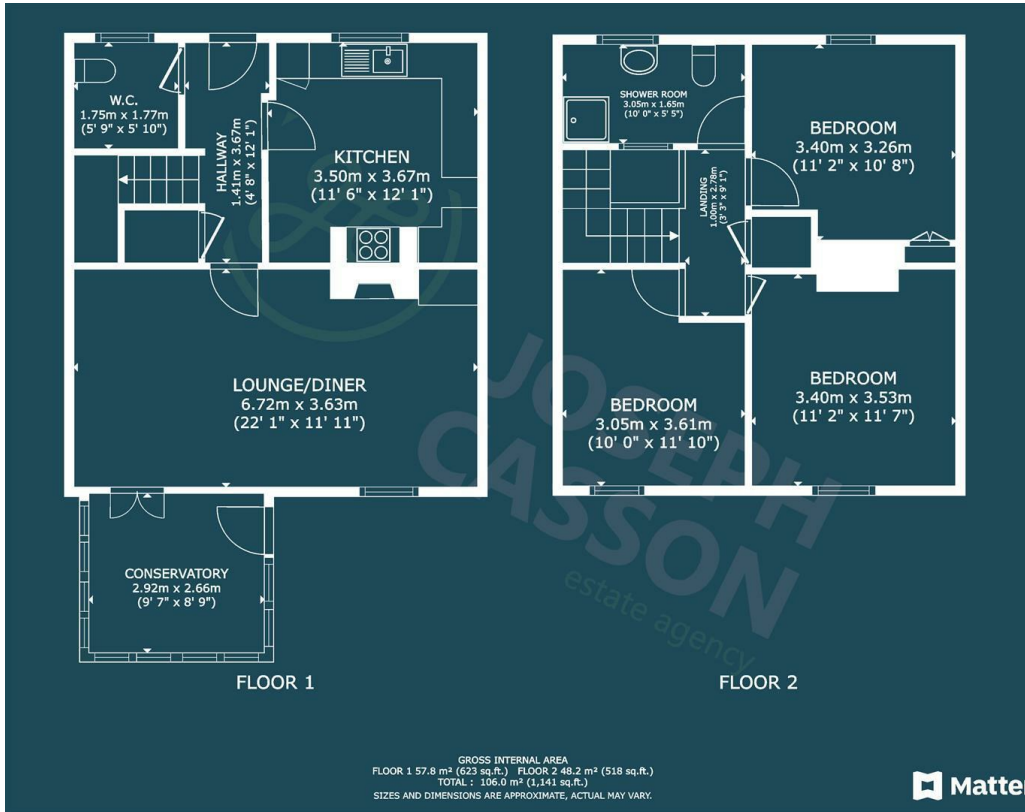

## FLOODING

No Flooding in the last 5 years. Flood Information: [flood-map-for-planning.service.gov.uk/location](https://flood-map-for-planning.service.gov.uk/location)

## BROADBAND & MOBILE COVERAGE

For an indication of specific speeds and supply or coverage in the area, we recommend that potential buyers use the Ofcom checkers below:

[checker.ofcom.org.uk/en-gb/mobile-coverage](https://checker.ofcom.org.uk/en-gb/mobile-coverage)

[checker.ofcom.org.uk/en-gb/broadband-coverage](https://checker.ofcom.org.uk/en-gb/broadband-coverage)

## Council Tax Band

B

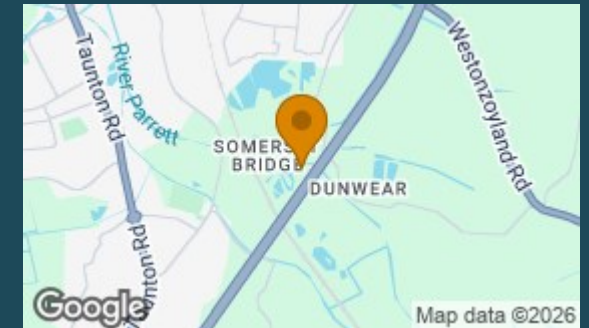
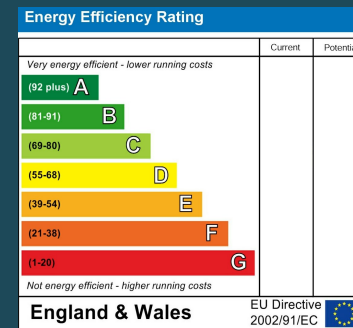

**Agents Note:** Whilst every care has been taken to prepare these particulars, they are for guidance purposes only. All measurements are approximate and are for general guidance purposes only and whilst every care has been taken to ensure their accuracy, they should not be relied upon and potential buyers/tenants are advised to recheck the measurements

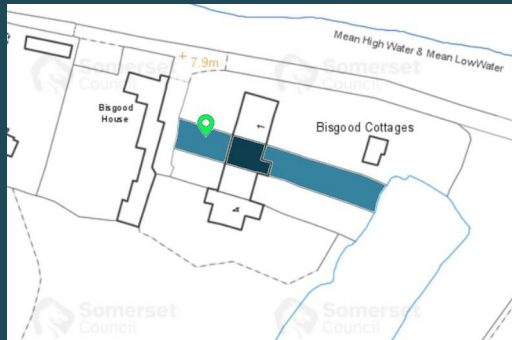

Joseph Casson Estate Agency -  
Bridgwater  
1 Friarn Lawn  
Bridgwater  
Somerset  
TA6 3LL

Contact  
01278258005  
office@josephcasson.co.uk  
www.josephcasson.co.uk



**JOSEPH CASSON**  
the estate agency your home deserves