

CHARMILL

RESIDENTIAL



St Mary's Terrace, Little Venice W2

£808



St. Marys Terrace



Description

A superb two bedroom apartment in the beautiful location of Little Venice. This stucco fronted property comprises an open plan kitchen/reception room with a breakfast bar. A principal bedroom with an en-suite bathroom and access to a garden/patio area, a further bedroom and a family shower room all finished to an excellent standard. Also there are two storage areas and the front of the property. St. Mary's Terrace is located moments from the many shops, cafes and restaurants of both Clifton Road and Edgware Road. Just 0.5 miles away is access to a number of transport links such as Edgware Road Underground station (Bakerloo, Hammersmith & City, Circle, District lines) and Paddington station offering Circle, District, Bakerloo and Hammersmith & City lines together with National Rail services and the Heathrow Express providing access to Heathrow Airport in 15 minutes.

- Two bedrooms
- En-suite bathroom
- Private garden/patio
- Open plan kitchen/reception room
- Family shower room
- Storage space





Floor Plan

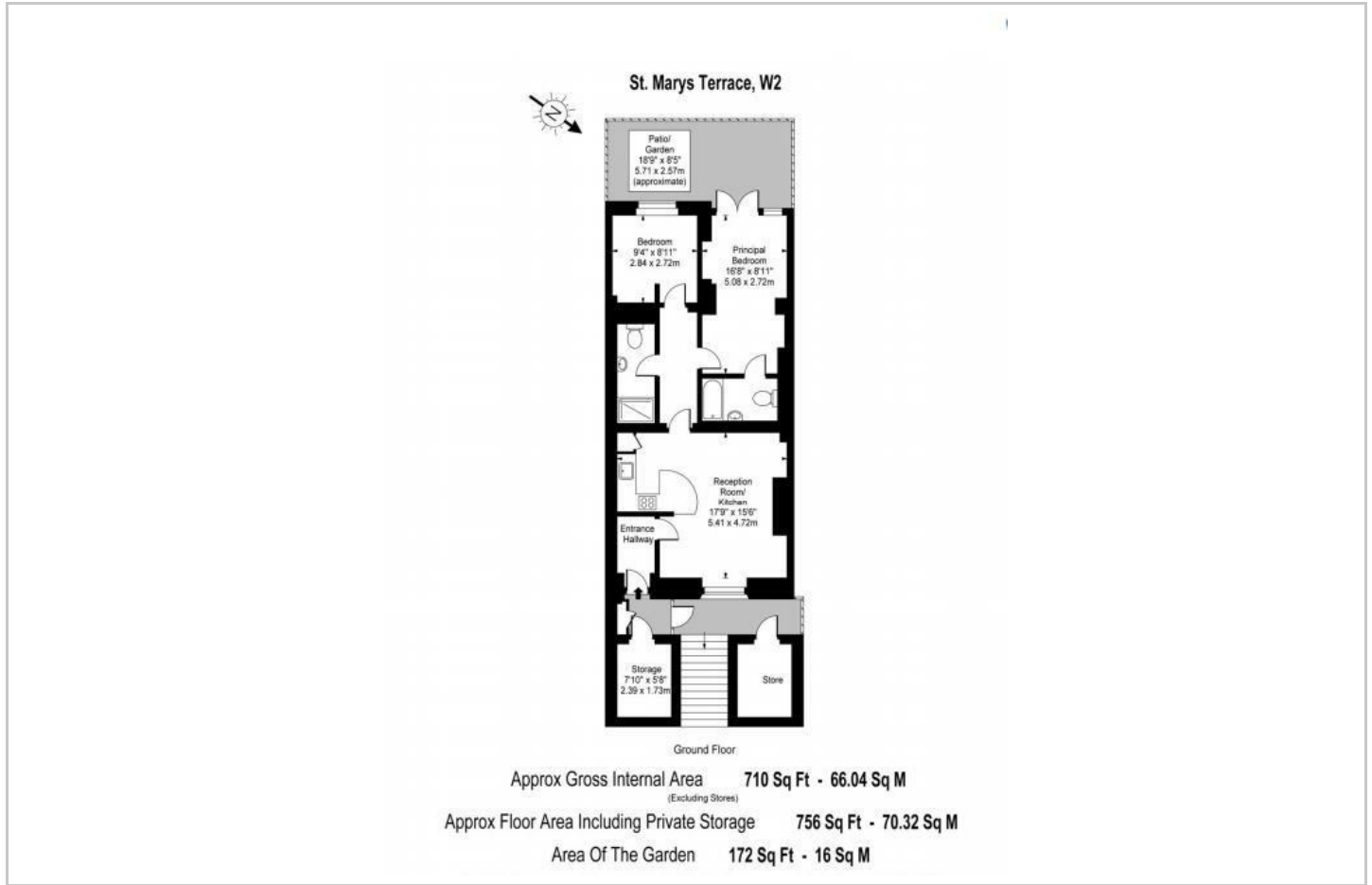

Area Map

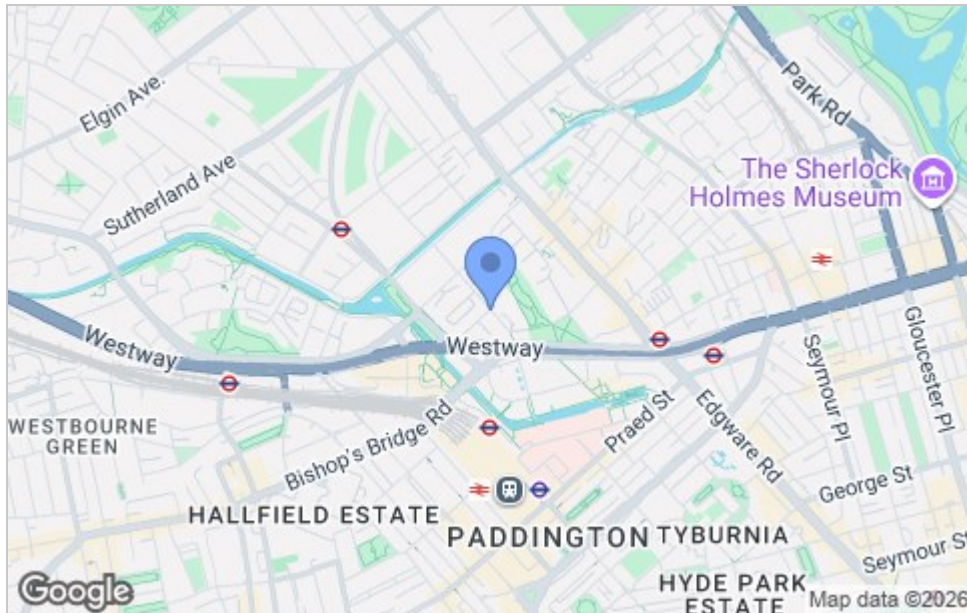

Viewing

Please contact us on 020 7046 6275 if you wish to arrange a viewing appointment for this property or require further information.

Energy Efficiency Graph

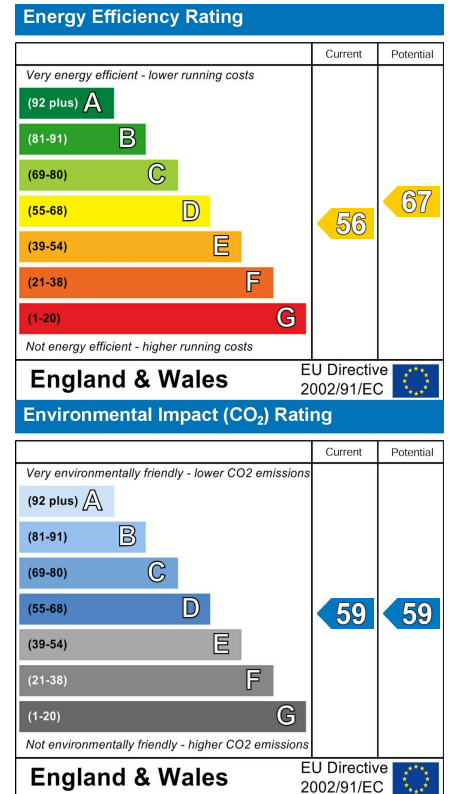

These particulars, whilst believed to be accurate are set out as a general outline only for guidance and do not constitute any part of an offer or contract. Intending purchasers should not rely on them as statements of representation of fact, but must satisfy themselves by inspection or otherwise as to their accuracy. No person in this firm's employment has the authority to make or give any representation or warranty in respect of the property.

020 7046 6275 • sales@chamillresidential.co.uk • 51 Maida Vale, Little Venice, London W9 1SD
 charmillresidential.co.uk