

# Frank Harris & Co.



## John Trundle Court, Barbican, EC2Y

£450,000

A large style studio (Type F2A) which has many original features including the Brooke Marine kitchen and bathroom. Situated on the 5th floor with views east overlooking the landscaped gardens and views of the Gherkin and beyond. The main studio room has a wall of fitted wardrobes which houses the water tank and fuse box with fitted shelving and hanging space.

Within walking distance of Barbican, Farringdon and Moorgate stations, with access to the Northern, Elizabeth, Circle, Metropolitan and Hammersmith and City Line.

- Large Style Studio • East Aspect • Type F2A, 5th Floor •
- Original Features • No Onward Chain • Overlooking Podium •

# Frank Harris & Co.

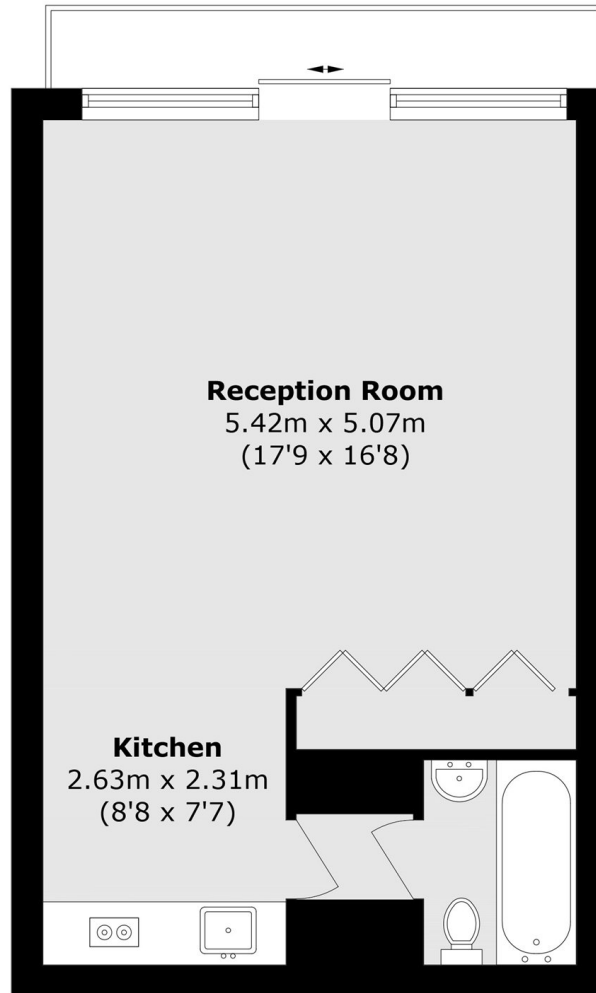

## Fifth Floor

Total area (approx.): 40.8 sq. m (439.2 sq. ft)

Frank Harris & Co. Barbican and City  
87 Long Lane, London,  
EC1A 9ET  
020 7600 7000  
citysales@frankharris.co.uk

Energy Rating: N/A. We aim to make our particulars both accurate and reliable. However they are not guaranteed; nor do they form part of an offer or contract. If you require clarification on any points then please contact us, especially if you're traveling some distance to view. Please note that appliances and heating systems have not been tested and therefore no warranties can be given as to their good working order.

