

Head Office:
Dixon Kelley Estate Agents
1 Penn Court
Station Road, West Moors
Dorset. BH22 0JJ

DORSET PARK HOMES

DRAFT

www.dorsetparkhomes.com

Telephone: 01202 877511

45 Pinehurst Park, West Moors, Ferndown, Dorset. BH22 0BW



Popular 'Pet Friendly' Park—No Chain!

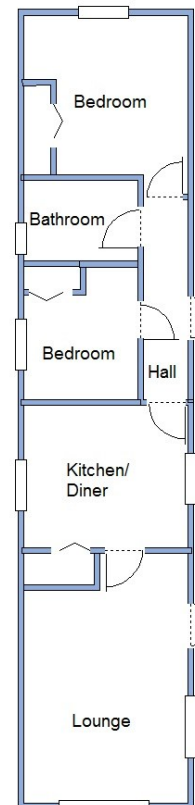

This drawing has been prepared for diagrammatic purpose only. Not to scale.

2-Bedroom Park Home - approx 45' x 10'

Accommodation & approximate room dimensions:

- Homeseeker circa 2003
- Entrance Hall
- Kitchen/Diner: approx 9'6" x 8'4". Range of floor and wall cupboards. Built-in oven, Gas hob with cooker hood over (untested). Plumbing for washing machine. Space for tall fridge/freezer. Space for dining table. Cupboard housing combination gas boiler.
- Lounge: approx 14'6" x 9'6" max. Bay window. Feature fireplace. Door to garden.
- Bedroom 1: approx 9'6" x 9'3". Range of built in wardrobes & dresser unit.
- Bedroom 2: approx 8' x 7'. Built-in wardrobe.
- Bathroom: Modern suite comprising wet room style shower. Wash basin & WC. Chrome heated towel rail.
- Gas Central Heating (system untested)
- PVCu Double-Glazing
- Exterior Insulation System
- Private Patio Garden with Metal Shed
- Parking on Plot
- Age Restriction 45+ Pets Considered

Bright, Sunny Position



Pitch Fee: approx £251.85 per month
Subject to Annual review
Council Tax Band: 'A'

Tenure: 1983 Mobile Homes Act Agreement

Price: £100,000

VIEWING STRICTLY BY APPOINTMENT WITH THE VENDOR'S AGENT Dorset Park Homes 01202 877511

IMPORTANT NOTE: These particulars are believed to be correct but their accuracy is not guaranteed. They do not form part of any contract. Nothing in these particulars shall be deemed to be a statement that the property is in good structural condition or otherwise, nor that any of the services, appliances, equipment or facilities are in good working order or have been tested. Purchasers should satisfy themselves on such matters prior to purchase Ref.W05238

The recommended specialist in Park Home sales
Partner: Simon Dixon

