



Ormsby Court Richmond Hill Road, Birmingham B15 3RJ

welcome to

Ormsby Court Richmond Hill Road, Birmingham

PRIME B15 LOCATIONWALKING DISTANCE TO HARBORNE VILLAGE***SHORT COMMUTE TO QE HOSPITAL, UNI AND BIRMINGHAM CITY CENTRE***TWO BEDROOM TOP FLOOR APARTMENT***COMMUNAL PARKING AND GARAGE***TURNKEY READY HOME***

Agent Note

This property is council tax band C.

Entrance Hallway

Storage cupboard, doors to living/dining room & kitchen.

Lounge

21' 5" x 11' 6" (6.53m x 3.51m)
2 double glazed windows, hot air vents.

Kitchen

12' 8" longest point. x 11' 5" (3.86m longest point. x 3.48m)
Double glazed window, hot air system, full size dishwasher, 5 ring gas hob with extractor, integrated oven & microwave, range of wall & base units.

Bedroom 1

13' 4" x 11' 6" (4.06m x 3.51m)
Double glazed windows, warm air vent, built in wardrobes.

Bedroom 2

9' 6" to front of wardrobe. x 9' (2.90m to front of wardrobe. x 2.74m)
Double glazed window, warm air vents, built in wardrobe/storage.

Bathroom

Double glazed frosted window, wash hand basin with storage cupboards underneath, bath with rainfall shower.

Separate W/C

Low level flush w/c.

Parking

Residents parking, garage en-bloc (18).





check out more properties at shipways.co.uk



welcome to

Ormsby Court Richmond Hill Road, Birmingham

- Two Bedroom Top Floor Apartment
- B15 Edgbaston Location
- Near to Harborne, QE Hospital, Bham Uni and City Centre
- Communal Parking and Garage
- Secure Communal Entrance

Tenure: Leasehold EPC Rating: D

Council Tax Band: C Service Charge: 3500.00

Ground Rent: Ask Agent

This is a Leasehold property with details as follows; Term of Lease 130 years from 01 Sep 2025. Should you require further information please contact the branch. Please Note additional fees could be incurred for items such as Leasehold packs.

PRICE: £250,000

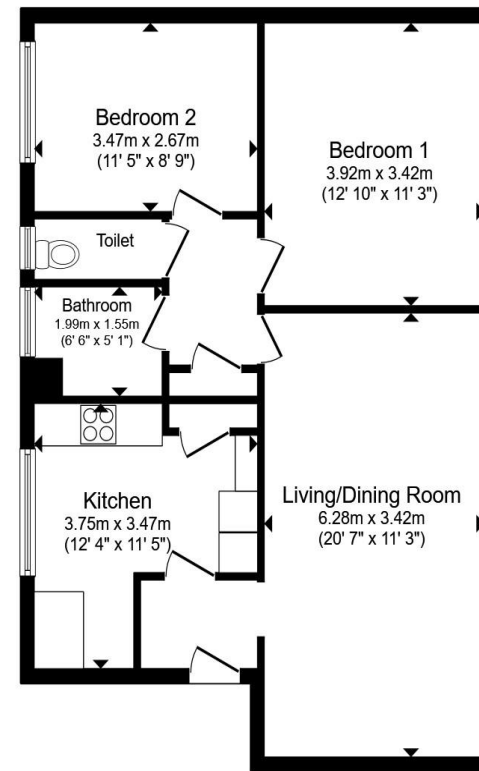

Total floor area 68.1 m² (733 sq.ft.) approx

This floor plan is for illustrative purposes only. It is not drawn to scale. Any measurements, floor areas (including any total floor area), openings and orientation are approximate. No details are guaranteed, they cannot be relied upon for any purpose and they do not form part of any agreement. No liability is taken for any error, omission or misstatement. A party must rely upon its own inspection(s). Powered by www.propertybox.io



check out more properties at shipways.co.uk



Property Ref:
HBN112229 - 0003

1. MONEY LAUNDERING REGULATIONS Intending purchasers will be asked to produce identification documentation at a later stage and we would ask for your co-operation in order that there is no delay in agreeing the sale. 2. These particulars do not constitute part or all of an offer or contract. 3. The measurements indicated are supplied for guidance only and as such must be considered incorrect. Potential buyers are advised to recheck measurements before committing to any expense. 4. We have not tested any apparatus, equipment, fixtures or services and it is in the buyers interest to check the working condition of any appliances. 5. Where an EPC, or a Home Report (Scotland only) is held for this property, it is available for inspection at the branch by appointment. If you require a printed version of a Home Report, you will need to pay a reasonable production charge reflecting printing and other costs. 6. We are not able to offer an opinion either written or verbal on the content of these reports and this must be obtained from your legal representative. 7. Whilst we take care in preparing these reports, a buyer should ensure that his/her legal representative confirms as soon as possible all matters relating to title including the extent and boundaries of the property and other important matters before exchange of contracts.

Shipways is a trading name of Sequence (UK) Limited which is registered in England and Wales under company number 4268443, Registered Office is Cumbria House, 16-20 Hockliffe Street, Leighton Buzzard, Bedfordshire, LU7 1GN. VAT Registration Number is 500 2481 05.

Not for marketing purposes INTERNAL USE ONLY



0121 427 3264



harborne@shipways.co.uk



172 High Street, Harborne, BIRMINGHAM,
West Midlands, B17 9PP



shipways.co.uk