



HOMES BY VICTORIA  
ESTATE AGENCY

## Bromsgrove Road, Redditch, B97 4RL

Offers Over £295,000

3 2 1



An elegant and substantial three double bedroom, three-storey period residence, perfectly positioned on the ever-convenient Bromsgrove Road in Redditch, just a short stroll from the Kingfisher Shopping Centre and Redditch train station.

[homesbyvictoria.co.uk](https://homesbyvictoria.co.uk)

[victoria@homesbyvictoria](mailto:victoria@homesbyvictoria) | 07833 136521

FOR M HOMES MIDLANDS LIMITED trading as Homes By Victoria Company Number: 13688840 VAT no: 470190115



HOMES BY VICTORIA  
ESTATE AGENCY



## HOMES BY VICTORIA

ESTATE AGENCY

### Key Features

- LOCATED ON THE BROMSGROVE ROAD
- SPACIOUS VERSATILE ACCOMODATION
- LIGHT FILLED KITCHEN DINER
- COSEY LOUNGE
- THREE DOUBLE BEDROOMS
- MASTER BEDROOM WITH EN-SUITE BATHROOM
- FAMILY BATHROOM
- THREE STOREY LIVING
- PRIVATE REAR GARDEN
- OFF ROAD PARKING

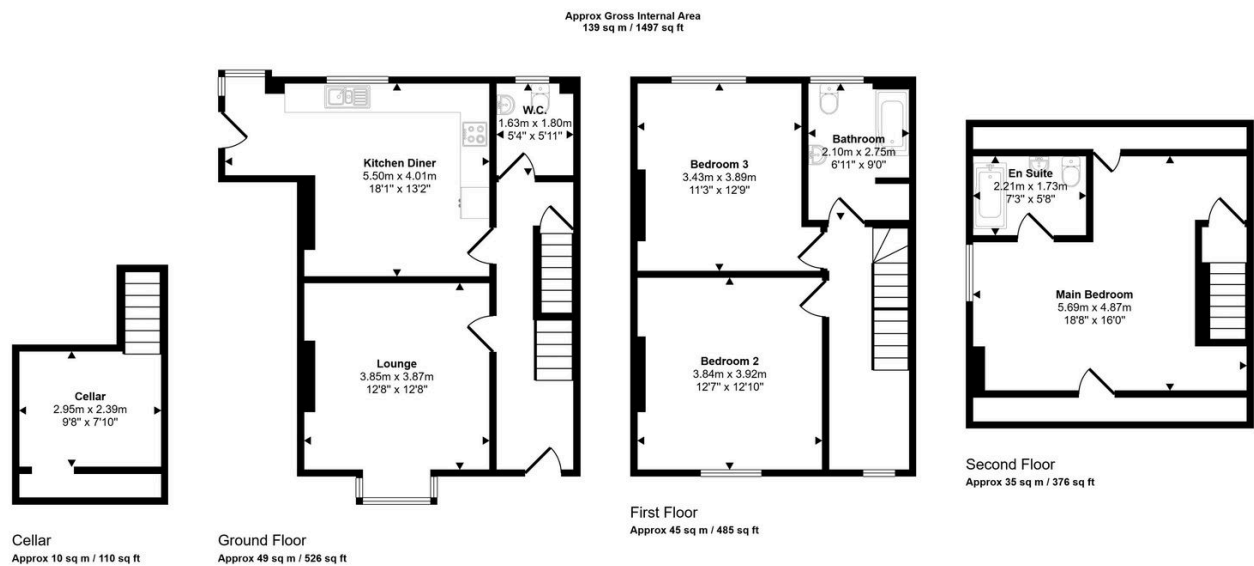

This floorplan is only for illustrative purposes and is not to scale. Measurements of rooms, doors, windows, and any items are approximate and no responsibility is taken for any error, omission or mis-statement. Icons of items such as bathroom suites are representations only and may not look like the real items. Made with Made Snappy 360.