



 **NEWTON**  
**FALLOWELL**

7 Webster Walk, Wyberton – PE21 7NP  
30% SHARED OWNERSHIP £43,500

## 7 Webster Walk

Wyberton, Boston

**30% SHARED OWNERSHIP** – A modern end-terrace home, built in 2018 and enjoying an attractive position within a popular residential development. Perfect for first-time buyers, the well-presented accommodation comprises a fitted kitchen, cloakroom and spacious lounge/diner to the ground floor. Two bedrooms and a contemporary bathroom to the first floor. Outside, there is a small front garden, an enclosed rear garden and off-road parking. Further benefits include gas central heating, double glazing, convenient access to local amenities and excellent road links to Boston and Spalding.

Council Tax band: A

Tenure: Leasehold

EPC Energy Efficiency Rating: B

EPC Environmental Impact Rating: B





### ACCOMMODATION

Steps up to a part glazed front entrance door with canopy over through to the:

### KITCHEN

15' 0" x 8' 7" (4.57m x 2.62m)

(max) Having window to front elevation and radiator. Fitted with a range of base & wall units with work surfaces & upstands comprising: stainless steel sink with drainer & mixer tap inset to work surface, cupboards & drawers under. Work surface return with inset gas hob, integrated electric oven & cupboards under, cupboards & stainless steel extractor over, space for upright fridge/freezer to side. Further work surface with space & plumbing for automatic washing machine & tumble dryer under and further work surface forming breakfast bar.

### CLOAKROOM

Having radiator, close coupled WC and wall mounted hand basin with tiled splashback.

### LOUNGE

15' 0" x 13' 0" (4.57m x 3.96m)

Having french doors with side screens to rear elevation & garden, radiator and staircase rising to first floor.





 **NEWTON FALLOWELL**



### FIRST FLOOR LANDING

Having access to roof space and airing cupboard housing gas fired boiler providing for both domestic hot water & heating.

### BEDROOM ONE

12' 5" x 10' 5" (3.78m x 3.18m)

Having two windows to rear elevation, radiator and built-in wardrobe.

### BEDROOM TWO

11' 2" x 8' 3" (3.40m x 2.51m)

Having window to front elevation and radiator.

### BATHROOM

Having window to front elevation, radiator, tiled splashbacks, shaver point, panelled bath with electric shower fitting & anti-splash screen over, close coupled WC and pedestal hand basin.





### **EXTERIOR**

To the front of the property there is a small bark chip garden enclosed by wrought iron railings with steps up the the front entrance door.

### **REAR GARDEN**

Being enclosed with a side entrance gate. Laid to lawn with a paved patio. To the rear of the property there is also allocated off-road parking.

### **SERVICES**

The property has mains gas, electricity, water and drainage connected. Heating is via a gas fired boiler serving radiators and the property is double glazed. The current council tax is band A. We are advised that there is a management charge of £15.98 per month for upkeep on the estate.

### **LIFETIME LEGAL**

We are required by law to conduct anti-money laundering checks on all those selling or buying a property. Whilst we retain responsibility for ensuring checks and any ongoing monitoring are carried out correctly, the initial checks are carried out on our behalf by Lifetime Legal who will contact you once you have agreed to instruct us in your sale or had an offer accepted on a property you wish to buy. The cost of these checks is £72 (incl. VAT), which covers the cost of obtaining relevant data and any manual checks and monitoring which might be required. This fee will need to be paid by you in advance of us publishing your property (in the case of a vendor) or issuing a memorandum of sale (in the case of a buyer), directly to Lifetime Legal, and is non-refundable. We will receive some of the fee taken by Lifetime Legal to compensate for its role in the provision of these checks.



## Ground Floor

Approx. 30.6 sq. metres (329.6 sq. feet)

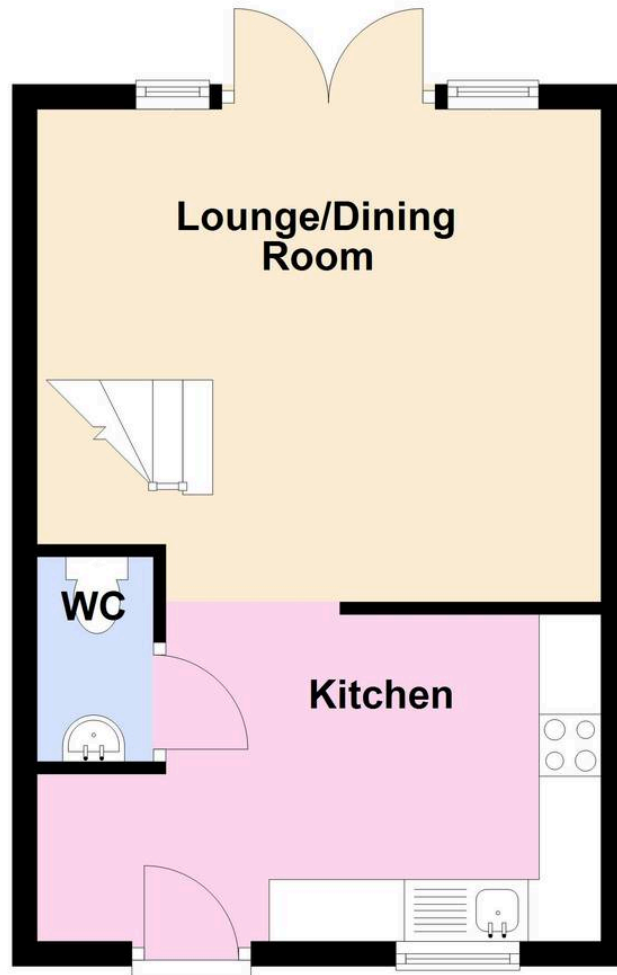

## First Floor

Approx. 30.6 sq. metres (329.6 sq. feet)

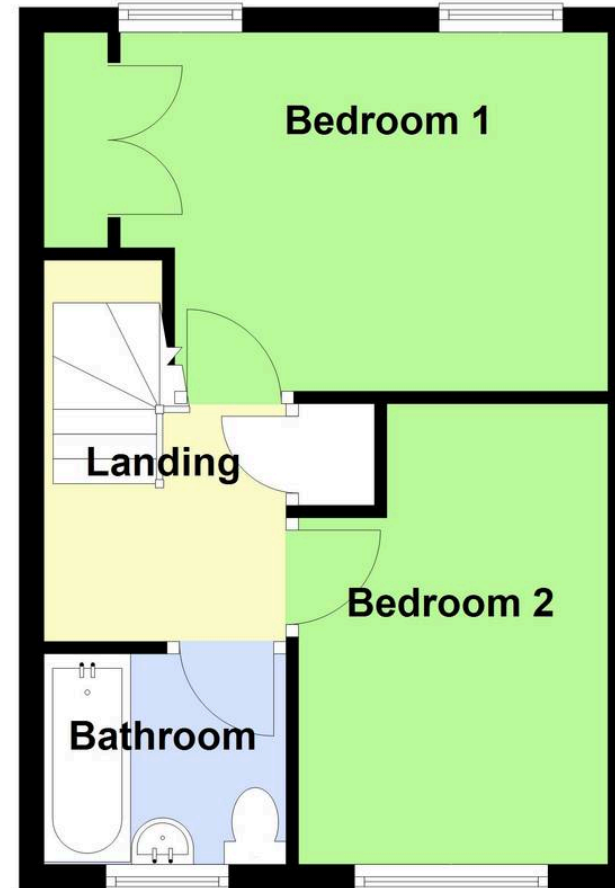

Total area: approx. 61.2 sq. metres (659.1 sq. feet)

## Newton Fallowell Estate Agents

Newton Fallowell Ltd, 26 Wide Bargate - PE21 6RX

01205353100 • [boston@newtonfallowell.co.uk](mailto:boston@newtonfallowell.co.uk) • [www.newtonfallowell.co.uk/boston](http://www.newtonfallowell.co.uk/boston)

These particulars are issued in good faith but do not constitute representations of fact or form part of any offer or contract. The matters referred to in these particulars should be independently verified by prospective buyers or tenants. Neither Newton Fallowell nor any of its employees or agents has any authority to make or give any representation or warranty in relation to this property.