

Sinclair  
Hammelton  
**For Sale**  
020 8462 0360  
[www.sinclairhammelton.co.uk](http://www.sinclairhammelton.co.uk)

ASKING PRICE

**£550,000**

**George Lane**

Hayes, BR2 7LG



EPC RATING: C COUNCIL TAX BAND: D

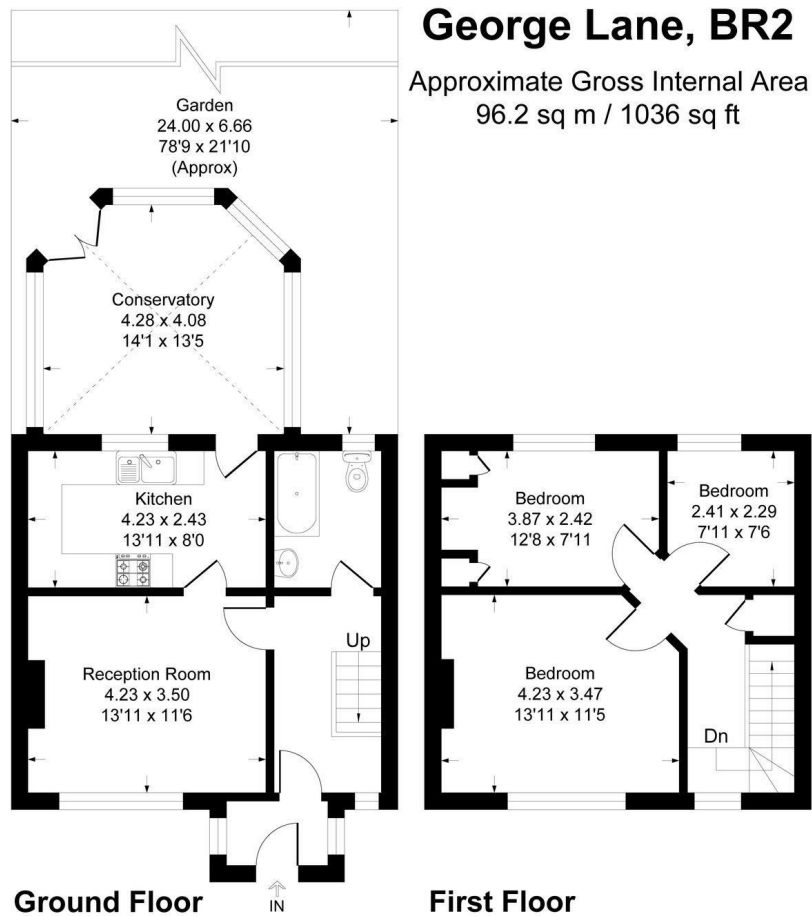

This plan is for layout guidance only. Not drawn to scale unless stated. Windows and door openings are approximate. Whilst every care is taken in the preparation of this plan, please check all dimensions, shapes and compass bearings before making any decisions reliant upon them.  
Produced By Planpix



Energy Efficiency Rating		
	Current	Potential
Very energy efficient - lower running costs		
(92 plus) <b>A</b>		
(81-91) <b>B</b>		
(69-80) <b>C</b>		
(55-68) <b>D</b>		
(39-54) <b>E</b>		
(21-38) <b>F</b>		
(1-20) <b>G</b>		
Not energy efficient - higher running costs		
<b>England &amp; Wales</b>	71	76
EU Directive 2002/91/EC		



Agents Note: Whilst every care has been taken to prepare these particulars, they are for guidance purposes only. All measurements are approximate and are for general guidance purposes only and whilst every care has been taken to ensure their accuracy, they should not be relied upon and potential buyers/tenants are advised to recheck the measurements

**Sinclair Hammelton**

#### OFFICE ADDRESS

3a Station Approach  
Hayes  
Kent  
BR2 7EQ

#### OFFICE DETAILS

020 8462 0360  
infohy@sinclairhammelton.co.uk