

# Henry Strong Road

Harrow • Middlesex • HA1 4BG

PCM: £1,525 PCM



coopers  
est 1986

Coopers are delighted to present this ONE bedroom FIRST FLOOR LUXURY apartment in the heart of Harrow.

This BRAND NEW luxury apartment is PERFECTLY located within walking distance of local tube stations and shops. CONTEMPORARY design, finished to the HIGHEST of standards. The apartment comprises of spacious open living areas, MODERN fully fitted kitchens and double bedroom.

Other benefits include: balcony, en-suite, phone entry system and double glazing.

Offer unfurnished and available in July

Local authority: London Borough of Harrow  
Council tax: Band C

BRAND NEW

One bedroom

Lift access

First floor

Close to walking amenities

Luxury apartment

Modern kitchen

Walking distance to Harrow & Wealdstone Station

Unfurnished

Available in July

**Available Date**

4th July 2026

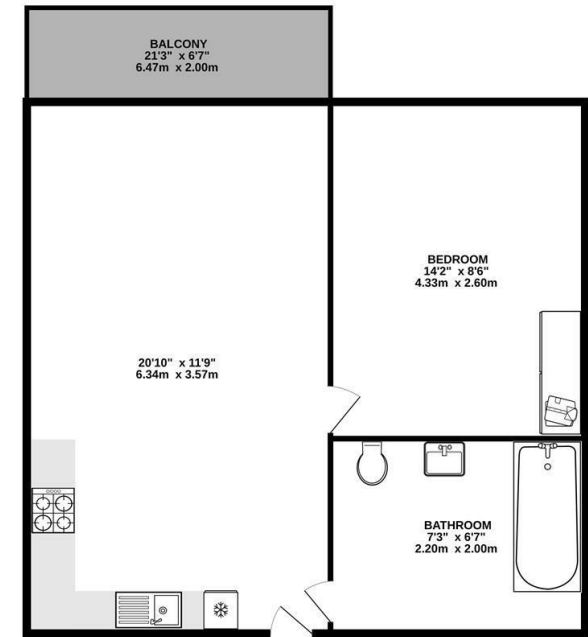

TOTAL FLOOR AREA - 409 sq.ft. (38.0 sq.m.) approx.  
While every attempt has been made to ensure the accuracy of the floorplan contained here, measurements of doors, windows, rooms and any other items are approximate and no responsibility is taken for any error, omission or misstatement. This plan is for illustrative purposes only and should be used as such by any prospective purchaser. The services, systems and appliances shown have not been tested and no guarantee, as to their operability or efficiency, can be given.  
Made with Metacox C023

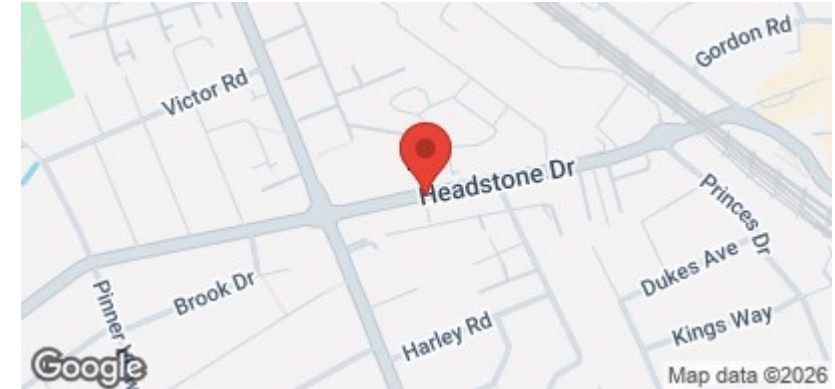

**0208 017 6000**

**18 Bridge Street, Pinner,  
Middlesex, HA5 3JF**  
pinner@coopersresidential.co.uk

**CoopersResidential.co.uk**

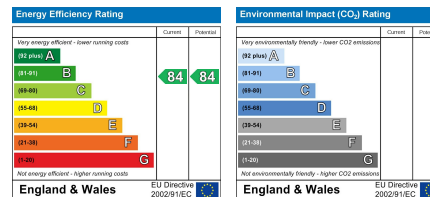

Important Notice: These particulars, whilst believed to be accurate are set out as a general outline only for guidance and do not constitute any part of an offer or contract. Intending purchasers should not rely on them as statements or representation of fact, but must satisfy themselves by inspection or otherwise has the authority to make or give any representation or warranty in respect of the property.

**coopers**  
est 1986