



Pipers Court

Beulah Hill | Upper Norwood | SE19 3ET

£1,695 Per Month



Pipers Court

Beulah Hill |

Upper Norwood | SE19 3ET

£1,695 Per Month

Welcome to your new home in the heart of Beulah Hill, Upper Norwood, SE19.

This charming 2-bedroom, 1-bathroom apartment is now available for rent at £1695 per month. Situated on the first floor, this apartment boasts an excellent location making it an ideal choice for those seeking a convenient and comfortable living space.

Step inside and discover the modern allure of this apartment, featuring sleek laminate flooring that adds a touch of elegance to the space. The open layout creates a seamless flow between the living, dining, and kitchen areas, providing a welcoming environment for both relaxation and entertainment.

Convenience is key, and this property offers just that. Within close proximity, you'll find the nearest bus stop for easy commuting, as well as the Crystal Palace and Gipsy Hill railway stations, each

- Excellent Location
- First Floor
- Available from 10th August
- Bright and Airy
- Laminate Flooring
- Neutrally decorated



Pipers Court, Beulah Hill, SE19 3ET

Approx. Gross Internal Area 607 Sq Ft - 56.39 Sq M

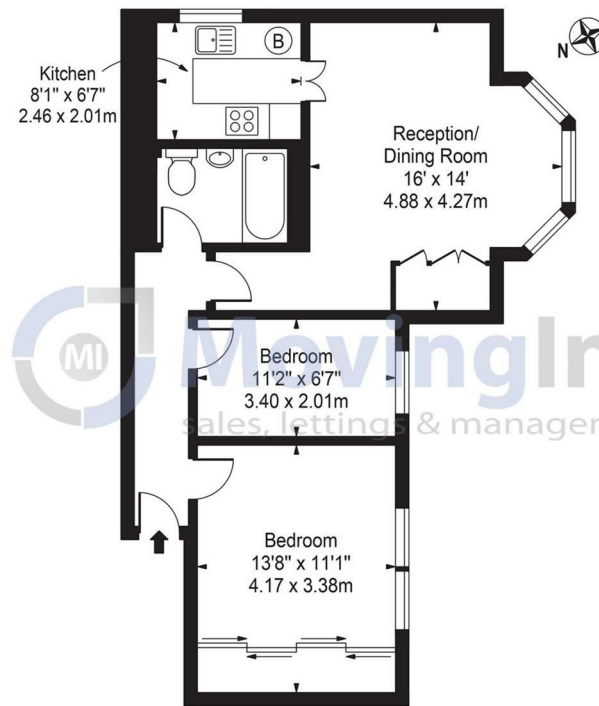

For Illustration Purposes Only - Not To Scale

This floor plan should be used as general outline for guidance only.
All measurements are approximate and for illustration purposes only as defined by the RICS Code of Measuring Practice ©2016.

Energy Efficiency Rating		Current	Potential
Very energy efficient - lower running costs			
(92 plus) A			
(81-91) B			
(69-80) C			
(55-68) D		68	
(39-54) E			
(21-38) F			
(1-20) G			81
Not energy efficient - higher running costs			
England & Wales		EU Directive 2002/91/EC	

Council Tax Band C
EPC Rating D

467 Norwood Road
West Norwood
London
SE27 9DJ
02087610830

dean@movinginn.co.uk
www.movinginn.co.uk