



## Fairthorn Road, SE7

### £300,000

Spacious one double bedroom purpose-built top floor flat, offering well-proportioned accommodation throughout. The property is presented in excellent condition and benefits from a modern kitchen with integrated appliances, which is open plan to a large reception room. There is a generous double bedroom and a contemporary bathroom. The flat is offered with no onward chain. Being on the top floor, it enjoys a bright and quiet position within the building, making it an ideal first-time purchase or investment opportunity.

0.3 miles from Charlton and Westcombe Park stations, with access to North Greenwich, Elizabeth Line buses, shops, superstores, IKEA, and the O2's dining.

### Features

- Large One Bedroom
- Lift Access
- Balcony
- Excellent Position For Transport
- Close To Shops & Amenities
- No Chain



**Fairthorn Road, SE7**



# Fairthorn Road, London, SE7

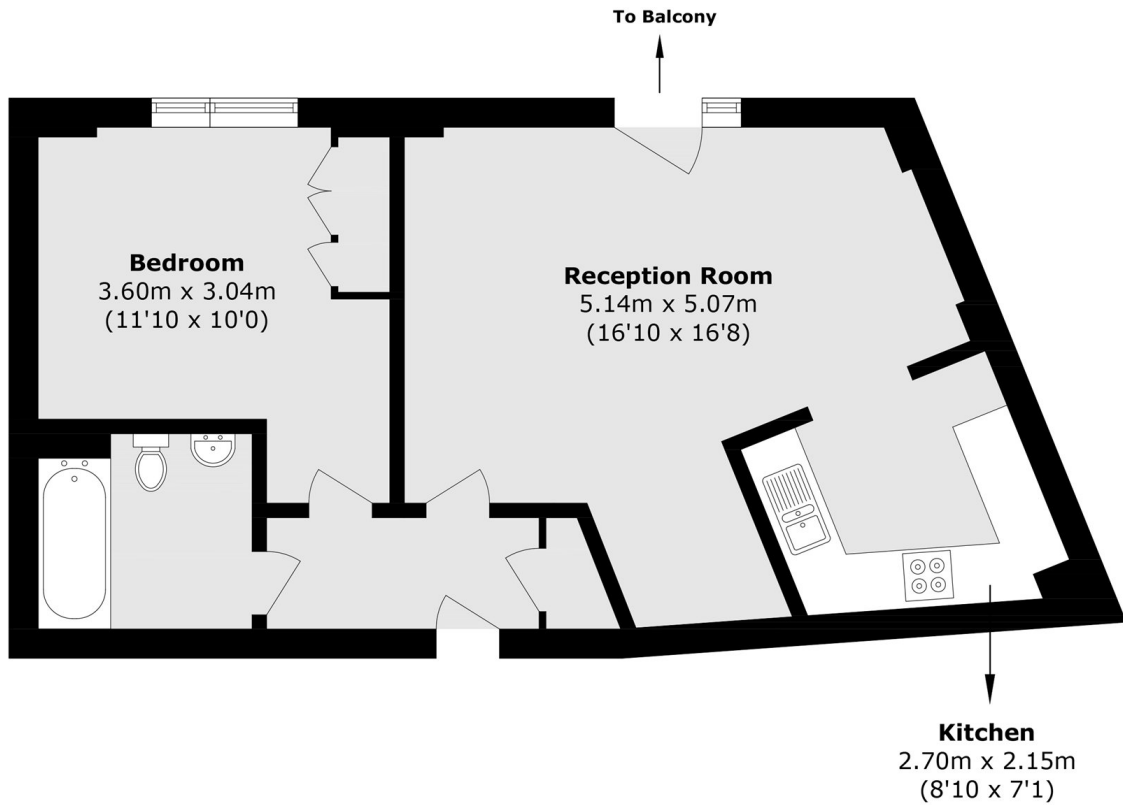

Total area (approx.): 49.5 sq. m (532.8 sq. ft)