



**Price**  
**£380,000**

**Freehold**

3x  2x  1x 

**Plot 138, Darnel Avenue,  
Grasmere Gardens  
(Phase 1), Chestfield,  
Whitstable, Kent, CT5**

**OVER 60?**

Secure this property  
for up to **59% less!**

*Wards*  
Helping you move forwards



## Main features

- Legal fees paid\*
- Ready to move into
- \*Subject to terms and conditions, please speak to a sales consultant for further details

## Accommodation

### GROUND FLOOR

- Entrance Hallway
- Cloakroom
- Kitchen: 13'1 x 8'8 (3.99m x 2.64m)
- Lounge/Dining: 18'7 x 13'6 (5.67m x 4.12m)

### FIRST FLOOR

- Landing
- Bedroom 1 : 12'1 x 11'0 (3.69m x 3.36m)
- Ensuite Shower Room
- Bedroom 2 : 10'1 x 9'5 (3.08m x 2.87m)
- Bedroom 3 : 10'5 x 8'3 (3.18m x 2.52m)
- Bathroom

### OUTSIDE

- Car Port
- Driveway
- Front Garden
- Rear Garden

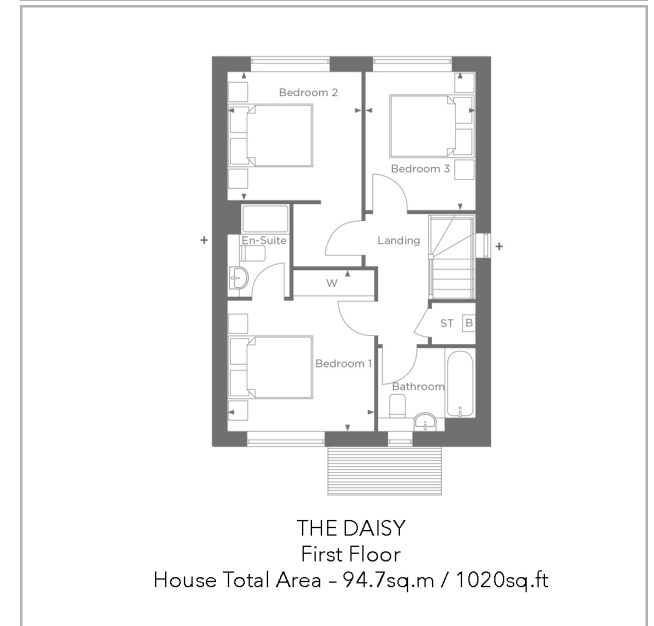
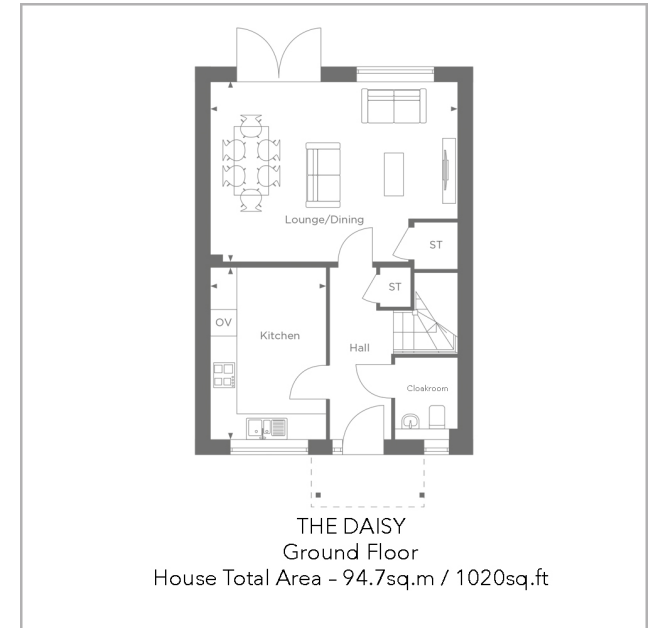

**Call Whitstable - 01227 772272 ■ [wardsof Kent.co.uk](http://wardsof Kent.co.uk)**

- If buying to let, the energy rating will need to be improved to at least 'E' rating before you can let the property
- Legal advice should be taken to verify fixtures/fittings, planning, alterations and/or lease details
- Appliances & services are untested, dimensions are approximate and floor plans are not to scale
- Through a Homewise Home For Life Plan people aged 60+ can secure this property for up to 50% less, by purchasing a Lifetime Lease.



12033488/20250922/AR/NF